

lucent[®]

Professional Architectural Lighting

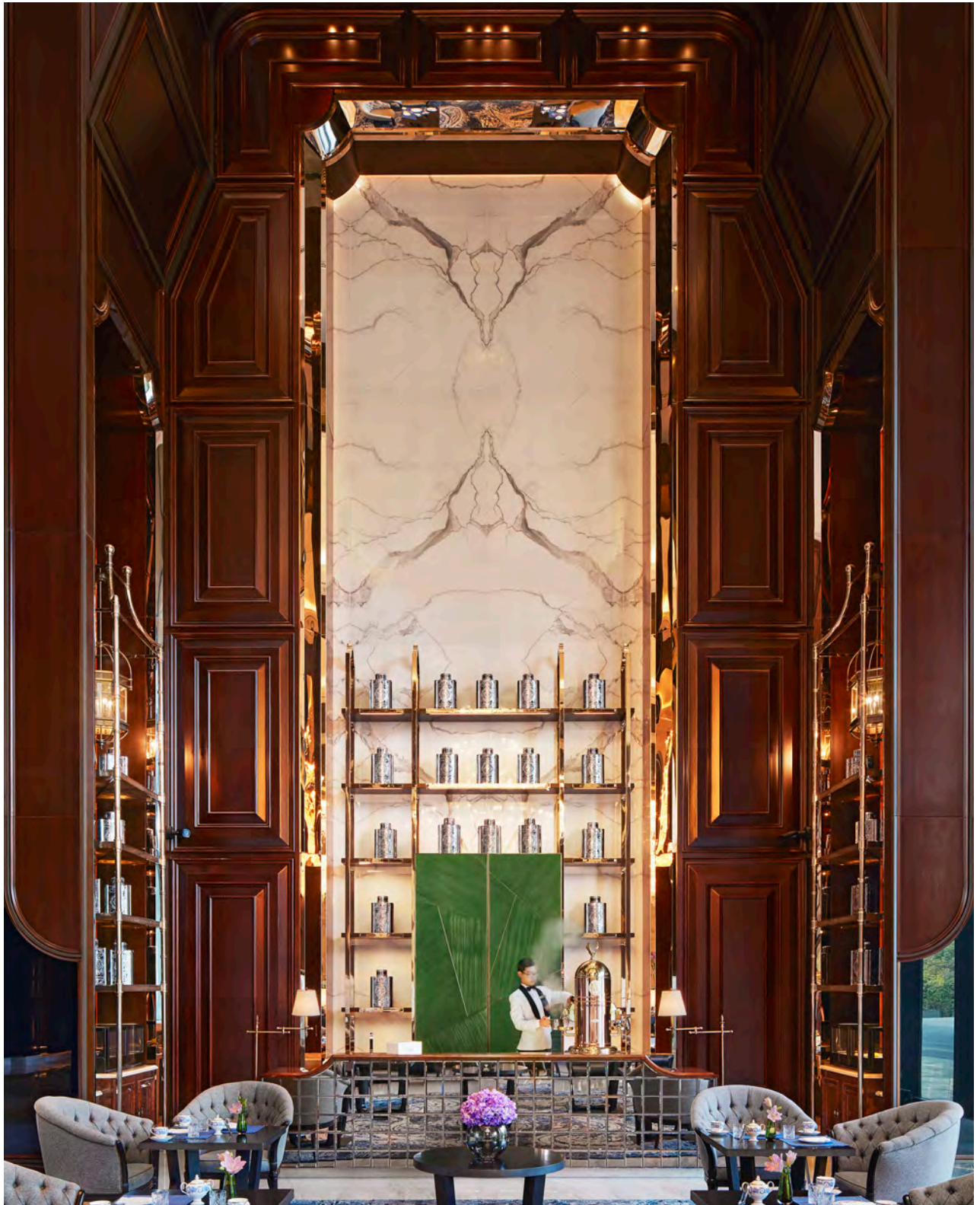

lucent /'lu:s(ə)nt/
adjective literary

glowing with or giving off light.
'the moon was lucent in the background'

Front Cover Image:
In memory of Abhay Chordia Panchshil Properties
Ritz Carlton Hotel, Pune, India
dpa lighting consultants

Your Global Lighting Partner

Hospitality - Residential
Boutique Retail - Commercial

For more than 3 decades and working closely with the lighting design community Lucent has established itself as one of the leading architectural lighting manufacturers in the world.

With offices in London and New York and with a specialist lighting distributor and agency network worldwide Lucent is ideally placed to be your global partner.

Lucent specialised in the design and manufacture of architectural downlights but recently have entered into other areas with outdoor, spotlights, linear, profiles, surface, pendant and in wall fixtures.

With this new publication we are presenting our latest product portfolio and we also take the opportunity to acknowledge the support of our clients by showcasing some of their prestigious projects we have collaborated on.



STELLA McCARTNEY

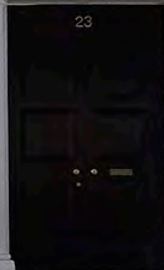

OLD BOND STREET W1
W1S 1PP
24-1
24-14
CITY OF WESTMINSTER



24





Stella McCartney Flagship Store, London
PJC Lighting Studio, London
Photography: Hufton & Crow

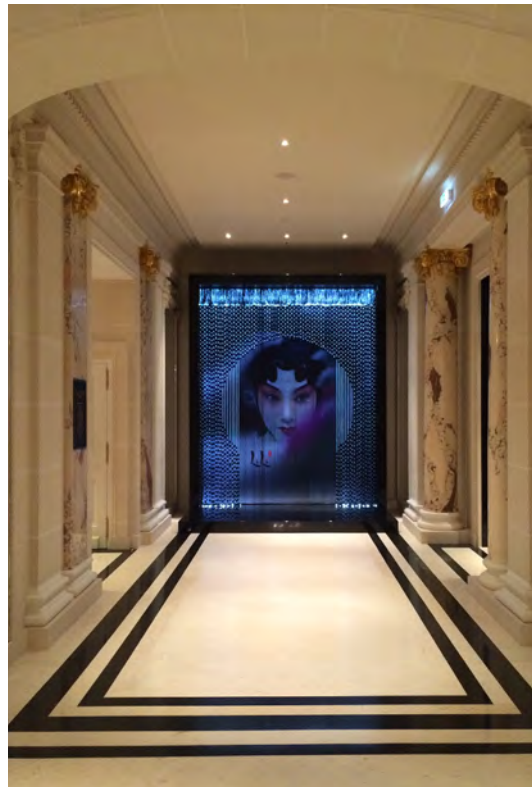

Peninsula Hotel, Paris
FMS Lighting Design, New York
Photography: Courtesy of The Peninsula Paris Hotel

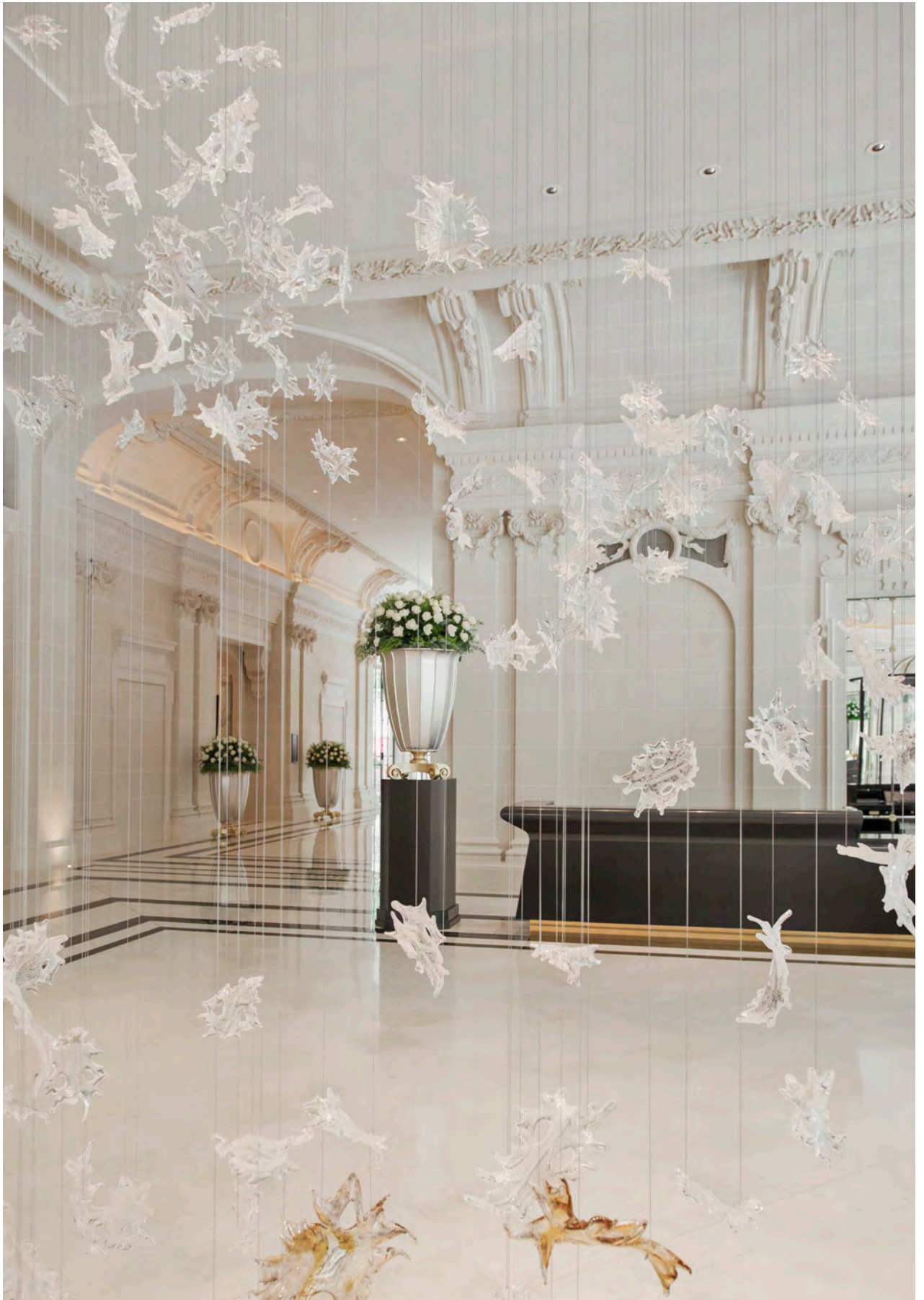



Mall of Qatar, Doha
T Kondos Associates, New York







Eurostar Business Lounge, Paris
Cinimod Studio, London



Big Sean's Kitchen, Adelaide
Firefly PointOfView, Sydney





L'Occitane Flagship Store, London
Nulty+ Lighting Design, London
Photography: Michael Franke



Mandarin Oriental, London
dpa lighting consultants

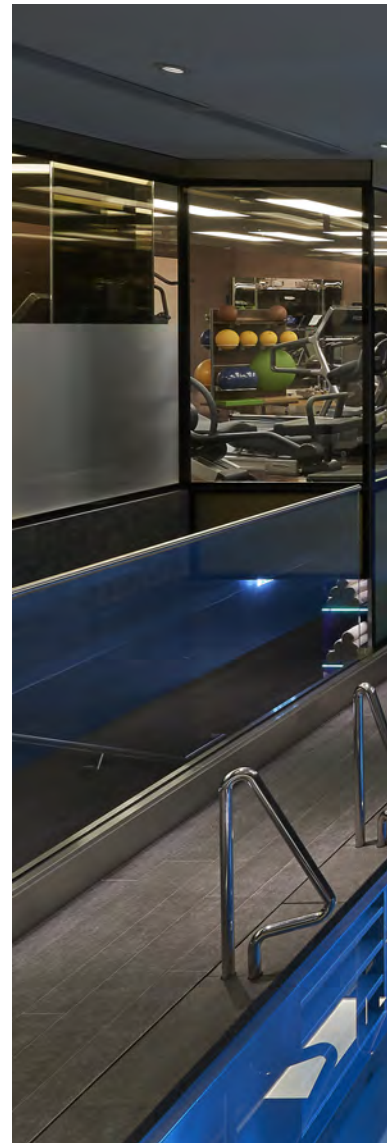



lucent®

PRODUCT FINDER

OUTDOOR

- 26 **InGround** – Interior and exterior grade IP rated round and square inground marker light fixtures in 2 sizes, 6 bezel finishes and various beam angles
- 32 **InWall** – Interior and exterior grade IP rated round and square recessed marker lights in 6 bezel finishes, ideally suited for low level illumination
- 38 **Vista** – Exterior grade IP rated spot and floodlight, available as spike, wall or tree mounted options for illumination of garden features and pathways
- 42 **Vista Mini** – Exterior grade miniature IP rated spot and floodlight, available as spike, wall or tree mounted options for illumination of smaller garden feature, planters and pathways

MINIATURE

- 46 **Micro40** – Wide range of miniature interior round and square downlights in trim or trimless for small niche areas, millwork and undershelf applications

LINEAR

- 60 **Line** – Single and multi cell miniature Low glare downlights with Cube or Flare baffles in trim or trimless options
- 68 **FineLine** – Multi functional slimline 48v linear profile system in pendant, surface, recessed trim and recessed trimless options for use with a selection of Lucent products including TubeLED spotlights, TubeLED pendants, Line and Linear LED
- 76 **ProStrip Black** – Flexible LED strip in our signature black finish available with a selection of diffused aluminium profiles for cove and undershelf display installations

SPOTLIGHTS AND TRACK

- 82 **TubeLED Spotlights** – Track or surface mounted tubular spotlights in 4 sizes and multiple outputs, available for mains voltage or low voltage track
- 108 **Track** – Lighting track for all Lucent spotlights in either 230V mains voltage or 48v low voltage

PENDANT & SURFACE

- 112 **TubeLED Pendant and Surface** – Surface or pendant mounted cylindrical fixtures in 5 diameters for integral or remote drivers

LED MODULES

- 124 LucentLED** – Wide selection of LED modules for all Lucent downlight fixtures utilising the latest technology including Dim to Warm and Tuneable White

DOWNLIGHTS

- 130 Edge** – Round and square downlights in 2 sizes featuring our Edge baffle to maintain a glare free professional look in trim or trimless options
- 146 Duo** – Low glare deep regressed round monochrome downlights in white finish with fine black textured interior in trim or trimless options
- 150 Flare** – Deep regressed downlights in 2 sizes featuring a flare aperture in trim or trimless options
- 154 Soft** – Round and Square soft appearance downlights in 3 sizes with trim or trimless options
- 162 SoftColour** – Round soft appearance downlights in 3 sizes and a choice of 6 anodised finishes with trim or trimless options
- 168 MiniTrim** – Round and square one piece diecast aluminium downlights with minimal flange for trimless effect
- 172 Focus** – Low glare deep regressed downlights in 2 sizes with single and multiple versions in trim or trimless options
- 184 ProSpex Plus** – Architectural round, square and rectangular downlight programme in 3 sizes with either manual or gear driven hot locking adjustment in trim or trimless options
- 208 ProSpex PlusColour** – Round and square downlights with a choice of 5 anodised bevel finishes with either manual or gear driven hot locking adjustment in trim or trimless options
- 220 Axis** – Fully adjustable single circular gimbal downlights in 3 sizes and 2 anti glare snoot styles in trim or trimless options
- 232 ProSpex Performance** – Fixed and fully adjustable high output professional specification grade reflector downlights in 4 sizes with gear driven hot locking adjustment with a range of delivered lumens from 1800 – 8200lm
- 238 ProSpex Reflector Series** – Fixed and fully adjustable professional specification grade reflector downlights in 2 sizes with gear driven hot locking adjustment

MULTIPLES

- 246 Gimbal** – Fully adjustable, single, twin, triple gimbal downlights in 3 sizes and 2 anti glare snoot styles in trim or trimless options



The Conduit, London
Xavio Design, London
Photography: Steven Joyce



Boulevard Theatre, London
18 Degrees, London
Photography: Tom Lee

Hackney Town Hall, London
dpa lighting consultants
Photography: James Newton







Hutong Restaurant, The Shard, London
Into Lighting Design, London
Photography: Emphasis





Aqua, The Shard, London
Into Lighting Design, London
Photography: Emphasis



InGround / IG Downlights

IG Interior and exterior miniature architectural specification grade IP66 / IP67 rated inground and downlight fixtures in 2 sizes, 40mm or 60mm in both round and square forms.

IG40 has a maximum delivered lumen of 130lm and the IG60 286lm.

With a high impact certification of IK08 for the 40 and IK06 for the 60 the Inground range is classified for walk and drive over applications.

IG Downlight is available in both 40 and 60 sizes and is ideally for exterior under canopy, shower rooms and wet location areas with its high IP rating of IP66/67.

Various beam angles 9°, 15°, 25°, 30° and 18° x 33° elliptical in the 40mm size and 8°, 15°, 25°, 30° and 10° x 45° elliptical in the 60mm size with a choice of colour temperatures, effect devices and recessed mounting options.

A selection of bezel finishes are offered in Bronze, Antique Bronze, Polished Stainless Steel, Brushed Stainless Steel, Hard Anodised Black and Anodised Silver.

InGround and IG Downlight luminaires are ideally suited for “series” connection, where up to 14 (IG40) or 4 (IG60) fixtures can be connected to one driver of the appropriate output.

Private Residence, Menorca
LUV Architecture & Design, Barcelona

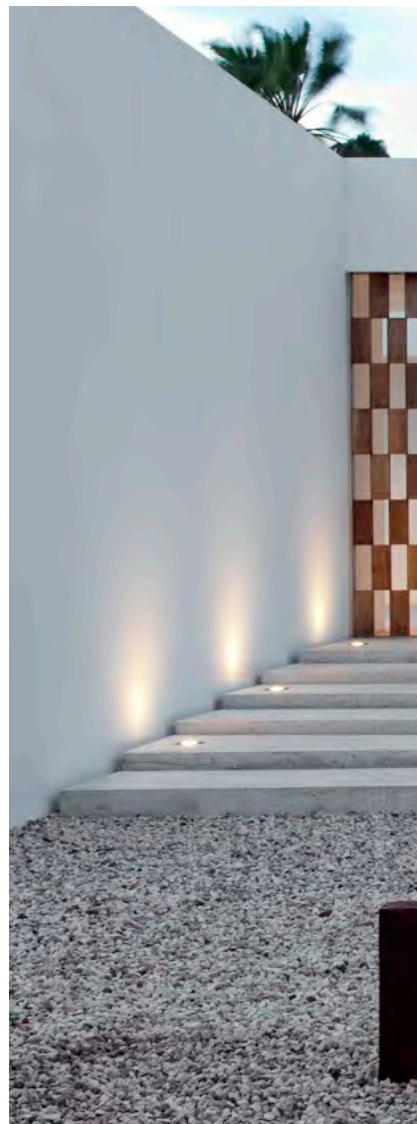



The Grange Residence, London
The Lighting Asylum, London
Photography: Andrewgough Photo



InGround40

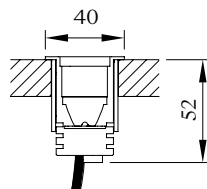

InGround40
IG40
2.6w / 130 lm
9°, 15°, 25°, 30°
and 18° x 33° elliptical beams

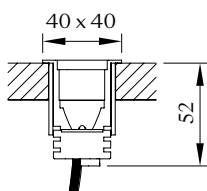

InGround40 Square
IG40-SQ
2.6w / 130 lm
9°, 15°, 25°, 30°
and 18° x 33° elliptical beams



Products Shown Actual Size
Max Delivered Lumen Output at 3000K, Medium Beam angle

InGround60

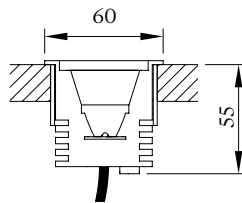

InGround60

IG60

4.75w / 286 lm

8°, 15°, 25°, 30°

and 10° x 45° elliptical beams

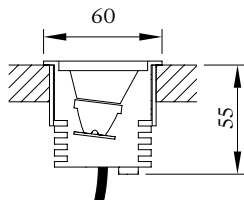

InGround60 7° Angle

IG60-7

4.75w / 286 lm

8°, 15°, 25°, 30°

and 10° x 45° elliptical beams

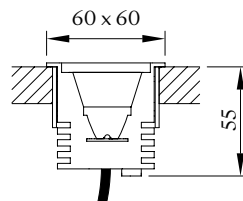

InGround60 Square

IG60-SQ

4.75w / 286 lm

8°, 15°, 25°, 30°

and 10° x 45° elliptical beams



IG40 Downlight

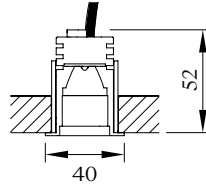

IG40 Downlight

IG40-DL

2.6w / 130 lm

9°, 15°, 25°, 30°

and 18° x 33° elliptical beams

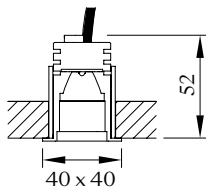

IG40 Downlight Square

IG40-DL-SQ

2.6w / 130 lm

9°, 15°, 25°, 30°

and 18° x 33° elliptical beams



Products Shown Actual Size
Max Delivered Lumen Output at 3000K, Medium Beam angle

IG60 Downlight

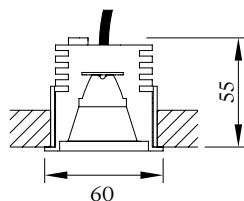

IG60 Downlight
IG60-DL
4.75w / 286 lm
8°, 15°, 25°, 30°
and 10° x 45° elliptical beams

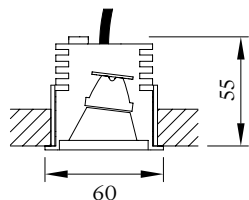

IG60 Downlight 7° Angle
IG60-DL-7
4.75w / 286 lm
8°, 15°, 25°, 30°
and 10° x 45° elliptical beams

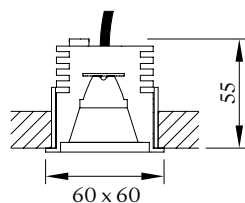

IG60 Downlight Square
IG60-DL-SQ
4.75w / 286 lm
8°, 15°, 25°, 30°
and 10° x 45° elliptical beams



InWall





IW Interior and exterior architectural specification quality miniature IP67 rated recessed wall fixtures in round, square and rectangular forms with varying aperture shapes and sizes. Manufactured in die cast aluminium these robust fixtures are suitable for many applications.

InWall fixtures are designed for low level floor washing, step and night light applications.

Choice of colour temperatures, light outputs and recessed mounting options.

A selection of faceplate finishes offered in Bronze, Antique Bronze, Polished Stainless Steel, Brushed Stainless Steel, Hard Anodised Black, Anodised Silver and Matt White.

InWall fixtures ideally suited for “series” connection where up to 14 fixtures can be connected to one driver of the appropriate output.

InWall

InWall40 Square
IW40-SQ
2.6w / 30 lm

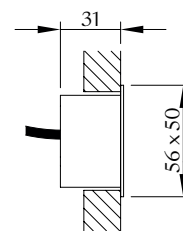
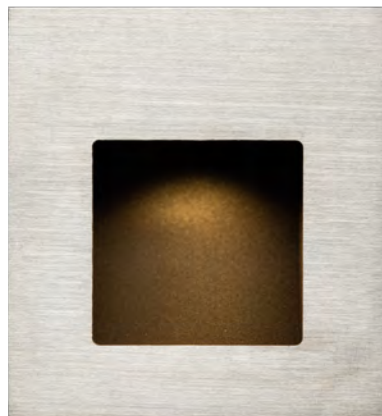
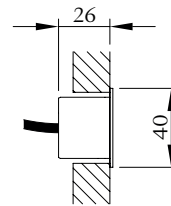
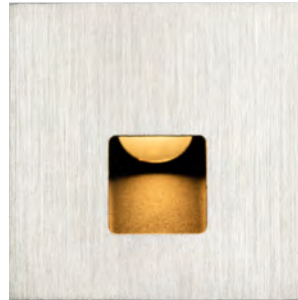

InWall50 Square
IW50S6
2.6w / 33 lm

Products Shown Actual Size
Max Delivered Lumen Output at 3000K

Hilton Hotel, Belfast
Susan Lake Lighting Design, Lewes
Photography: Gavriil Papadiotis (www.gavriilux.com)



The Grange Residence, London
The Lighting Asylum, London
Photography: Andrewgough Photo

InWall

InWall40 Ellipse
IW40
2.6w / 27 lm

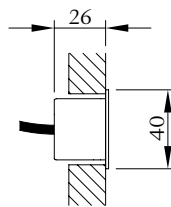
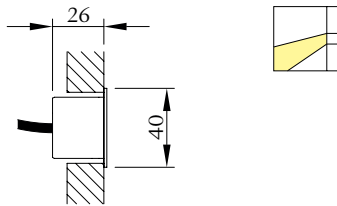

InWall40 Eyelid
IW40-90
2.6w / 18 lm



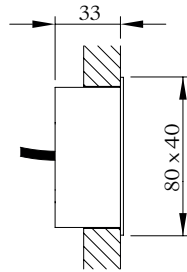
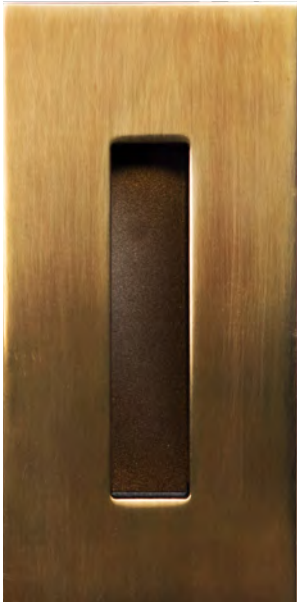

InWall Vertical
IW4080
2.6w / 15 lm

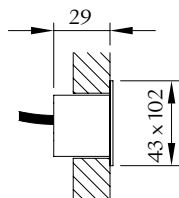

InWall Horizontal
IW1043
4w / 24 lm
24v Constant Voltage

Products Shown Actual Size
Max Delivered Lumen Output at 3000K

Vista / Vista Mini

Private Residence, Caldecott, Singapore
Archetype Studio, Singapore
Nipek, Singapore



Matt Black, IP65 exterior grade, 50mm diameter fully adjustable spotlights. Available as both spike and surface mounted options, with 4 available beams of 12°, 24°, 30° and 44° degrees for accent or pathway lighting.

The 12° version gives 419 lm and an intense 9363cd for highlighting from a distance, complete with a 30° cut off cowl and a 500mm spike as standard.

The range also has an Ultra wide 120° floodlight for wall and planter grazing applications.

In addition to the Vista is the Vista Mini, a 30mm diameter version in 2 beam options 14° and 28° and an Ultra wide 120° miniature floodlight ideally suited to smaller niche planter and pathway situations.

The 14° version gives 104 lm and an intense 1241cd. Also as standard with 30° cut off cowl and a 150mm spike as standard.

Spotlights and floods can be supplied with wall, tree mount or single and twin headed pathlight options and 5m of cable.

All Vista products have a CCT of 2700K

The 24v constant voltage allows multiple fixtures to be wired to one single PSU.



Vista



Private Residence, Menorca
LUV Architecture & Design, Barcelona

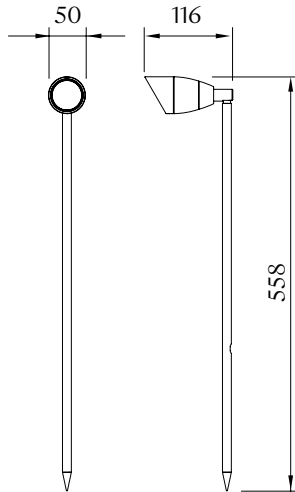

VistaSpot Spike Mounted
VS001-K
8.5w / 419 lm
12°, 24°, 30°, 44°

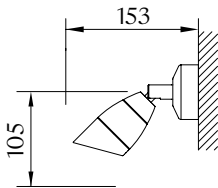

VistaSpot Wall Mounted Monopoint
VS001-W
VistaSpot Tree Mounted Monopoint
VS001-T
8.5w / 419 lm
12°, 24°, 30°, 44°

Max Delivered Lumen Output at 2700K, Narrow Beam Angle

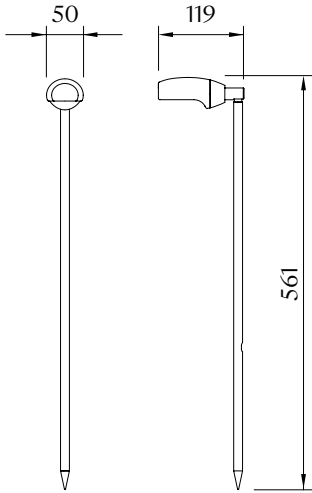

VistaFlood Spike Mounted
VF001-K
6w / 468 lm
120°

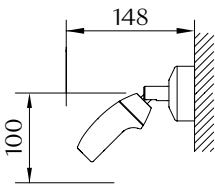

VistaFlood Wall Mounted Monopoint
VF001-W
VistaFlood Tree Mounted Monopoint
VF001-T
6w / 468 lm
120°



Vista Mini



Private Residence, Menorca
LUV Architecture & Design, Barcelona

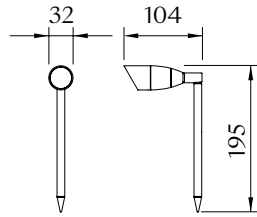

VistaMini Spot Spike Mounted
VS002-K
2w / 104 lm
14°, 28°

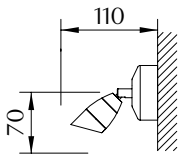

VistaMini Spot Wall Mounted Monopoint
VS002-W
VistaMini Spot Tree Mounted Monopoint
VS002-T
2w / 104 lm
14°, 28°



Max Delivered Lumen Output at 3000K

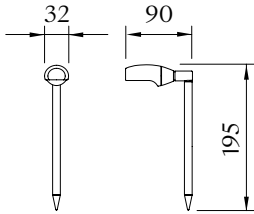

VistaMini Flood Spike Mounted
VF002-K
2w / 119 lm
118°

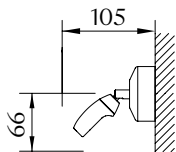

VistaMini Flood Wall Mounted Monopoint
VF002-W
VistaMini Flood Tree Mounted Monopoint
VF002-T
2w / 119 lm
118°



Bulgari Resort, Dubai
Delta Lighting Solutions, Dubai
Concept: Metis Lighting, Milan

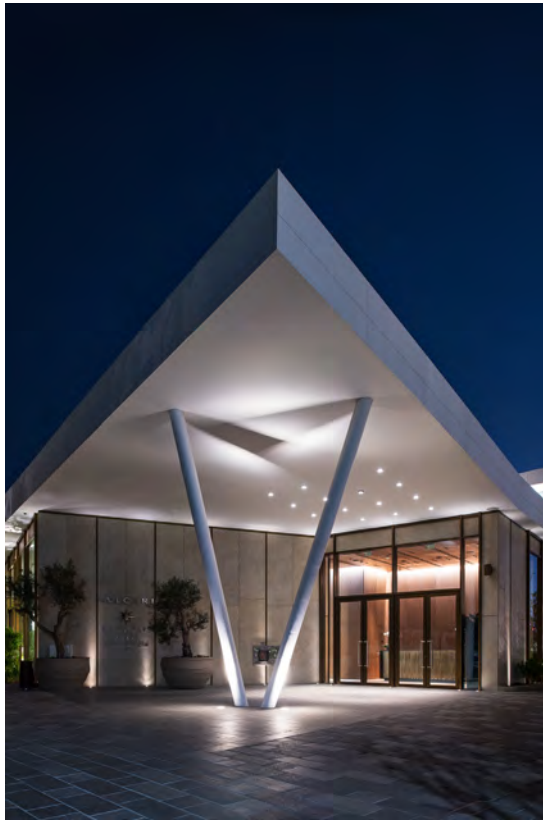

Micro40

An extensive collection of Miniature 40mm fixed and adjustable downlight fixtures in round and square forms.

New products added to the range are the Oculus and the Slot Aperture.

Ideal for small niche areas, millwork, undershelf and marine applications.

Can be installed directly into plasterboard ceilings or for a completely seamless appearance with a trimless finish with the suitable plaster kit.

Various beam angles available in a choice of colour temperatures.

Micro40 fixtures are ideally suited for “series” connection where multiple fixtures can be connected to one driver of the appropriate output.



Micro40 Disc

Micro40 Disc
M40-MD
1.8w / 100 lm
25°, 45°

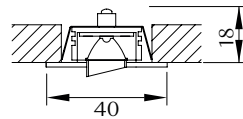

Products Shown Actual Size
Max Delivered Lumen Output at 3000K, Medium Beam angle

Tahini Restraunt, Harpenden, Hertfordshire
Atelier Lighting, Buckinghamshire



Micro40 Oculus

Micro40 Oculus
M40-OC
1.8w / 130 lm
26°, 48°

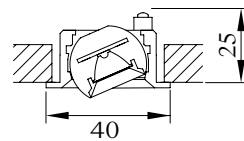

Products Shown Actual Size
Max Delivered Lumen Output at 3000K, Medium Beam angle

Micro40 Slot Accent

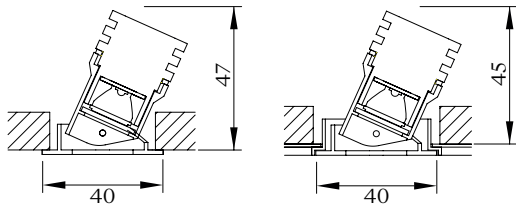
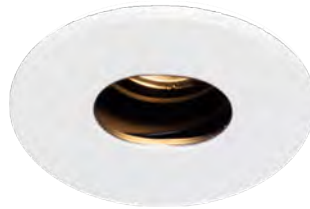

Micro40 Slot Accent

M43-SA

Micro40 Slot Accent Trimless

M43-SA-TL

4.65w / 210 lm

15°, 22°, 27°

Micro40 Slot Accent SS

M43-SA-SS

Micro40 Slot Accent SS Trimless

M43-SA-SS-TL

4.65w / 68 lm / 2026cd / 10°

Micro40 Focus



Micro40 Focus
M40-FF
Micro40 Focus Trimless
M40-FF-TL
2.6w / 135 lm
15°, 25°, 18°x33°

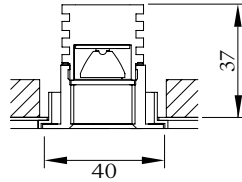
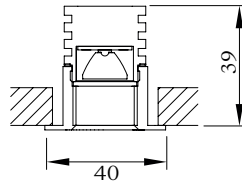

Micro40 Focus Accent
M43-FA
Micro40 Focus Accent Trimless
M43-FA-TL
2.6w / 135 lm
15°, 25°, 18°x33°

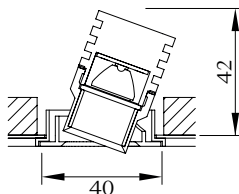
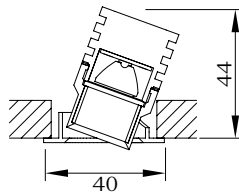

Products Shown Actual Size
Max Delivered Lumen Output at 3000K, Medium Beam angle



Silver Legacy Resort Spa, Nevada
CD+M Lighting Design Group, Los Angeles

Micro40



Micro40 Soft
M40-SF
2.6w / 160 lm
15°, 25°, 18°x33°

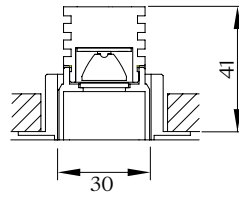
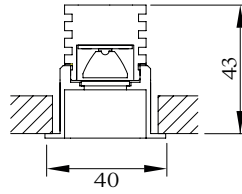

Micro40 Soft Trimless
M40-SF-TL
2.6w / 160 lm
15°, 25°, 18°x33°



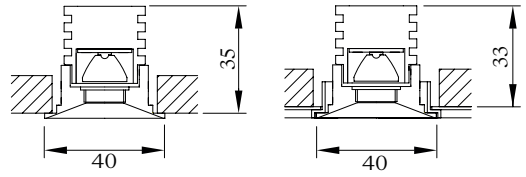

Micro40 Conical

M40-CL

Micro40 Conical Trimless

M40-CL-TL

2.6w / 140 lm

15°, 25°, 18°x33°

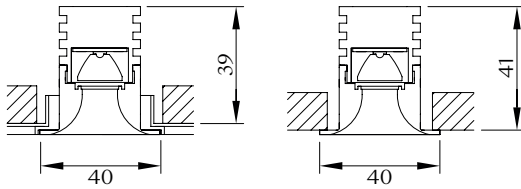

Micro40 Flare

M40-FL

Micro40 Flare Trimless

M40-FL-TL

2.6w / 150 lm

15°, 25°, 18°x33°



Micro40 Edge

M40-PE

Micro40 Edge Trimless

M40-PE-TL

2.6w / 125 lm

15°, 25°, 18°x33°

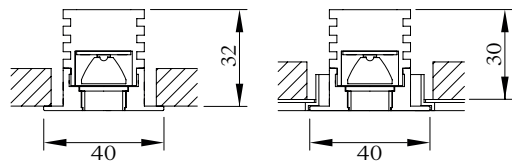

Products Shown Actual Size
Max Delivered Lumen Output at 3000K, Medium Beam angle

Micro40 Square

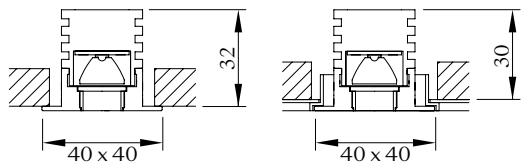

Micro40 Square Edge

M40-SE

Micro40 Square Edge Trimless

M40-SE-TL

2.6w / 140 lm

15°, 25°, 18°x33°

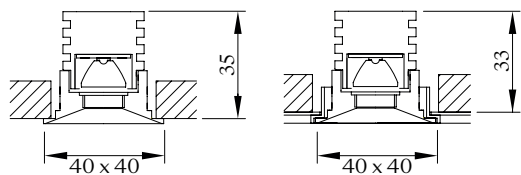

Micro40 Pyramidal

M40-PY

Micro40 Pyramidal Trimless

M40-PY-TL

2.6w / 140 lm

15°, 25°, 18°x33°



Products Shown Actual Size

Max Delivered Lumen Output at 3000K, Medium Beam angle

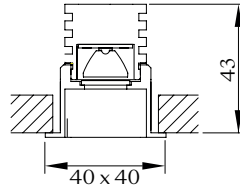

Micro40 Soft Square
M40-SS
2.6w / 190 lm
15°, 25°, 18°x33°

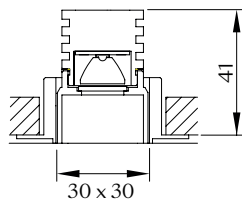

Micro40 Soft Square Trimless
M40-SS-TL
2.6w / 190 lm
15°, 25°, 18°x33°





Asbury Ocean Beach Hotel, New Jersey
WALD Studios, NYC

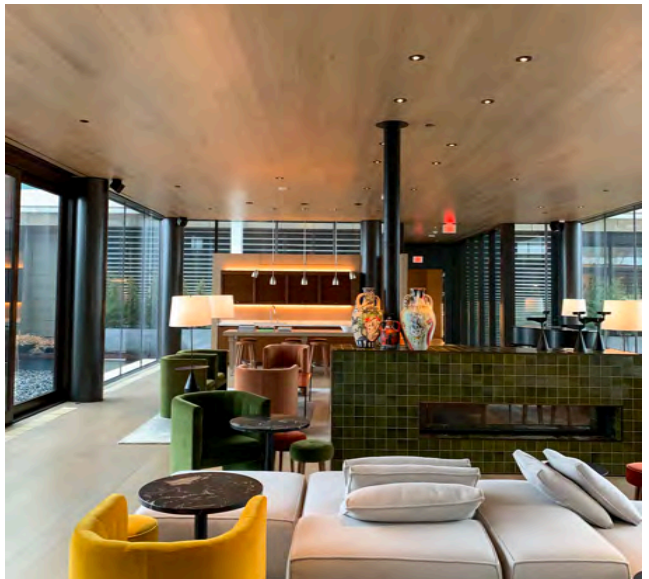

Line

A range of miniature ultra low glare luminaires with 1, 2, 5 or 10 cells with a maximum of 2.6 watts per cell depending on the drive current.

With an extruded aluminium housing and with injection moulded polycarbonate high gloss black cells in either a Cube or Flare shaped aperture.

LineCube and LineFlare are designed to provide an ultra low glare visual appearance with a selection of 3 beam angles of 12°, 34° and 48° available.

The precision optics give a circular pool of light without separation of the beam.

Line is available with a minimal overlap flange or with a trimless kit for a completely seamless appearance.

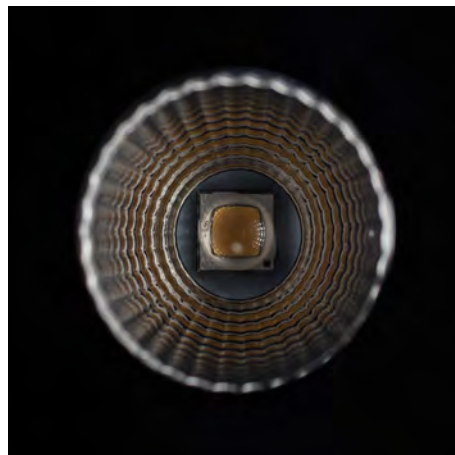



Line Flare

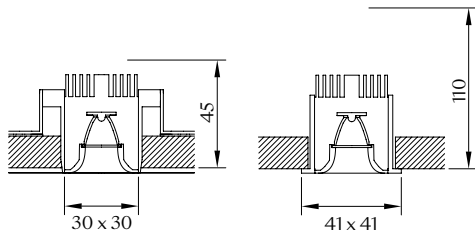

Line Flare1
2601-FL-TR
Line Flare1 Trimless
2601-FL-TL
2.6w / 152 lm
12°, 34°, 48°



Line Flare2
2602-FL-TR
Line Flare2 Trimless
2602-FL-TL
5.2w / 298 lm
12°, 34°, 48°

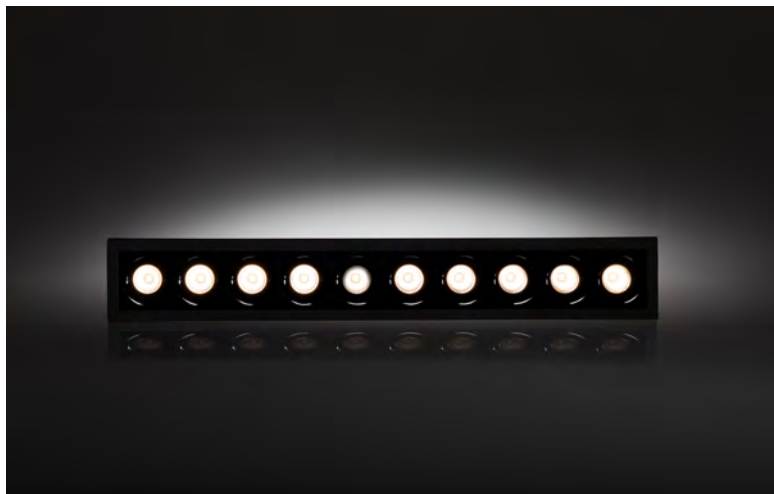
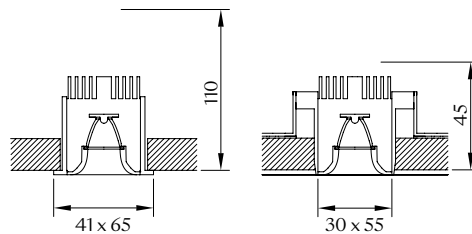

Max Delivered Lumen Output at 3000K, Medium Beam angle



Line Flare5
 2605-FL-TR
Line Flare5 Trimless
 2605-FL-TL
 13w / 772 lm
 12°, 34°, 48°

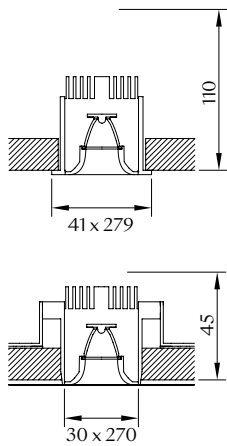
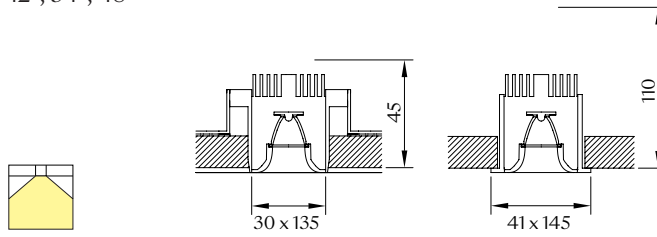

Line Flare10
 2610-FL-TR
Line Flare10 Trimless
 2610-FL-TL
 26w / 1463 lm
 12°, 34°, 48°



Line Cube

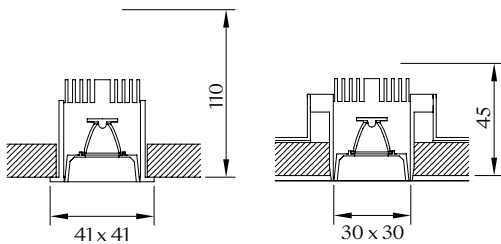

Line Cube1
2601-CB-TR
Line Cube1 Trimless
2601-CB-TL
2.6w / 170 lm
12°, 34°, 48°

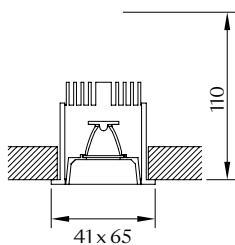
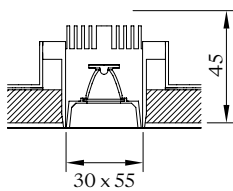

Line Cube2
2602-CB-TR
Line Cube2 Trimless
2602-CB-TL
5.2w / 333 lm
12°, 34°, 48°

Max Delivered Lumen Output at 3000K, Medium Beam angle

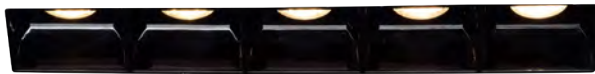
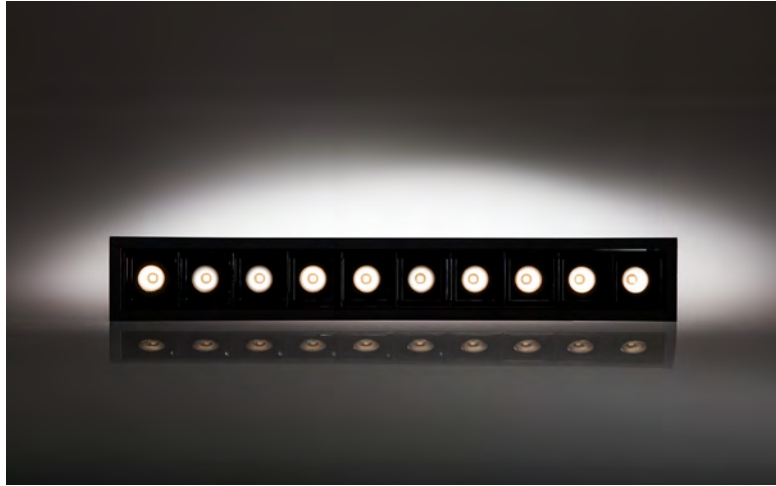

Line Cube5
 2605-CB-TR
Line Cube5 Trimless
 2605-CB-TL
 13w / 831 lm
 12°, 34°, 48°

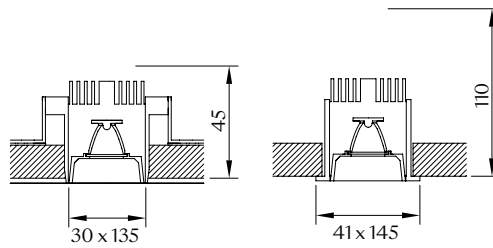

Line Cube10
 2610-CB-TR
Line Cube10 Trimless
 2610-CB-TL
 26w / 1486 lm
 12°, 34°, 48°

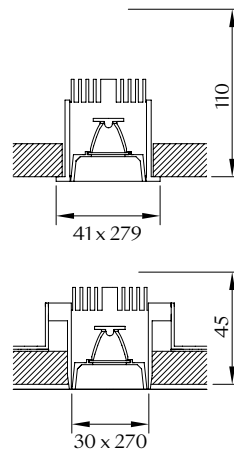



Hotel nhow, London
Elektra Lighting, London
Photography: Guido Pijper
Architecture: Project Orange



The Ivy Asia St Paul's, London
Isometrix Lighting + Design, London
Photography: The Ivy Group

FineLine

FineLine is a multi-functional slimline aluminium low voltage profile system comprising of several different profiles for surface, pendant, recessed trim and trimless installation.

The system incorporates a 48v low voltage track with snap in connection for the lighting fixtures and an integrated databus circuit for lighting control.

Fixtures compatible with FineLine include the Nano, Micro and Mini TubeLED spotlights, Micro, Mini and Midi TubeLED pendants, Line and ProStrip with both DALI and Analogue dimming possibilities.

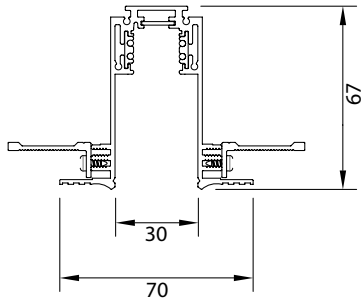

FineLine Recessed Trimless

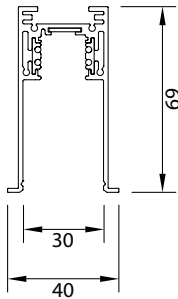

FineLine Recessed

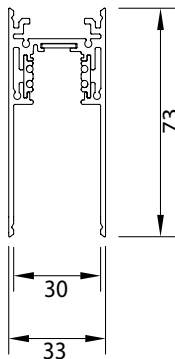

FineLine Surface / Pendant





FineLine

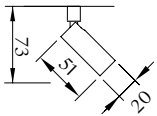

FineLine TubeLED Nano
1100-LED-FLS
2.6w / 166 lm
15°, 30°

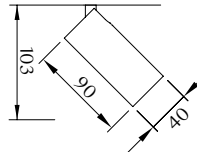

FineLine TubeLED Micro
6100-LED-FLS
7.4w / 478 lm
15°, 24°, 38°

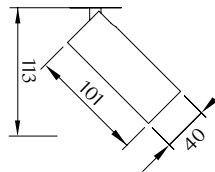

FineLine TubeLED Micro SuperSpot
6100SS-LED-FLS
6.76w / 333 lm / 11080cd / 7°



Max Delivered Lumen Output at 3000K, Medium Beam angle

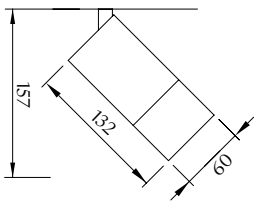

FineLine TubeLED Mini
7100/2-LED-FLS
14.8w / 938 lm
12°, 24°, 38°

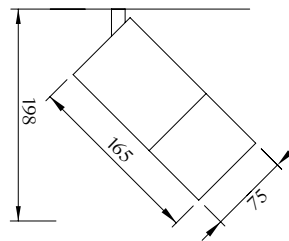

FineLine TubeLED Midi
9100/2-LED-FLS
20.4w / 1451 lm
12°, 19°, 34°

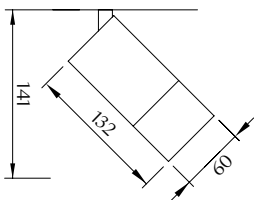

FineLine TubeLED Mini SuperSpot
7100/SS-LED-FLS
14.5w / 722 lm / 26123cd / 7.5°

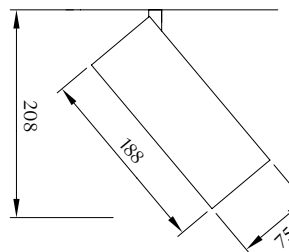

FineLine TubeLED Midi HO
High Output
18875-LED-FLS
36.5w / 2830 lm
16°/24°/34°

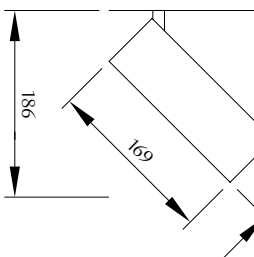

FineLine TubeLED Mini HO
High Output
16960-LED-FLS
24.4w / 1987 lm
17°/24°/35°/55°



FineLine

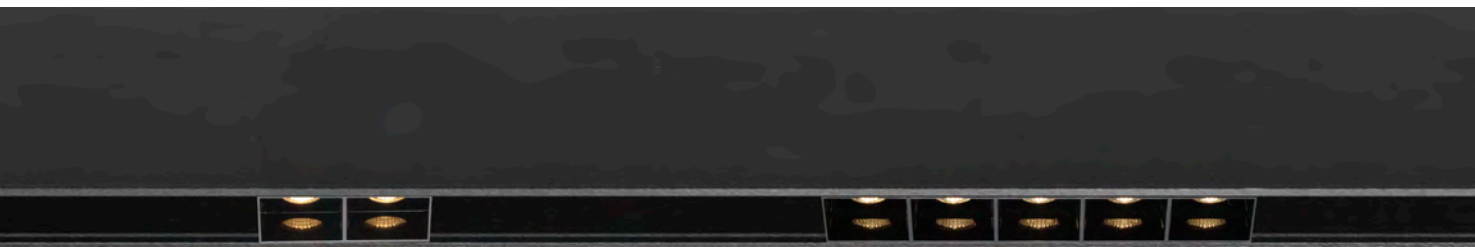

FineLine Cube2
2602-CB-FLS
5.2w / 333 lm
12°, 34°, 48°

FineLine Flare2
2602-FL-FLS
5.2w / 298 lm
12°, 34°, 48°

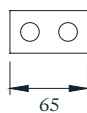
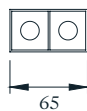

FineLine Cube5
2605-CB-FLS
13w / 831 lm
12°, 34°, 48°

FineLine Flare5
2605-FL-FLS
13w / 772 lm
12°, 34°, 48°

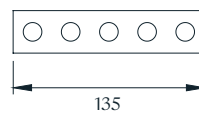
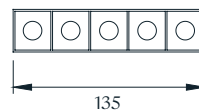

Max Delivered Lumen Output at 3000K, Medium Beam angle



FineLine Flare10

2610-FL-FLS
26w / 1463 lm
12°, 34°, 48°

FineLine Cube10

2610-CB-FLS
26w / 1486 lm
12°, 34°, 48°

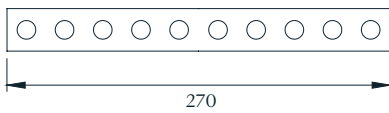
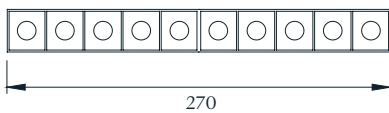

FineLine

FineLine LinearLED
290-LED-FLS
5.4w / 744 lm



FineLine LinearLED
570-LED-FLS
10.8w / 1488 lm



FineLine LinearLED
850-LED-FLS
16.2w / 2232 lm



FineLine LinearLED
1130-LED-FLS
21.6w / 2976 lm

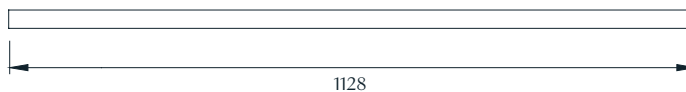

FineLine LinearLED
1410-LED-FLS
27w / 3720 lm



Max Delivered Lumen Output at 3000K, Medium Beam angle



FineLine TubeLED Micro Pendant
040-PM-FLS
7.4W / 478 lm
15°, 24°, 38°

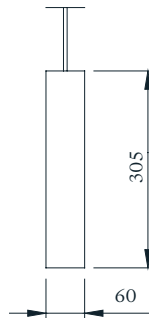

FineLine TubeLED Mini Pendant
060-PM-FLS
14.8W / 936 lm
12°, 24°, 38°



FineLine TubeLED Midi Pendant
075-PM-FLS
22W / 1185 lm
12°, 19°, 34°



ProStrip Black



Private Residence, London

ProStrip Black is a professional specification linear LED product providing direct and indirect illumination highlighting architectural details with a continuous and seamless line of light. Available in 2700K, 3000K, 3500K, 4000K and Super Warm 2000K. High Output and High Efficiency versions.

ProStrip Black

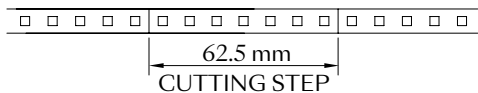
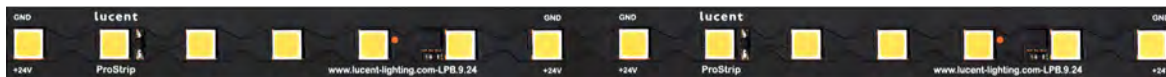

LPB-112-9
9.6w/m / 1335 lm/m
Above based on 3000k

LPB-112-19
19.2w/m / 2532 lm/m
Above based on 3000k

LPB-AH-01
112 LEDs per metre
9.6w/m / 1335 lm/m
19.2w/m / 2532 lm/m

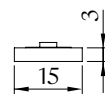

LPB-AH-02
112 LEDs per m
9.6w/m / 374-868 lm/m
19.2w/m / 727-1659 lm/m
Above based on 3000k

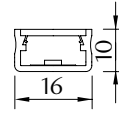

LPB-AH-03
112 LEDs per m
9.6w/m / 232-502 lm/m
19.2w/m / 436-950 lm/m
Above based on 3000k

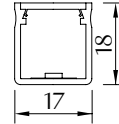

LPB-AH-04
112 LEDs per m
9.6w/m / 749-769 lm/m
19.2w/m / 1458-1504 lm/m
Above based on 3000k

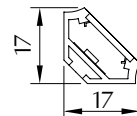



Polo Ralph Lauren Flagship Store, New York
Schwinghammer Lighting, New York
80



The TubeLED range consists of the Nano, Micro, Mini and Midi versions giving a wide range of fixing options, light outputs and beam angles.

The TubeLED range can be installed in 230v Mains Volt and 48v Low Voltage track, Fineline or surface mounted options.

Mains Volt and Low Volt Track mounted TubeLED Mini and Midi incorporate an integral driver in the track adaptor with various *dimming protocols negating the need for a separate driver housing resulting in its clean architectural form.

TubeLED Micro, Mini, Midi accept 2 media accessories and coloured baffles available in the following finishes of Copper, Bronze, Satin Nickel, Satin Gold and Polished Chrome to add a decorative element.

TubeLED Micro and Mini available as SuperSpot versions with ultra narrow beam optics in remote driver and track mounted options. TubeLED Mini and Midi available as High Output.

Wallwash options available for TubeLED Mini and Midi, non High Output versions only.

*Mains Volt Track ... DALI and Phase Dimming only.

Eleven Spitalfields, London
The Lighting Asylum, London
Peter Landers Photography



Spotlights and Track





Maslows Mortimer House, London
Elektra Lighting, London
Photography: Courtesy of Elektra Lighting

TubeLED Nano

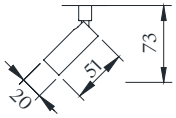

TubeLED Nano Low Voltage
1100-LED-LVTR
2.6w / 165 lm
15°, 30°



Surface Mono Point
SMP-M40

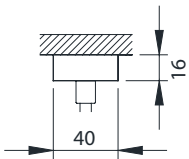

Recessed Mono Point
RMP-Nano

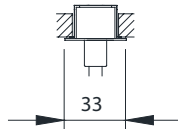

Trimless Mono Point
TMP-Nano

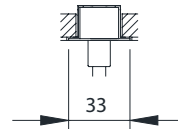

Products Shown Actual Size
Max Delivered Lumen Output at 3000K, Medium Beam angle

TubeLED Micro

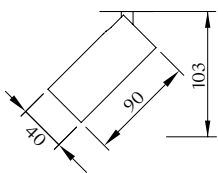

TubeLED Micro Low Voltage
6100-LED-LVTR
7.4w / 478 lm
15°, 24°, 38°



Surface Mono Point
SMP-M40

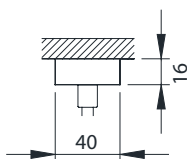

Recessed Mono Point
RMP-Micro

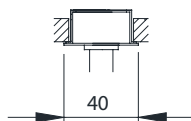

Trimless Mono Point
TMP-Micro

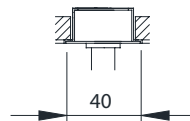

Micro SuperSpot



TubeLED Micro SuperSpot Low Voltage
6100SS-LED-LVTR
8.8w / 411 lm / 13231cd / 7°

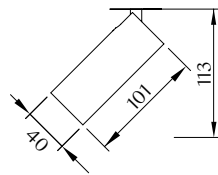

TubeLED Mini

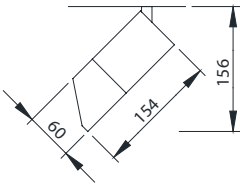

TubeLED Mini Wallwash Mains Voltage
7100/2-LED-WW-MVTR
14.8w / 713 lm

TubeLED Mini Wallwash Low Voltage
7100/2-LED-WW-LVTR



Surface Mono Point
SMP-Mini

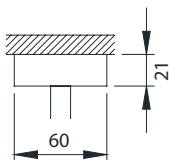

Recessed Mono Point
RMP-Mini

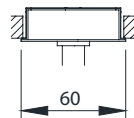

Trimless Mono Point
TMP-Mini

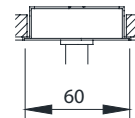



TubeLED Mini
7100/2-LED
14.8w / 936 lm
12°, 24°, 38°

TubeLED Mini Low Voltage
7100/2-LED-LVTR

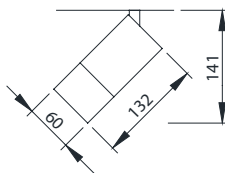

Max Delivered Lumen Output at 3000K, Medium Beam angle

TubeLED Mini Ambiance



TubeLED Mini Ambiance WarmDim Mains Voltage
7100WD-LED-MVTR
3000K - 2000K and 2700K - 2000K



Surface Mono Point
SMP-Mini

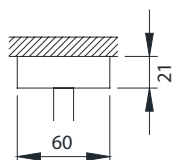

Recessed Mono Point
RMP-Mini

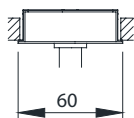

Trimless Mono Point
TMP-Mini

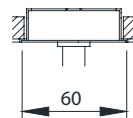



TubeLED Mini Ambiance WarmDim
7100WD-LED
3000K - 2000K and 2700K - 2000K
17.1w / 767 lm
28°, 39°

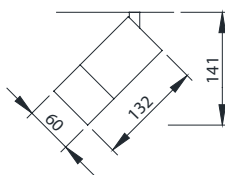

Max Delivered Lumen Output at 3000K, Wide Beam angle

TubeLED Mini Dynamic



TubeLED Mini Dynamic Tuneable White Mains Voltage
7100TW-LED-MVTR
5000K - 2000K



Surface Mono Point
SMP-Mini

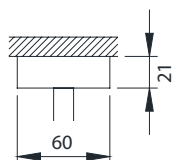

Recessed Mono Point
RMP-Mini

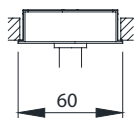

Trimless Mono Point
TMP-Mini

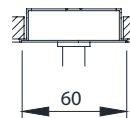



TubeLED Mini Dynamic Tuneable White
7100TW-LED
5000K - 2000K
15.1w / 848 lm
25°, 35°

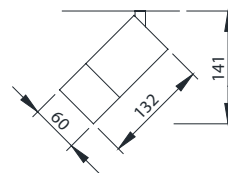

Max Delivered Lumen Output at 3000K, Wide Beam angle

TubeLED Mini SuperSpot



TubeLED SuperSpot Low Voltage
7100/SS-LED-LVTR

Also available for FineLine
7100/SS-LED-FLS



Surface Mono Point
SMP-Mini

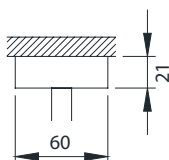

Recessed Mono Point
RMP-Mini

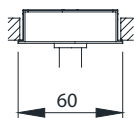

Trimless Mono Point
TMP-Mini

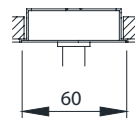



TubeLED SuperSpot
7100/SS-LED
14.5w / 643 lm / 25526cd / 7.5°

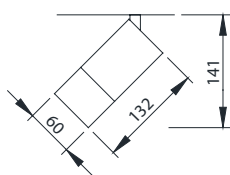

Max Delivered Lumen Output at 3000K, Medium Beam angle

TubeLED Mini High Output



TubeLED Mini HO Low Voltage
High Output
16960-LED-LVTR

Also available for FineLine
High Output
16960-LED-FLS



Surface Mono Point
SMP-Mini

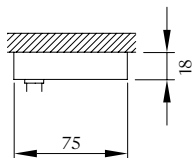

Recessed Mono Point
RMP-Mini

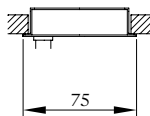

Trimless Mono Point
TMP-Mini

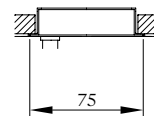



TubeLED Mini High Output
16960-LED
24.4w / 1987 lm
17°/24°/35°/55°

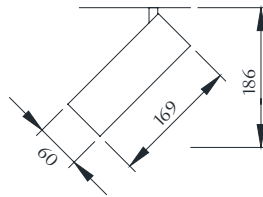

Max Delivered Lumen Output at 3000K, Medium Beam angle





Davies and Brook, Claridges, London
L'Observatoire International, New York
Photography: Courtesy of Claridges

TubeLED Midi



TubeLED Midi Wallwash Mains Voltage
9100/2-LED-WW-MVTR
22w / 735 lm

TubeLED Midi Wallwash Low Voltage
9100/2-LED-WW-LVTR

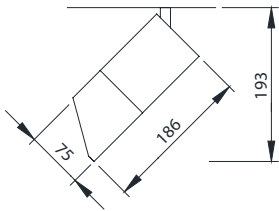

Surface Mono Point
SMP-Midi

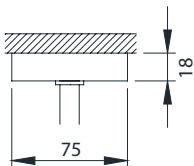

Recessed Mono Point
RMP-Midi

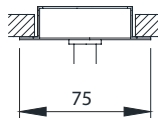

Trimless Mono Point
TMP-Midi

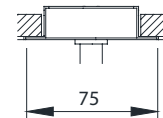



TubeLED Midi
9100/2-LED
22w / 1185 lm
12°, 19°, 34°

TubeLED Midi Low Voltage
9100/2-LED-LVTR

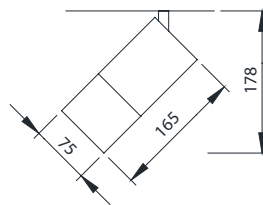

Max Delivered Lumen Output at 3000K, Medium Beam angle

TubeLED Midi Ambiance



TubeLED Midi Ambiance WarmDim Mains Voltage
9100WD-LED-MVTR



Surface Mono Point
SMP-Midi

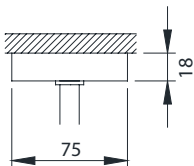

Recessed Mono Point
RMP-Midi

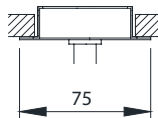

Trimless Mono Point
TMP-Midi

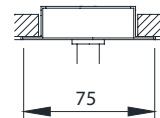



TubeLED Midi Ambiance WarmDim
9100WD-LED
27.1w / 1681 lm
19°, 23°, 42°

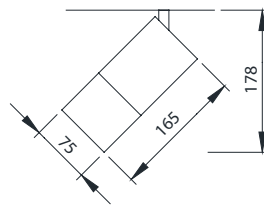

Max Delivered Lumen Output at 3000K, Medium Beam angle

TubeLED Midi Dynamic



TubeLED Midi Dynamic Tuneable White Mains Voltage
9100TW-LED-MVTR



Surface Mono Point
SMP-Midi

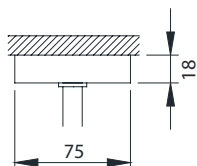

Recessed Mono Point
RMP-Midi

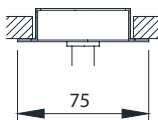

Trimless Mono Point
TMP-Midi

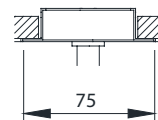



TubeLED Midi Dynamic Tuneable White
9100TW-LED
23.4w / 1480 lm
19°, 23°, 42°

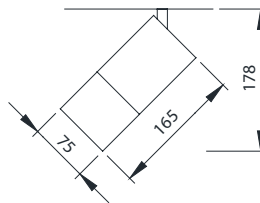

TubeLED Midi High Output



TubeLED Midi HO Low Voltage
High Output
18875-LED-LVTR

Also available for FineLine
High Output
18875-LED-FLS



Surface Mono Point
SMP-Mini

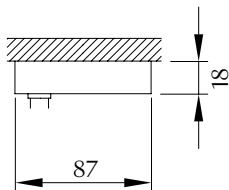

Recessed Mono Point
RMP-Mini

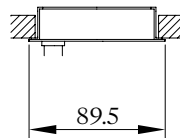

Trimless Mono Point
TMP-Mini

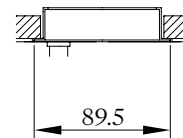



TubeLED Midi High Output
18875-LED
34.6w / 2830 lm
16°/24°/34°/60°

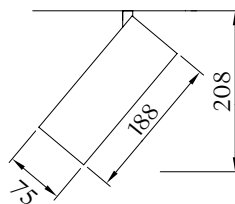

Max Delivered Lumen Output at 3000K, Medium Beam angle

Mains Voltage Track

230v mains voltage track

Universal mains voltage 3 circuit track with integrated databus for all dimming protocols.

The track is available in surface mount, pendant with recessed trim and trimless options.

Designed for use in lighting projects and schemes employing controllable or fixed output systems. Allowing the upgrade of controllable lighting fixtures at any time.



Mains Voltage Surface
MVT-9000-ST

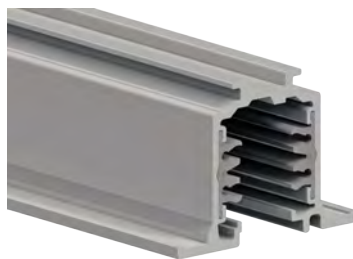

Mains Voltage Recessed
MVT-9000-R



Mains Voltage Recessed Trimless
MVT-9000-TL

Low Voltage Track

48v low voltage track

48v low voltage miniature track utilises a snap in system on the track adaptor and electrical connections.

With an integrated databus for either DALI or Analogue lighting control.

Available in surface mount, pendant and with recessed trim and trimless options.

The track is also incorporated into the Lucent FineLine profile system.



Low Voltage Surface
LVT-9500-ST



Low Voltage Recessed
LVT-9500-R



Low Voltage Recessed Trimless
LVT-9500-TL3



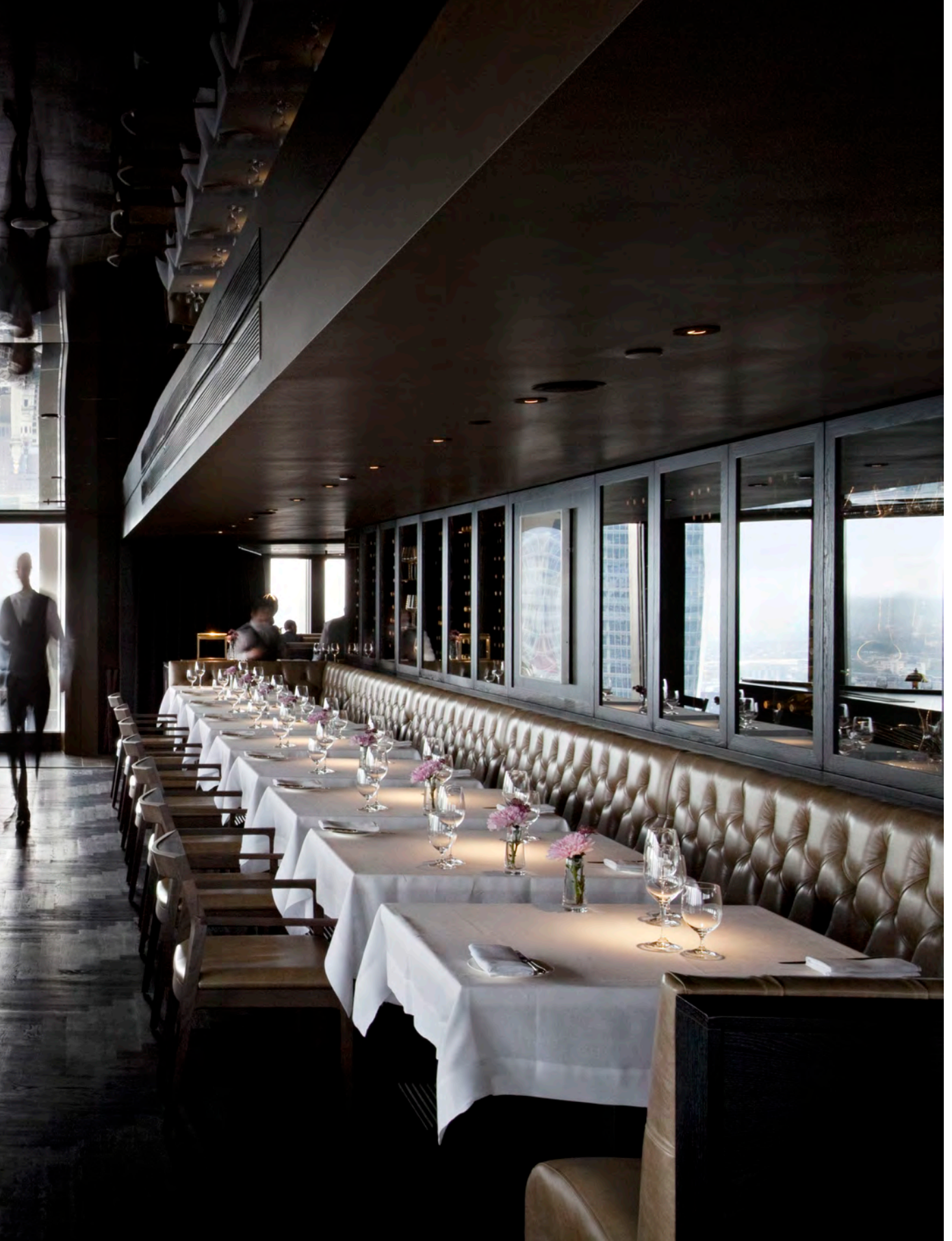

City Social, Tower42, London
Russell Sage Studio, London





Surface and Pendant

Surface and Pendant mounted tubular luminaires for all types of retail, residential and architectural interiors.

TubeLED Pendant and Surface in 3 diameters 40, 60 and 75mm and with integral drivers (remote available) and a choice of dimming protocols (60 and 75 only).

There are 2 additional diameters of 58 and 95mm for surface mounting only.

Pendant mounted fixtures can be mounted directly to the ceiling or track mounted for either 230v mains or 48v low voltage tracks and can be incorporated within our FineLine system.

TubeLED versions accept a colour baffle accessory in Copper, Bronze, Satin Nickel, Satin Gold and Polished Chrome.





TubeLED Surface



TubeLED Micro Surface Shallow
040-SM-SH
7.4w / 478 lm
15°, 24°, 38°
c/w Remote Driver

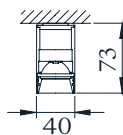

TubeLED coloured inserts

- Satin Gold
- Satin Nickel
- Polished Silver
- Bronze
- Copper

TubeLED Mini Surface Shallow
060-SM-SH
13.6w / 936 lm
12°, 24°, 38°
c/w Remote Driver

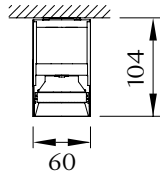

TubeLED Midi Surface Shallow
075-SM-SH
22w / 1185 lm
12°, 19°, 34°
c/w Remote Driver

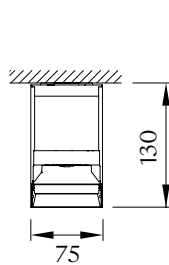

TubeLED Pendant

TubeLED Micro Pendant

040-PM
7.4W / 478 lm
15°, 24°, 38°

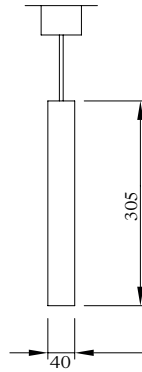

TubeLED coloured inserts

Satin Gold
Satin Nickel
Polished Silver
Bronze
Copper

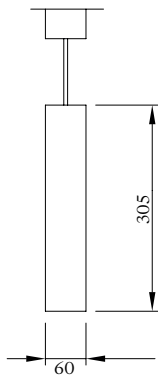

TubeLED Mini Pendant
060-PM
14.8W / 936 lm
12°, 24°, 38°

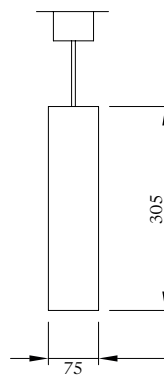

TubeLED Midi Pendant
075-PM
22W / 1185 lm
12°, 19°, 34°

Surface58

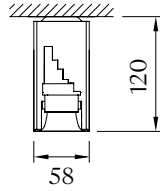

Surface58
90580-LED
c/w Remote Driver

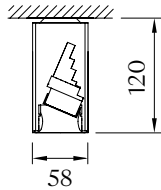

Surface58 Accent
90583-LED
c/w Remote Driver



Matching recessed downlights

Flare55 - page 151

Surface95

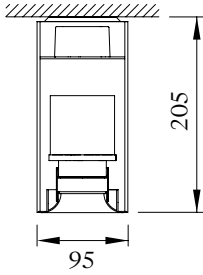

Surface95 Flare
200950-FL-LED
c/w Integral Driver

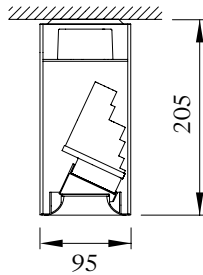

Surface95 Flare Accent
200953-FL-LED
c/w Integral Driver

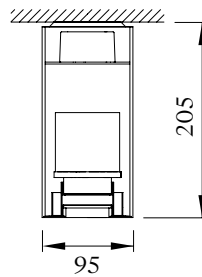

Surface95 Edge
200953-PE-LED
c/w Integral Driver

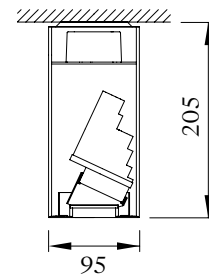

Surface95 Edge Accent
200953-PE-LED
c/w Integral Driver

Matching recessed downlights

Flare90 - page 151
Edge90 - page 130

Hilton Imperial, Dubrovnik, Croatia
dpa lighting consultants
Photography: Gareth Gardner

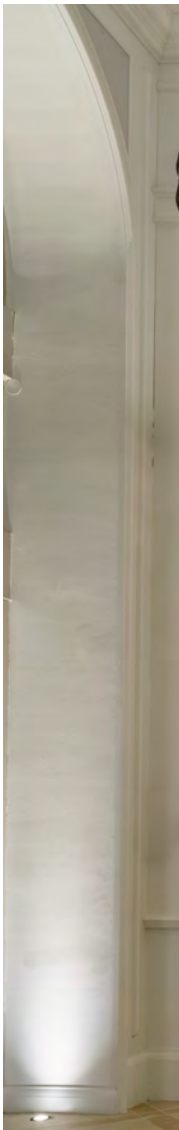



LucentLED

Lucent's range of LED modules incorporate the latest technology and optical lenses.

Our range now includes: -

ULTRA High 98 CRI and 96 R9 in the LED35, LED51 and LED71 sizes.

Ambiance WarmDim in LED51 and LED71 with dim to warm control from 3000K or 2700K down to 2000K.

Dynamic White enabling tuning of the CCT and Intensity from 5000K down to 2000K in both LED51 and LED71 modules.

Superspot SS very narrow beam in LED51 (7°) and LED71 (10°)

High Output (HO) with 1800 lumen output from the LED51 module.

Low Profile (LP) shallow height LED51 module where recess depth restrictions govern the height available.





LED35/2

Powerful miniature single point source 35mm diameter LED modules in both >90 CRI and >98 CRI (ULTRA) for our range of small sized downlights, Edge60, Square Edge60, Flare55, Soft50, Soft50 Colour, Soft50 Square, Axis Micro and Gimbal Micro.

LED35/2

- >90 CRI
- 2700K and 3000K
(3500K & 4000K upon request)
- 15°, 24° and 36° beam options
- Up to 600 lumen output (3000K, 36°)
- Up to 3300 Candelas (3000K, 15°)
- Fully dimmable 1-10v, DALI and Phase

LED35/U Ultra

- Ultra High >98 CRI
- Excellent Colourmetrics R9-96
TM30: Rf 94 Rg 99
- 2700K and 3000K
(3500K & 4000K upon request)
- 15°, 24° and 36° beam options
- Up to 540 lumen output (3000K, 36°)
- Up to 3000 Candelas (3000K, 15°)
- Fully dimmable 1-10v, DALI and Phase

LED51

50mm diameter range of LED modules in >90 CRI and >98 CRI (ULTRA) also 7° SuperSpot, Ambiance WarmDim in >90 CRI replicating the dim to warm aspect of tungsten light sources and Dynamic Tuneable White in >90 CRI controlled by a dual channel LED driver, controlling warm and cool white LEDs enabling the user to select the desired colour temperature and intensity between 5000K and 2000K. For use with our 50mm sized downlights, Edge90, Square Edge90, Duo, Flare90, Soft70, Soft70 Colour, SoftSquare70, MiniTrim, Focus60, Focus90, FocusMulti, Plus Mini, Plus, PlusMulti, PlusColour Bevel, PlusColour Bevel Square, Axis Mini, ProSpex100 and Gimbal Mini.

Also with additions to the range of our two Shallow height and High Output versions.

LED51/2

- >90 CRI
- 2700K and 3000K
(3500K & 4000K upon request)
- 12°, 24°, 38° and 55° beam options
- Up to 1250 lumen output (3000K, 55°)
- 13600 Candelas (3000K, 12°)
- Fully dimmable 1-10v, DALI and Phase

LED51/U Ultra

- Ultra High >98 CRI
- Excellent Colourmetrics R9-96
TM30: Rf 94 Rg 99
- 2700K and 3000K
(3500K & 4000K upon request)
- 12°, 24°, 38° and 55° beam options
- Up to 1000 lumen output * (3000K, 38°)
- 12300 Candelas * (3000K, 12°)
- Fully dimmable 1-10v, DALI and Phase

LED51SS SuperSpot

- >90 CRI
- 2700K and 3000K
(3500K & 4000K upon request)
- 7° beam
- Up to 665 lumen output (3000K)
- Up to 28900 Candelas (3000K)
- Fully dimmable 1-10v, DALI and Phase

LED51WD Ambiance WarmDim

- >95 CRI
- Dim to Warm technology
- 3000K - 2000K and 2700K - 2000K
- 28° and 39° beam options
- Up to 880 lumen output (3000K, 39°)
- Up to 2400 Candelas (3000K, 28°)
- Fully dimmable 1-10v, DALI and Phase
- No special control system or wiring required.

LED51TW Dynamic Tuneable White

- >95 CRI
- 5000K - 2000K
- 25° and 35° beam options
- Up to 780 lumen output (3000K, 35°)
- Up to 2300 Candelas (3000K, 25°)
- Fully dimmable DALI Type 6 and DALI 8 - Tuneable White 2 channel driver required

LED51/2-SH-LO Shallow Height Low Output

- >90 CRI
- 2700K and 3000K
(3500K & 4000K upon request)
- 12°, 24°, 38° and 55° beam options
- Up to 890 lumen output (3000K, 55°)
- Up to 9720 Candelas (3000K, 12°)
- Fully dimmable 1-10v, DALI and Phase

LED51/U-SH-LO Shallow Height Low Output Ultra

- Ultra High >98 CRI
- Excellent Colourmetrics R9-96
TM30: Rf 94 Rg 99
- 2700K and 3000K
(3500K & 4000K upon request)
- 12°, 24°, 38° and 55° beam options
- Up to 700 lumen output (3000K, 38°)
- Up to 8770 Candelas (3000K, 12°)
- Fully dimmable 1-10v, DALI and Phase

LED51/2-SH-FO Shallow Height Full Output

- >90 CRI
- 2700K and 3000K
(3500K & 4000K upon request)
- 12°, 24°, 38° and 55° beam options
- Up to 1250 lumen output (3000K, 55°)
- Up to 13600 Candelas (3000K, 12°)
- Fully dimmable 1-10v, DALI and Phase

LED51/U-SH-FO Shallow Height Full Output Ultra

- Ultra High >98 CRI
- Excellent Colourmetrics R9-96
TM30: Rf 94 Rg 99
- 2700K and 3000K
(3500K & 4000K upon request)
- 12°, 24°, 38° and 55° beam options
- Up to 1000 lumen output * (3000K, 38°)
- Up to 12300 Candelas * (3000K, 12°)
- Fully dimmable 1-10v, DALI and Phase

LED51/70 High Output

- >90 CRI
- 2700K and 3000K
(3500K & 4000K upon request)
- 12°, 24°, 38° and 55° beam options
- Up to 2200 lumen output (3000K, 55°)
- Up to 22620 Candelas (3000K, 12°)
- Fully dimmable 1-10v, DALI and Phase

LED51/70-U High Output Ultra

- Ultra High >98 CRI
- Excellent Colourmetrics R9-96
TM30: Rf 94 Rg 99
- 2700K and 3000K
(3500K & 4000K upon request)
- 12°, 24°, 38° and 55° beam options
- Up to 1750 lumen output (3000K, 38°)
- Up to 20410 Candelas (3000K, 12°)
- Fully dimmable 1-10v, DALI and Phase

All Lumen and Candela information is based on 3000K
See www.lucent-lighting.com for full details

LED71

70mm diameter range of LED modules in LED modules in >90 CRI and >98 CRI (ULTRA) also 7° SuperSpot, Ambiance WarmDim in >90 CRI to replicate the dim to warm aspect of tungsten light sources and Dynamic Tuneable White in >90 CRI controlled by a dual channel LED driver, controlling warm and cool white LEDs enabling the user to select the desired colour of white and intensity between 5000K and 2000K, for our range of medium to large sized downlights, Soft90, Soft90 Colour, PlusXL, Axis Midi, ProSpex Reflector140 and Gimbal Midi.

LED71

- >90 CRI
- 2700K and 3000K (3500K & 4000K upon request)
- 12°, 19° and 34° beam options
- Up to 2100 lumen output (3000K, 12°)
- 27800 Candellas (3000K, 12°)
- Fully dimmable 1-10v, DALI and Phase

LED71/U Ultra

- >98 CRI
- 2700K and 3000K (3500K & 4000K upon request)
- 12°, 19° and 34° beam options
- Up to 1618 lumen output (3000K, 12°)
- 20800 Candellas (3000K, 12°)
- Fully dimmable 1-10v, DALI and Phase

LED71SS SuperSpot

- >90 CRI
- 2700K and 3000K (3500K & 4000K upon request)
- 10° beam
- Up to 1980 lumen output (3000K)
- Up to 44475 Candellas (3000K)
- Fully dimmable 1-10v, DALI and Phase

LED71WD Ambiance WarmDim

- >90 CRI
- Dim to Warm technology
- 3000K - 2000K and 2700K - 2000K
- 19°, 23° and 42° beam options
- Up to 1822 lumen output (3000K, 19°)
- Up to 6700 Candellas (3000K, 19°)
- Fully dimmable 1-10v, DALI and Phase

LED71TW Dynamic Tuneable White

- >90 CRI
- 5000K - 2000K
- 19°, 23° and 42° beam options
- Up to 1900 lumen output (3000K, 19°)
- Up to 7100 Candellas (3000K, 19°)
- Fully dimmable DALI Type 6 and DALI 8 - Tuneable White 2 channel driver required

All Lumen and Candela information is based on 3000K
See www.lucent-lighting.com for full details



Alchemist, Canary Wharf, London
Foundry, London
Architect: MacAulay Sinclair, Nottingham
Photography: James Newton (@James Newton)

Edge

Edge is an extensive range of discreet downlights in 2 sizes and in both round and square forms.

Edge90 in fixed, accent, wallwash and washlight versions for both trim or trimless seamless installations.

Edge60 and Square Edge60 in fixed and accent.

Square Edge90 in fixed, accent and washlight versions with magnetic front plate for easy access to the fixture.

Edge90 available in IP44,54 and IP65 versions for bathroom and shower installations.

Edge90 and Square Edge90 also available with one hour fire rating to EN1365-2 and EN1363-1:60 mins

Features a black Edge baffle to ensure glare free appearance for a fully professional look.

Ball catch mechanism allows easy rotation and removal from the ceiling kit.

The Edge is produced in 2 sizes. Edge60 for the Lucent LED35 modules and Edge90 for the complete range of Lucent LED51 modules.

Edge90 and Square Edge90 available with multiple trimless installation kits for 2 or 3 fixtures ensuring even spacing.

Square Edge is produced in 2 sizes, Square Edge60 for the Lucent LED35 modules and Square Edge90 for the complete range of Lucent LED51 modules. For trim or trimless installations.

MR16 LED and GU10 LED versions of Edge and Square Edge are available.

All Edge luminaires accept a range of louvres and lenses.

The Edge look is also available in the Plus range when a “hot” locking feature is required.





Edge60

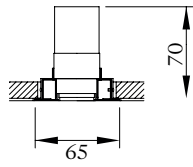
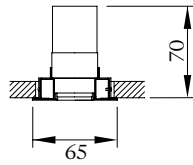

Edge60
61413-F-LED-PB
Edge60 Trimless
61413-F-LED-PC

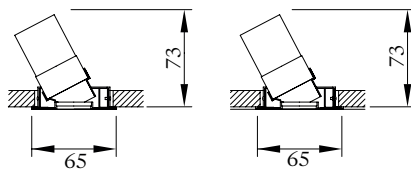

Edge60 Accent
61413-A-LED-PB
Edge60 Accent Trimless
61413-A-LED-PC



Christian Dior, London
Metis Lighting, Milan



Edge90

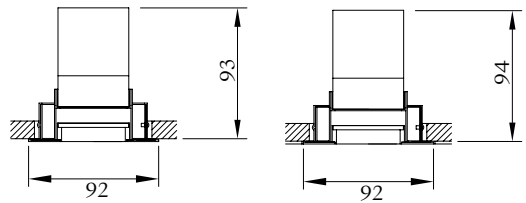
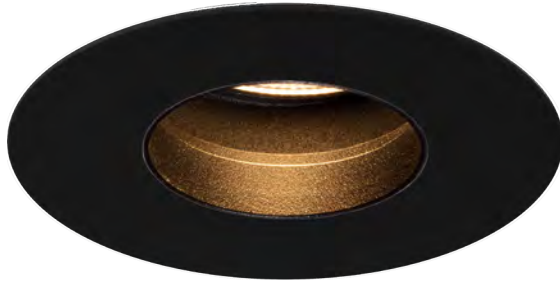

Edge90
91413-F-LED-PB
Edge90 Trimless
91413-F-LED-PC

Edge90 Fire Rated
91413-F-FR-PB
Edge90 Fire Rated Trimless
91413-F-FR-PC



Edge90 Accent
91413-A-LED-PB
Edge90 Accent Trimless
91413-A-LED-PC

Edge90 Accent Fire Rated
91413-A-FR-PB
Edge90 Accent Fire Rated Trimless
91413-A-FR-PC

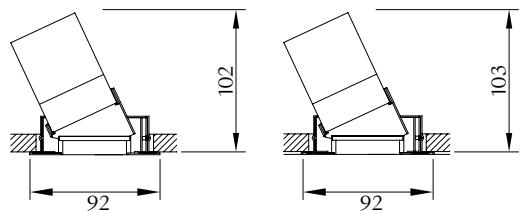
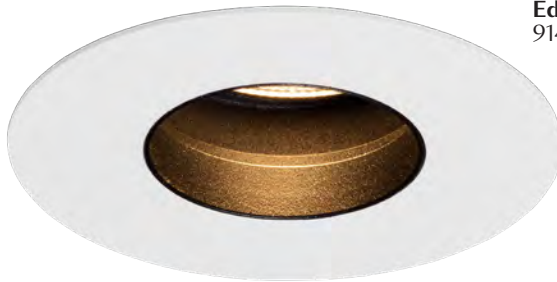

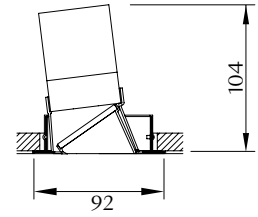
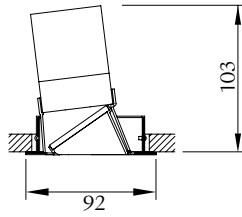

Edge90 Wallwash
 91413-WW-LED-PB
Edge90 Wallwash Trimless
 91413-WW-LED-PC

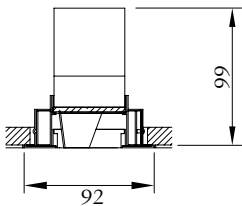
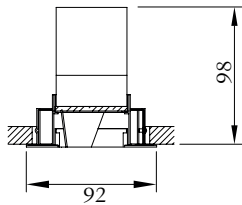

Edge90 Washlight
 91413-WL-LED-PB
Edge90 Washlight Trimless
 91413-WL-LED-PC

Edge90 Washlight Fire Rated
 91413-WL-FR-PB
Edge90 Washlight Fire Rated Trimless
 91413-WL-FR-PC



Edge90 Multiple

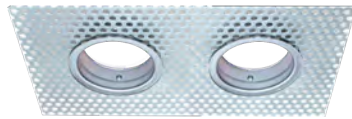

291413-TL
Twin Trimless Kit for Edge90

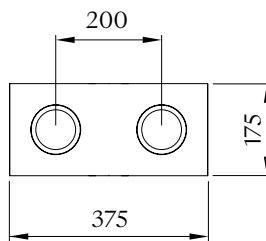

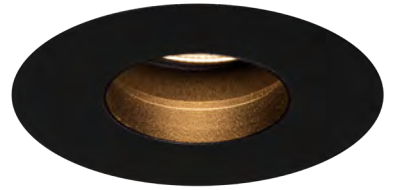
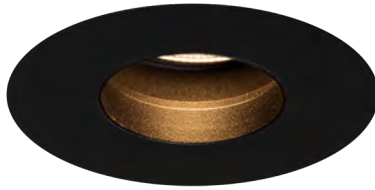
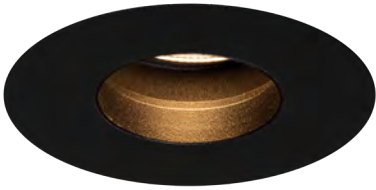

391413-TL
Triple Trimless Kit for Edge90

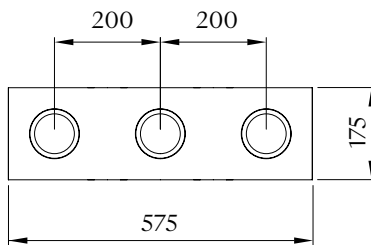

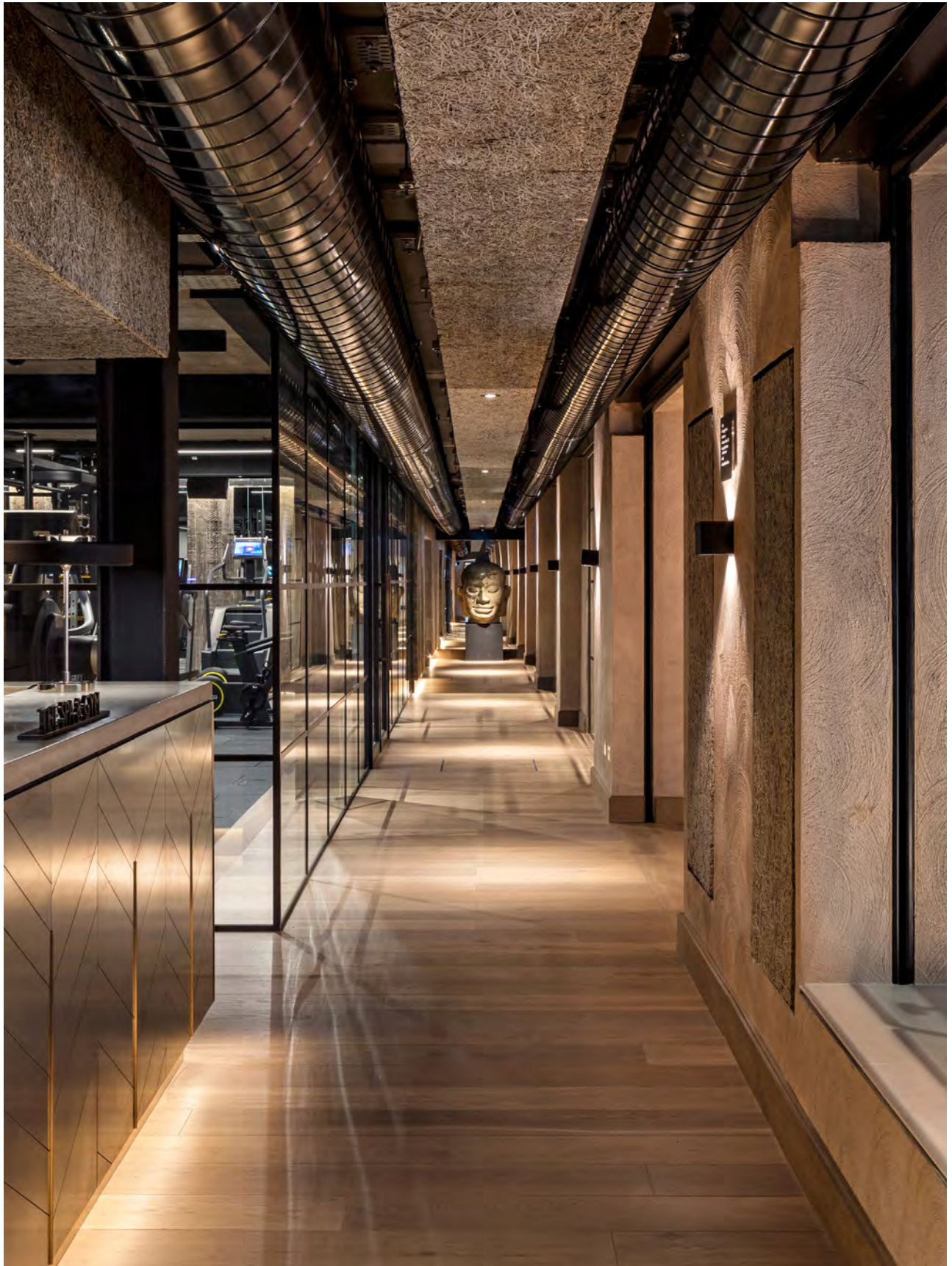

The Edwardian Manchester
Lighting Design International, London
Photography: Andrew Beasley

Edge90 IP44 / IP54 / IP65

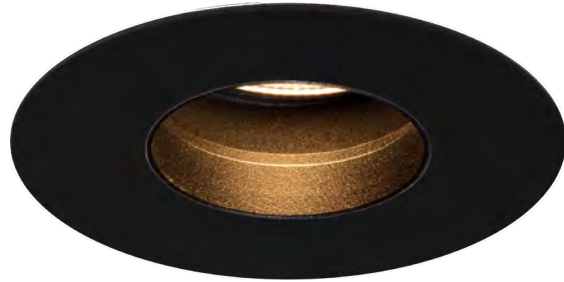
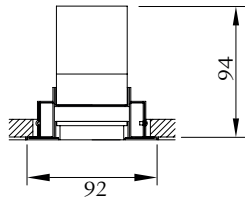
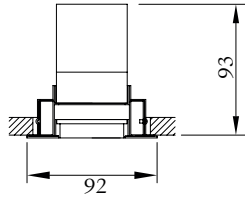

Edge90 IP

91413-F-LED-44-PB

91413-F-LED-54-PB

91413-F-LED-65-PB

Edge90 IP Trimless

91413-F-LED-44-PC

91413-F-LED-54-PC

91413-F-LED-65-PC

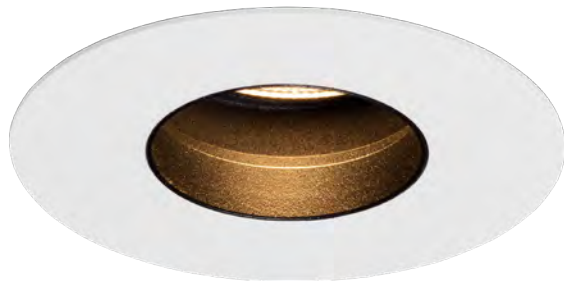
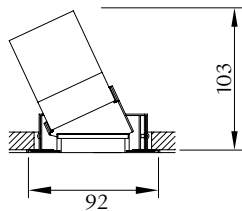
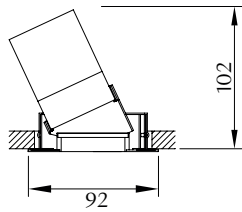

Edge90 IP Accent

91413-A-LED-44-PB

91413-A-LED-54-PB

91413-A-LED-65-PB

Edge90 IP Accent Trimless

91413-A-LED-44-PC

91413-A-LED-54-PC

91413-A-LED-65-PC





ICHIBUNS, London
Light IQ, London

Edge60 Square

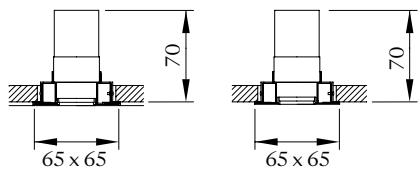

Edge60 Square
61433-F-LED-PB
Edge60 Square Trimless
61433-F-LED-PC

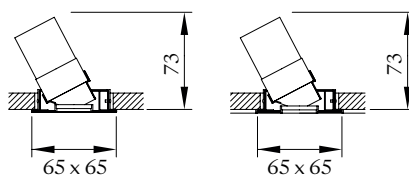

Edge60 Square Accent
61433-A-LED-PB
Edge60 Square Accent Trimless
61433-A-LED-PC

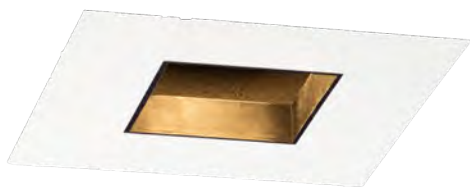

Edge90 Square



Edge90 Square
81433-F-LED-PB
Edge90 Square Trimless
81433-F-LED-PC

Edge90 Square Fire Rated
81433-F-FR-PB
Edge90 Square Fire Rated Trimless
81433-F-FR-PC

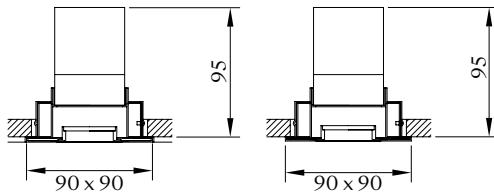



Edge90 Square Accent

81433-A-LED-PB

Edge90 Square Accent Trimless

81433-A-LED-PC

Edge90 Square Accent Fire Rated

81433-A-FR-PB

Edge90 Square Accent Fire Rated Trimless

81433-A-FR-PC

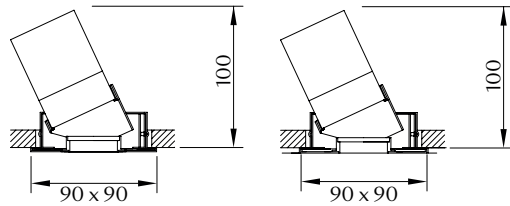

Edge90 Square Washlight

81433-WL-LED-PB

Edge90 Square Washlight Trimless

81433-WL-LED-PC

Edge90 Square Washlight Fire Rated

81433-WL-FR-PB

Edge90 Square Washlight Fire Rated Trimless

81433-WL-FR-PC

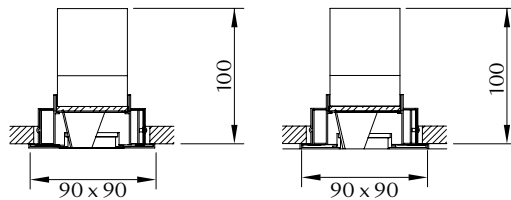





Duo

Monochrome downlights in white finish with fine black textured interior.

Fixed, accent and wallwash fixtures create this family of low reflectance and deep regressed architectural LED downlights.

Available for trimless installation for a completely seamless or with minimal overlap flange for existing ceilings.

Ball catch mechanism allows easy rotation and removal from the ceiling kit.

For all Lucent LED51 modules. Duo can also be supplied to accept MR16 and GU10 LED lamps.

All fixtures accept lenses and louvres to add effect.



Jaguar Land Rover Exhibition, Geneva
Imagination, London
Photography: Courtesy of JLR
Image Copyright: 2014 The Imagination Group LTD



Duo



Duo
31600-LED-PB
Duo Trimless
31600-LED-PC

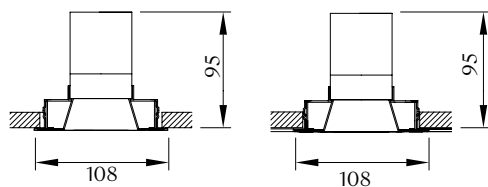

Duo Wallwash
31600-LED-WW-PB
Duo Wallwash Trimless
31600-LED-WW-PC

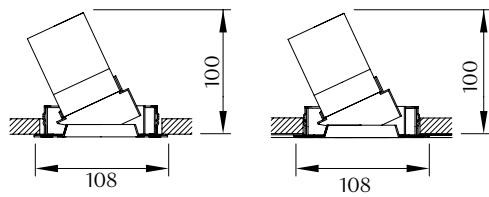
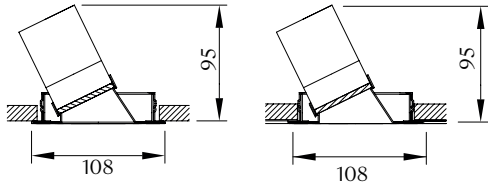

Duo Accent
31603-LED-PB
Duo Accent Trimless
31603-LED-PC



Flare

A deeply regressed downlight in 2 sizes with an inverted flare aperture giving visual comfort in the way the bezel disappears into the ceiling.

Flare90 in fixed and accent and Flare 55 with fixed, accent and wallwash versions.

Trimless installation for a seamless appearance or with overlap flange for plasterboard ceilings.

Flare90 is available as IP65 for bathroom and shower installations.

Flare90 also available with one hour fire rating to EN1365-2 and EN1363-1:60mins.

Ball catch mechanism allows easy rotation and removal from the ceiling kit.

Available in 2 finishes, white or black fine texture.

Flare55 for LED35 modules and Flare90 for the complete range of LED51 light modules.

Flare can also be ordered for MR16 and GU10 LED lamps.

Accept lenses and louvres to add effect and customize the visual appearance.



Flare55

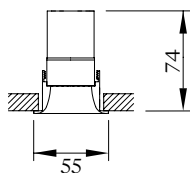

Flare55
550-FL-LED
Flare55 Trimless
550-FL-LED-TL



Flare55 Accent
553-FL-LED
Flare55 Accent Trimless
553-FL-LED-TL

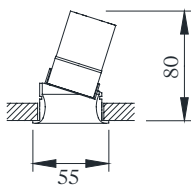

Matching surface downlights page 120

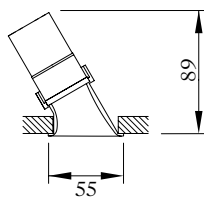

Flare55 Wallwash
550-FL-LED-WW
Flare55 Wallwash Trimless
550-FL-LED-WW-TL



Flare90 / IP65



Flare90
930-FL-LED-PB
930-FL-LED-PB-65
Flare90 Trimless
930-FL-LED-PC
930-FL-LED-PC-65

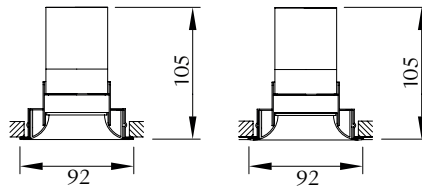

Flare90 Accent
933-FL-LED-PB
933-FL-LED-PB-65
Flare90 Accent Trimless
933-FL-LED-PC
933-FL-LED-PC-65

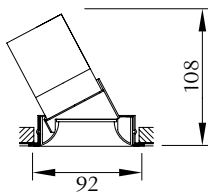
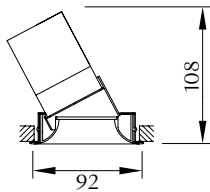



Soft



Soft appearance downlight fixtures in both fixed or accent variations and in three sizes in round or square available with trim or trimless options.

For installation into existing ceilings by means of an overlap flanged trim or with plaster in kit for a completely seamless trimless finish.

Soft50 for LED35 modules, Soft70 for LED51 modules and Soft90 for the LED71 modules.

Soft70 available as IP65 for bathroom and shower installations.

The Soft portfolio also now includes the SoftColour which consists of 6 different anodised reflector finishes to add a decorative colour option.

MR16 and GU10 LED lamps can also be installed into the Soft 70 downlights.

All fixtures accept lenses and louvres to add effect and customize the designed space.

Soft50

Soft50
050-LED-TR
Soft50 Trimless
050-LED-TL

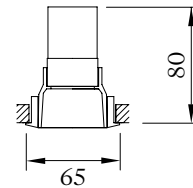
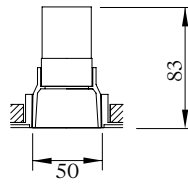

Soft50 Accent
053-LED-TR
Soft50 Accent Trimless
053-LED-TL

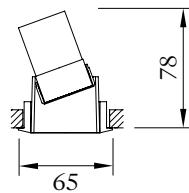
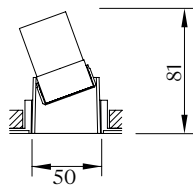



Eden Hotel, Rome
Metis Lighting, Milan

Soft70

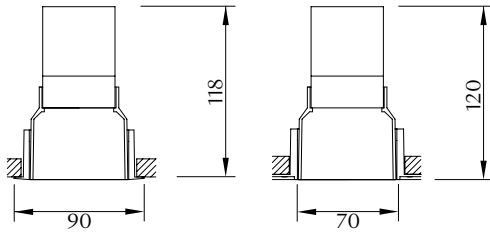

Soft70
070-LED-TR
Soft70 Trimless
070-LED-TL

Soft70 Accent
073-LED-TR
Soft70 Accent Trimless
073-LED-TL

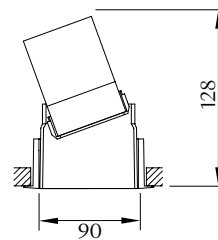
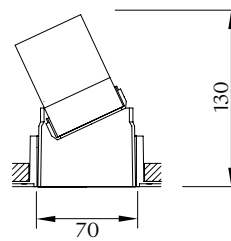



London Marriott Hotel County Hall
Elektra Lighting, London
Photography: Courtesy of London Marriott Hotel

Soft90



Soft90
090-LED-TR
Soft90 Trimless
090-LED-TL

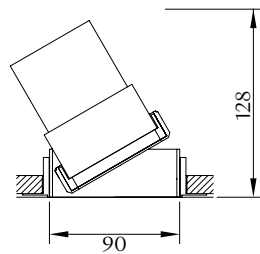
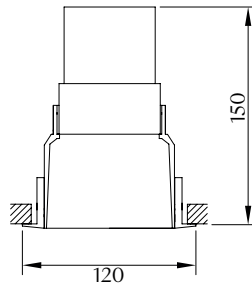
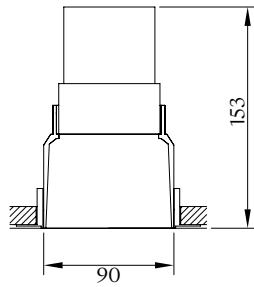

Soft90 Accent
093-LED-TR
Soft90 Accent Trimless
093-LED-TL

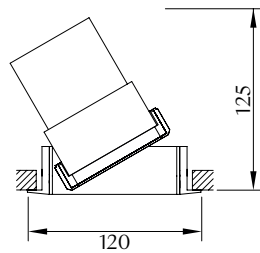



Van Cleef & Arpels at Katara Plaza, Doha
Voyons Voir Lighting Design Paris





SoftColour

For Soft 50,70 and 90 round fixtures

With a choice of 6 anodised finishes in Copper, Bronze, Polished Chrome, Satin Silver, Polished Gold, Satin Gold and Piano Black finish to add a decorative colour option to many types of interiors.

SoftColour must be ordered as a complete fixture. The coloured inserts are not sold separately.

Soft Colour



Polished Silver

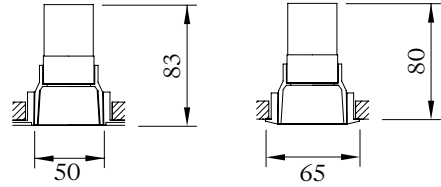

Soft50 Colour
050-C-LED-TR
Soft50 Colour Trimless
050-C-LED-TL



Satin Silver

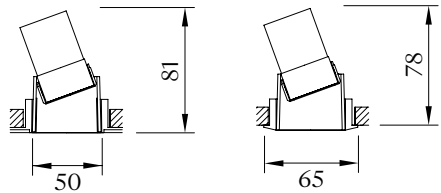

Soft50 Colour Accent
053-C-LED-TR
Soft50 Colour Accent Trimless
053-C-LED-TL



Polished Gold

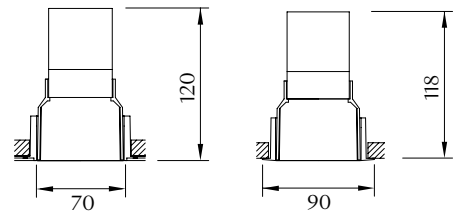

Soft70 Colour
070-C-LED-TR
Soft70 Colour Trimless
070-C-LED-TL





Copper

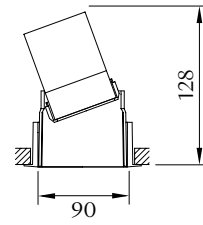
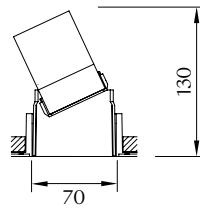

Soft70 Colour Accent
073-C-LED-TR
Soft70 Colour Accent Trimless
073-C-LED-TL



Piano Black

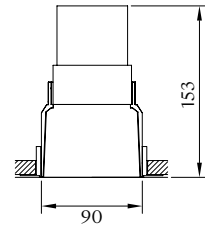
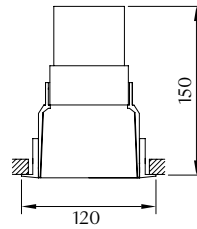

Soft90 Colour
090-C-LED-TR
Soft90 Colour Trimless
090-C-LED-TL



Satin Gold

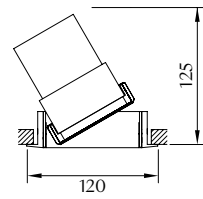
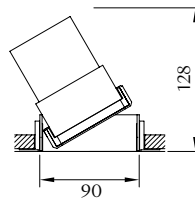

Soft90 Colour Accent
093-C-LED-TR
Soft90 Colour Accent Trimless
093-C-LED-TL



Soft50 Square



Soft50 Square
050-LED-TR-SQ
Soft50 Square Trimless
050-LED-TL-SQ

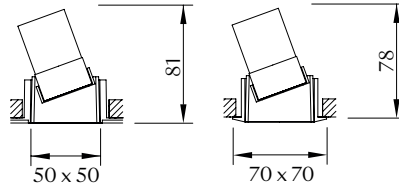
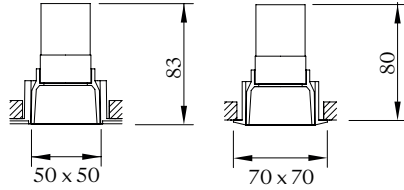

Soft50 Square Accent
053-LED-TR-SQ
Soft50 Square Accent Trimless
053-LED-TL-SQ



Soft70 Square

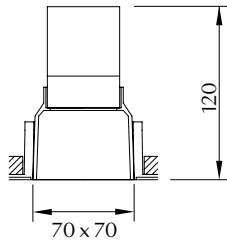
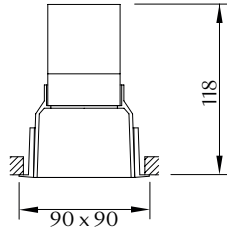

Soft70 Square
070-LED-TR-SQ
Soft70 Square Trimless
070-LED-TL-SQ



Soft70 Square Accent
073-LED-TR-SQ
Soft70 Square Accent Trimless
073-LED-TL-SQ

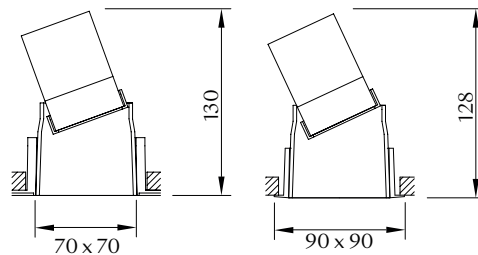



MiniTrim

Range of fully die cast one piece aluminium downlights in fixed, adjustable and wallwash versions in both round and square forms.

Designed with a minimal overlap flange giving the appearance of a trimless fixture when installed into a conventional ceiling.

Supplied in a fine textured white or black finish.

A one hour fire rated variant is available for all 3 model in both round and square to EN 1365-2 and EN1363-1:60 mins

Available for use with all Lucent LED51 modules.

MR16 and GU10 LED lamp versions can be ordered.

Fixtures accept 1 accessory.



JW Marriott Hotel, Pune, India
Light Source International, Hong Kong

MiniTrim / IP65



MiniTrim
860-LED
860-LED-65

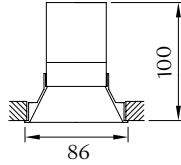

MiniTrim Fire Rated
860-FR

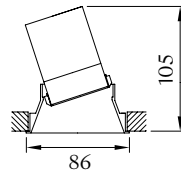

MiniTrim Accent
863-LED

MiniTrim Accent Fire Rated
863-FR



MiniTrim Wallwash
860-LED-WW
860-LED-WW-65

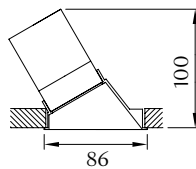

MiniTrim Wallwash Fire Rated
860-FR-WW



MiniTrim Square / IP65



MiniTrim Square
860-LED-SQ
860-LED-SQ-65

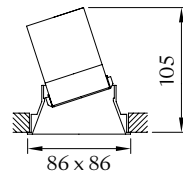
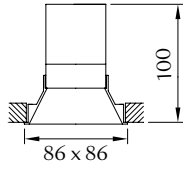

MiniTrim Square Accent
863-LED-SQ



MiniTrim Square Wallwash
860-LED-WW-SQ
860-LED-WW-SQ-65

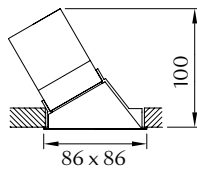

Focus

Low glare downlights with a black internal baffle for minimal glare and visual comfort.

Available in two sizes, Focus60 and Focus90 for all LED51 modules. In both fixed and adjustable versions.

Focus90 with magnetic fixing allowing easy rotation.

Focus60 and Focus90 both have complimentary IP54 and IP65 versions for use in bathroom and shower installations.

Focus 60 also available with one hour fire rating to EN 1365-2 and EN1363-1:60 mins.

The FocusMulti is available in single, twin and triple for either trim or trimless seamless installations.

All fixtures accept lenses and louvres.

MR16 and GU10 LED lamps versions can be ordered.





Focus60 / IP54 / IP65

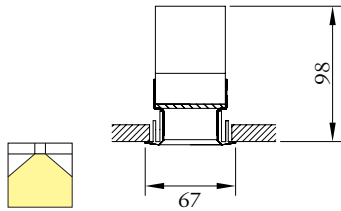

Focus60
060-LED
IP44 as standard

Focus60 Fire Rated
060-FR

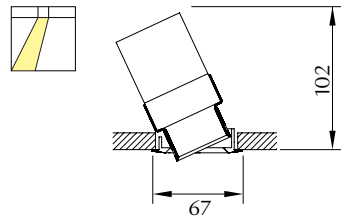

Focus60 Accent
063-LED

Focus60 Accent Fire Rated
063-FR

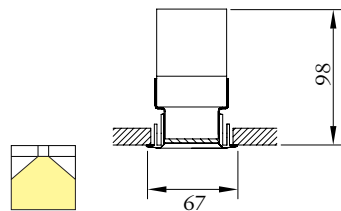

Focus60 IP54/65
060-LED-54
060-LED-65

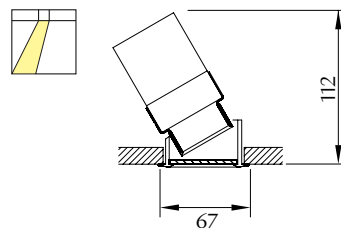

Focus60 Accent IP54/65
063-LED-54
063-LED-65



Private Boxes, Ascot Racecourse, Berkshire
SHH Architecture & Interior Design, London
Photography: Alistair Lever



Focus90



Focus90
090-LED

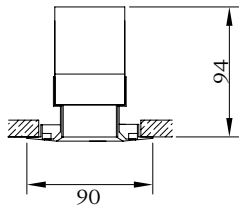

Focus90 Accent
093-LED

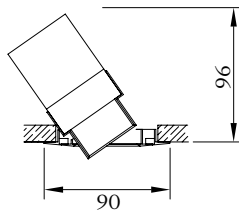



Edition Hotel, Barcelona
Isometrix Lighting + Design, London



Holland Park Villas, London
Nulty+ Lighting Design, London

Focus90 IP54 / IP65

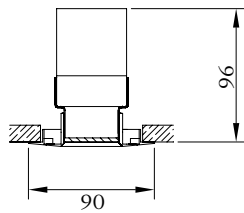

Focus90 IP54
090-LED-54

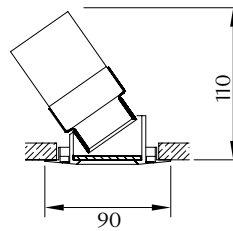

Focus90 Accent IP54
093-LED-54

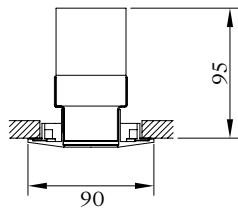

Focus90 IP65
090-LED-65

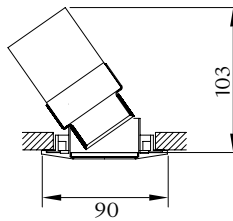

Focus90 Accent IP65
093-LED-65





Adare Manor Hotel, Co. Limerick, Ireland
Kate and Sam Lighting Designers, London





FocusMulti



FocusMulti Single
1063-LED-TR
FocusMulti Single Trimless
1063-LED-TL

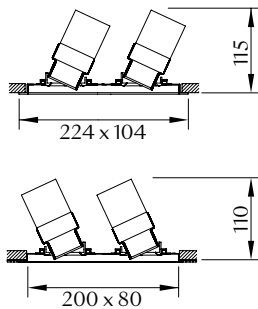
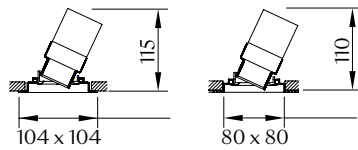

FocusMulti Twin
2063-LED-TR
FocusMulti Twin Trimless
2063-LED-TL

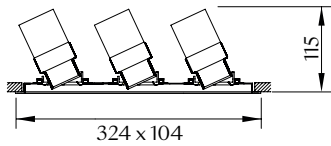
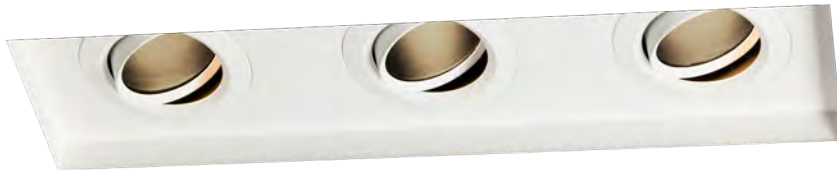

FocusMulti Triple
3063-LED-TR
FocusMulti Triple Trimless
3063-LED-TL

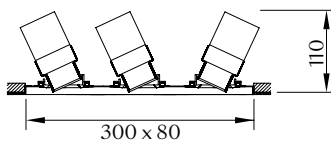



Holland Park Villas, London
Nulty+ Lighting Design, London
Photography: Mel Yates

ProSpex® Plus

Plus is a range of architectural round and square downlights in fixed, adjustable and wallwash variants accepting all LED modules. With all fixtures available in trim or trimless options.

Available in 3 sizes, Plus Mini and Plus for LED51 modules and the Plus XL for the higher output LED71 modules.

PlusMini available with conical trim only.

PlusMini version for IP65 and also available with one hour fire rating to EN 1365-2 and EN1363-1:60 mins

Plus available in round with Bevel, Edge and Conical trim versions

Plus Square with Pyramidal and Bevel trims.

PlusXL available in round with Conical and Bevel trims

PlusXL Square with Pyramidal and Bevel trims.

Plus Multi twin lamp fixture either as twin accent light or wallash in both trim and trimless versions.

The Plus, PlusXL and Plus Multi Accent all feature gear driven dual axis adjustment that allows hot aiming whilst the LED is on and remains fully locked in place during operation. Plus can also be supplied as a non-locking version.

PlusMini and Plus also accept MR16 and GU10 LED lamps and all fixtures accept lenses and louvres to add effect.



PlusMini Conical / IP65

PlusMini Conical
750+LED-TR
750+LED-TR-65
PlusMini Conical Trimless
750+LED-TL
750+LED-TL-65



PlusMini Conical Fire Rated
750+FR-TR
PlusMini Conical Fire Rated Trimless
750+FR-TL

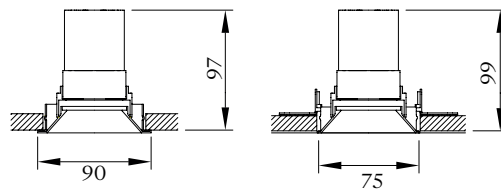



PlusMini Conical Accent

753+LED-TR
753+LED-TR-65

PlusMini Conical Accent Trimless

753+LED-TL
753+LED-TL-65



PlusMini Conical Accent Fire Rated

753+FR-TR

PlusMini Conical Accent Fire Rated Trimless

753+FR-TL

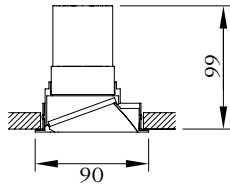
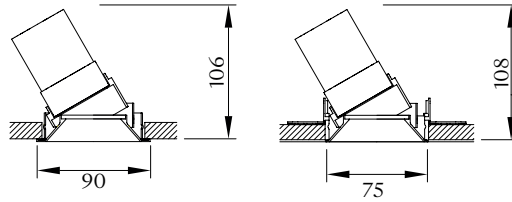

PlusMini Conical Wallwash

750+LED-TR-WW
750+LED-TR-WW-65

PlusMini Conical Wallwash Trimless

750+LED-TL-WW
750+LED-TL-WW-65

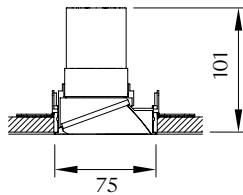

PlusMini Conical Fire Rated Wallwash

750+FR-TR-WW

PlusMini Conical Fire Rated Wallwash Trimless

750+FR-TL-WW



Plus Conical

Plus Conical
090+LED-TR
Plus Conical Trimless
090+LED-TL

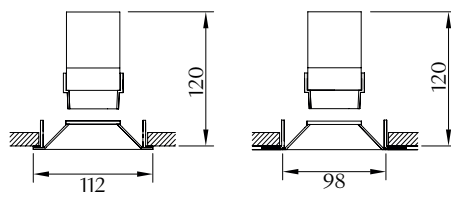



Plus Round Wallwash
090+LED-TR-WW
Plus Round Wallwash Trimless
090+LED-TL-WW

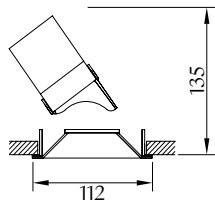
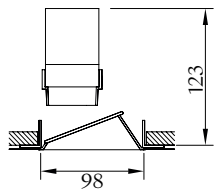
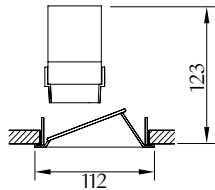

Plus Conical Accent
093+LED-TR
Plus Conical Accent Trimless
093+LED-TL

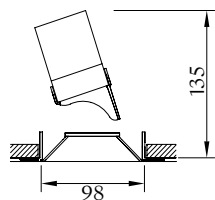

Plus Conical Accent Non-Locking
093+NL-LED-TR
Plus Conical Accent Trimless Non-Locking
093+NL-LED-TL

Plus Bevel

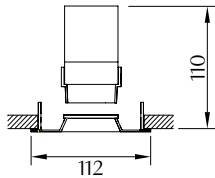
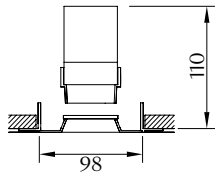

Plus Bevel Round
090+13-LED-TR
Plus Bevel Round Trimless
090+13-LED-TL

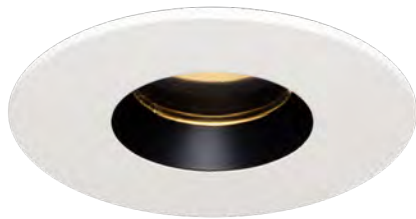

Plus Bevel Round Accent
093+13-LED-TR
Plus Bevel Round Accent Trimless
093+13-LED-TL

Plus Bevel Round Accent Non-Locking
093+13-NL-LED-TR
Plus Bevel Round Accent Trimless Non-Locking
093+13-NL-LED-TL

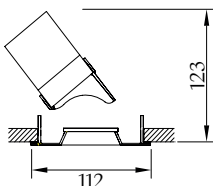
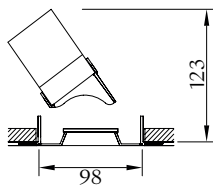

Plus Edge

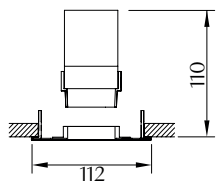
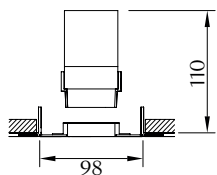

Plus Edge
090+113-LED-TR
Plus Edge Trimless
090+113-LED-TL



Plus Edge Accent Non-Locking
093+113-NL-LED-TR
Plus Edge Accent Trimless Non-Locking
093+113-NL-LED-TL

Plus Edge Accent
093+113-LED-TR
Plus Edge Accent Trimless
093+113-LED-TL

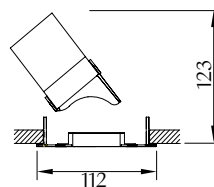
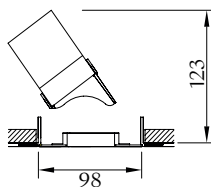

Plus Pyramidal

Plus Pyramidal
090+LED-TR-SQ
Plus Pyramidal Trimless
090+LED-TL-SQ

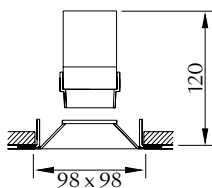
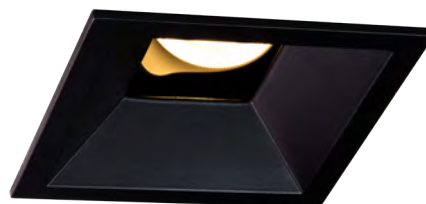
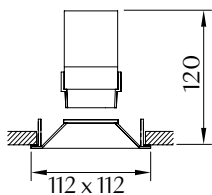

Plus Pyramidal Accent
093+LED-TR-SQ
Plus Pyramidal Accent Trimless
093+LED-TL-SQ

Plus Pyramidal Accent Non-Locking
093+NL-LED-TR-SQ
Plus Pyramidal Accent Trimless Non-Locking
093+NL-LED-TL-SQ

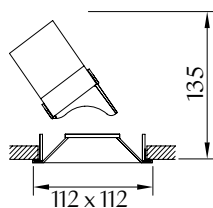
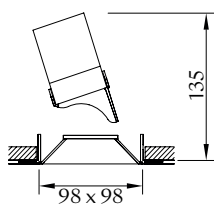

Plus Square Wallwash
090+LED-TR-WW-SQ
Plus Square Wallwash Trimless
090+LED-TL-WW-SQ

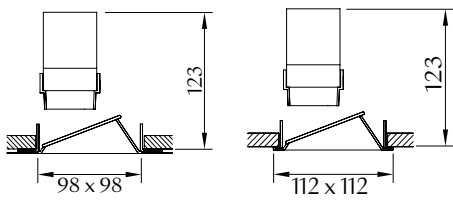

Plus Bevel Square

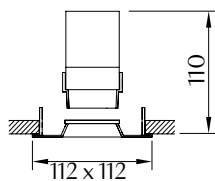
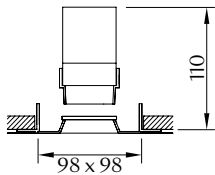

Plus Bevel Square
 090+33-LED-TR-SQ
Plus Bevel Square Trimless
 090+33-LED-TL-SQ

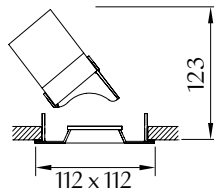
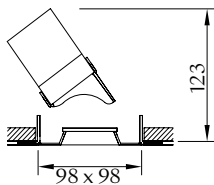
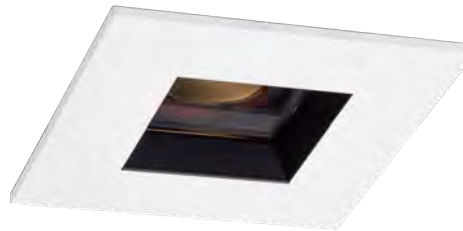

Plus Bevel Square Accent
 093+33-LED-TR-SQ
Plus Bevel Square Accent Trimless
 093+33-LED-TL-SQ

Plus Bevel Square Accent Non-Locking
 093+33-NL-LED-TR-SQ
Plus Bevel Square Accent Trimless Non-Locking
 093+33-NL-LED-TL-SQ



Hilton London Metropole Hotel
GIA Equation, London
Photography: Courtesy of The Hilton



Watches of Switzerland, Hudson Yard, New York
Lighting Workshop, New York
Photography: Peter Murdock



PlusXL Conical

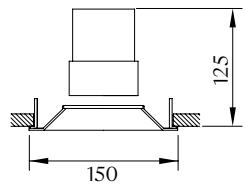
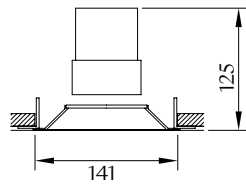

PlusXL Conical
090+XL-LED-TR
PlusXL Conical Trimless
090+XL-LED-TL

PlusXL Conical Accent
 093+XL-LED-TR
PlusXL Conical Accent Trimless
 093+XL-LED-TL

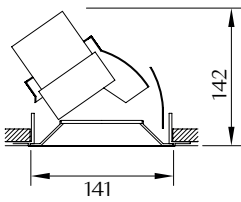
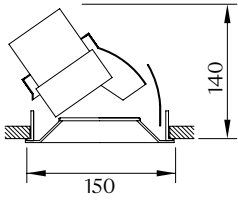

PlusXL Round Wallwash
 090+XL-LED-TR-WW
PlusXL Round Wallwash Trimless
 090+XL-LED-TL-WW

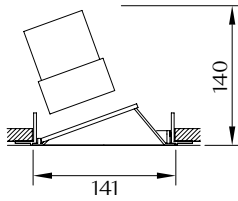
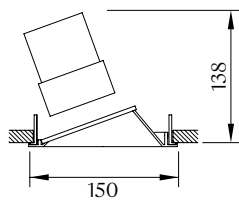

PlusXL Bevel Round

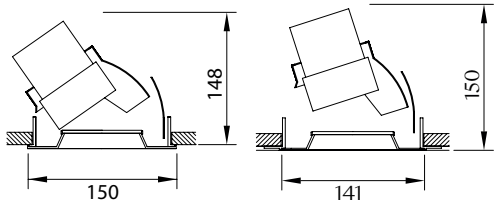

PlusXL Bevel
090+XL-13-LED-TR
PlusXL Bevel Trimless
090+XL-13-LED-TL

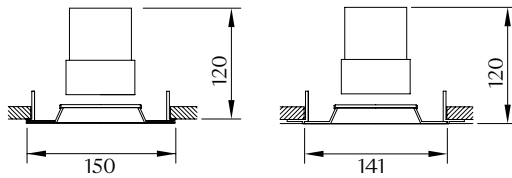

PlusXL Bevel Accent
093+XL-13-LED-TR
PlusXL Bevel Accent Trimless
093+XL-13-LED-TL





News Corp, London
Nulty+ Lighting Design, London
Photography: David Churchill

PlusXL Pyramidal

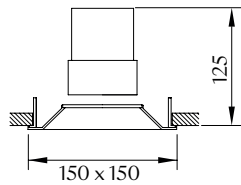
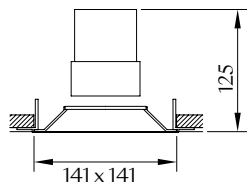

PlusXL Pyramidal
090+XL-LED-TR-SQ
PlusXL Pyramidal Trimless
090+XL-LED-TL-SQ

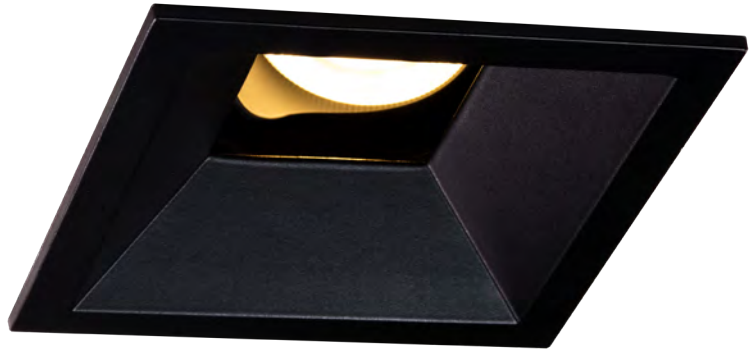
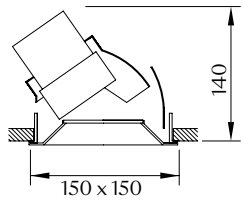
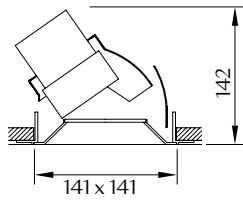

PlusXL Pyramidal Accent
 093+XL-LED-TR-SQ
PlusXL Pyramidal Accent Trimless
 093+XL-LED-TL-SQ

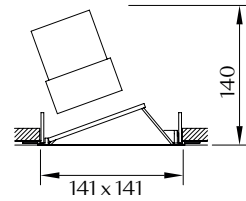
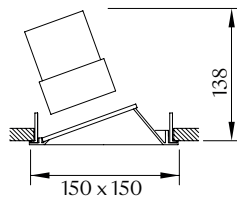

PlusXL Square Wallwash
 090+XL-LED-TR-WW-SQ
PlusXL Square Wallwash Trimless
 090+XL-LED-TL-WW-SQ

PlusXL Bevel Square

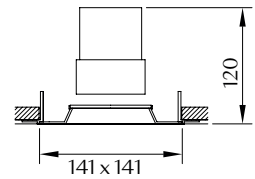
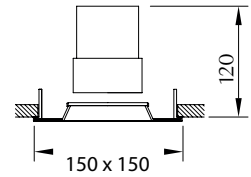

PlusXL Bevel Square
090+XL-33-LED-TR-SQ
PlusXL Bevel Square Trimless
090+XL-33-LED-TL-SQ

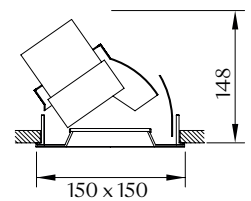
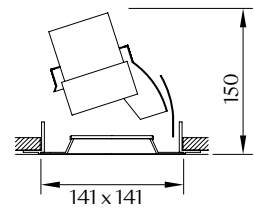
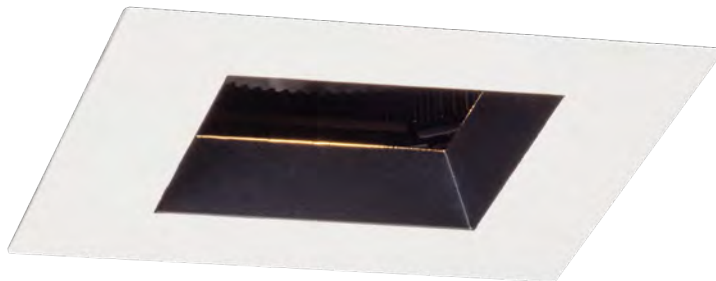

PlusXL Bevel Square Accent
093+XL-33-LED-TR-SQ
PlusXL Bevel Square Accent Trimless
093+XL-33-LED-TL-SQ



Peter Street Kitchen, Manchester
Lighting Design International, London
Photography: Andrew Beasley



PlusMulti

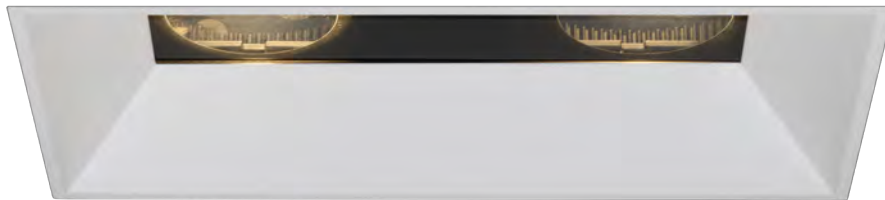

PlusMulti
293+LED-TR
PlusMulti Trimless
293+LED-TL

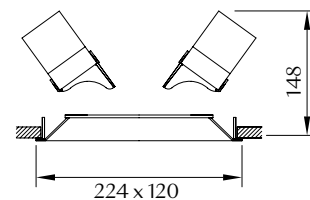
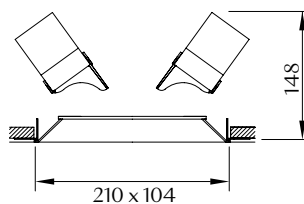

PlusMulti Wallwash
293+LED-TR-WW
PlusMulti Wallwash Trimless
293+LED-TL-WW

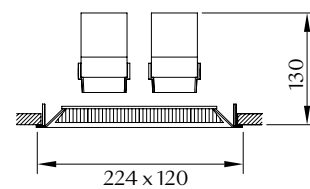
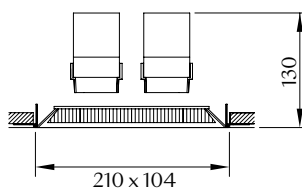



Carolina Herrera, Rodeo Drive, Beverly Hills
Sean O'Connor Lighting, Los Angeles



ProSpex[®] PlusColour Bevel

PlusColour is a decorative addition to the PlusBevel range of downlights in both round and square models with a choice of 5 anodised bevel finishes in Copper, Bronze, Polished Chrome, Satin Nickel and Satin Gold Finish.

PlusColour needs to be ordered as a complete fixture and is available in both the locking and non locking versions.

For use with all LED51 modules or MR16 and GU10 LED lamps.

All fixtures available in trim or trimless options and all fixtures accept lenses and louvres to add effect.



PlusColour Bevel

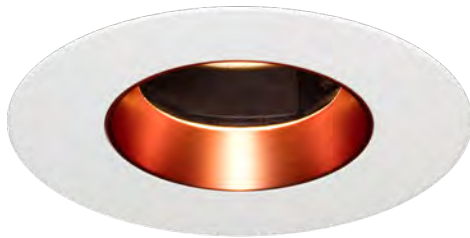

Copper

PlusColour Bevel
090+13-C-LED-TR-CP
PlusColour Bevel Trimless
090+13-C-LED-TL-CP

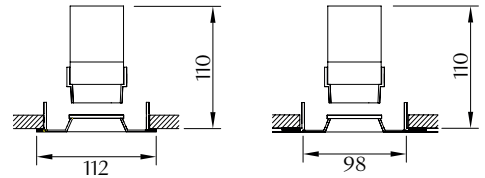

Polished Chrome

PlusColour Bevel Accent
093+13-C-LED-TR-CH
PlusColour Bevel Accent Trimless
093+13-C-LED-TL-CH

PlusColour Bevel Accent Non-Locking
093+13-NL-C-LED-TR-BZ
PlusColour Bevel Accent Trimless Non-Locking
093+13-NL-C-LED-TL-BZ

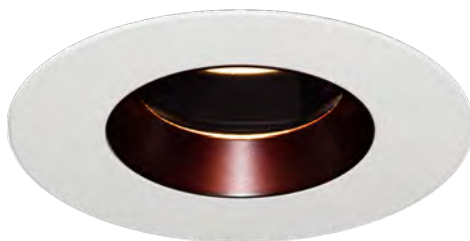
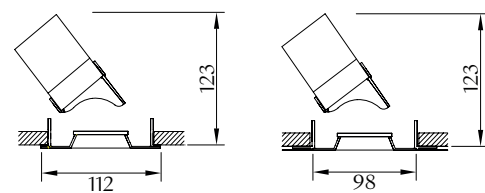

Bronze



Satin Gold

PlusColour Bevel
090+13-C-LED-TR-SG
PlusColour Bevel Trimless
090+13-C-LED-TL-SG

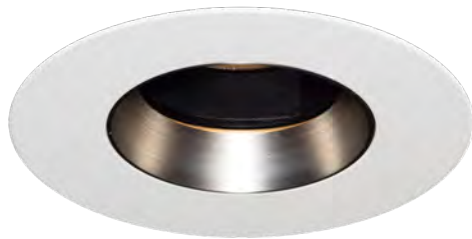
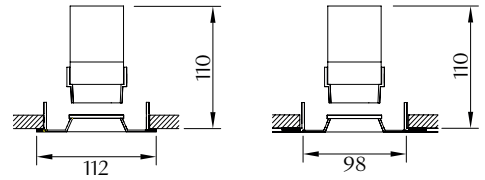

Satin Nickel

PlusColour Bevel Accent
093+13-C-LED-TR-SN
PlusColour Bevel Accent Trimless
093+13-C-LED-TL-SN

PlusColour Bevel Accent Non-Locking
093+13-NL-C-LED-TR-SN
PlusColour Bevel Accent Trimless Non-Locking
093+13-NL-C-LED-TL-SN

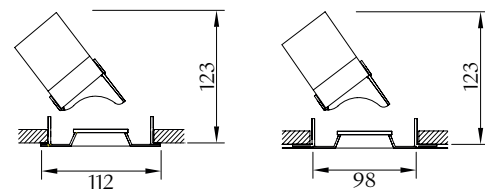

PlusColour Bevel Square

PlusColour Bevel Square

090+33-C-LED-TR-SQ-CH

PlusColour Bevel Square Trimless

090+33-C-LED-TL-SQ-CH



Polished Chrome

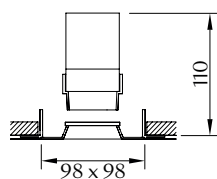
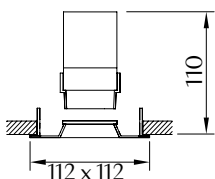

PlusColour Bevel Square Accent

093+33-C-LED-TR-SQ-SG

PlusColour Bevel Square Accent Trimless

093+33-C-LED-TL-SQ-SG



Satin Gold

PlusColour Bevel Square Accent Non-Locking

093+33-NL-C-LED-TR-SQ-BZ

PlusColour Bevel Square Accent Trimless Non-Locking

093+33-NL-C-LED-TL-SQ-BZ

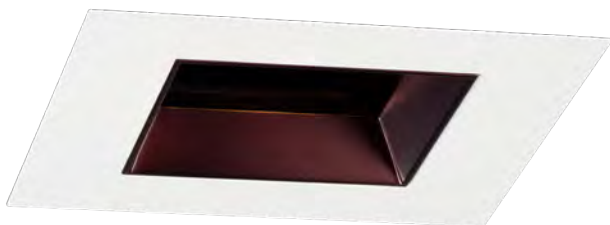

Bronze

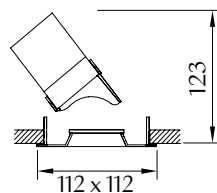
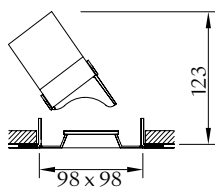

PlusColour Bevel Square
 090+33-C-LED-TR-SQ-SN
PlusColour Bevel Square Trimless
 090+33-C-LED-TL-SQ-SN

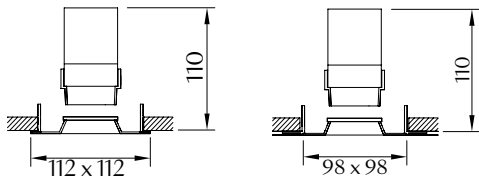

Satin Nickel

PlusColour Bevel Square Accent
 093+33-C-LED-TR-SQ-CP
PlusColour Bevel Square Accent Trimless
 093+33-C-LED-TL-SQ-CP

PlusColour Bevel Square Accent Non-Locking
 093+33-NL-C-LED-TR-SQ-CP
PlusColour Bevel Square Accent Trimless Non-Locking
 093+33-NL-C-LED-TL-SQ-CP

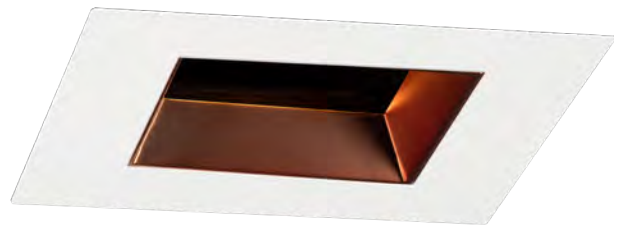
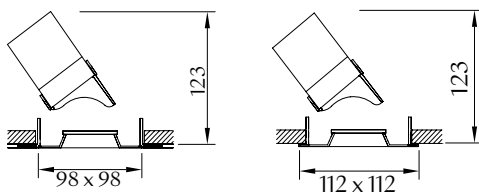

Copper





Guerlain, Paris
Voyons Voir Lighting Design, Paris



Perf House, London
Pinto Lighting Design, Brighton



Private Residence, Uruguay
George Sexton Associates, Norwich
Kallosturin Architects



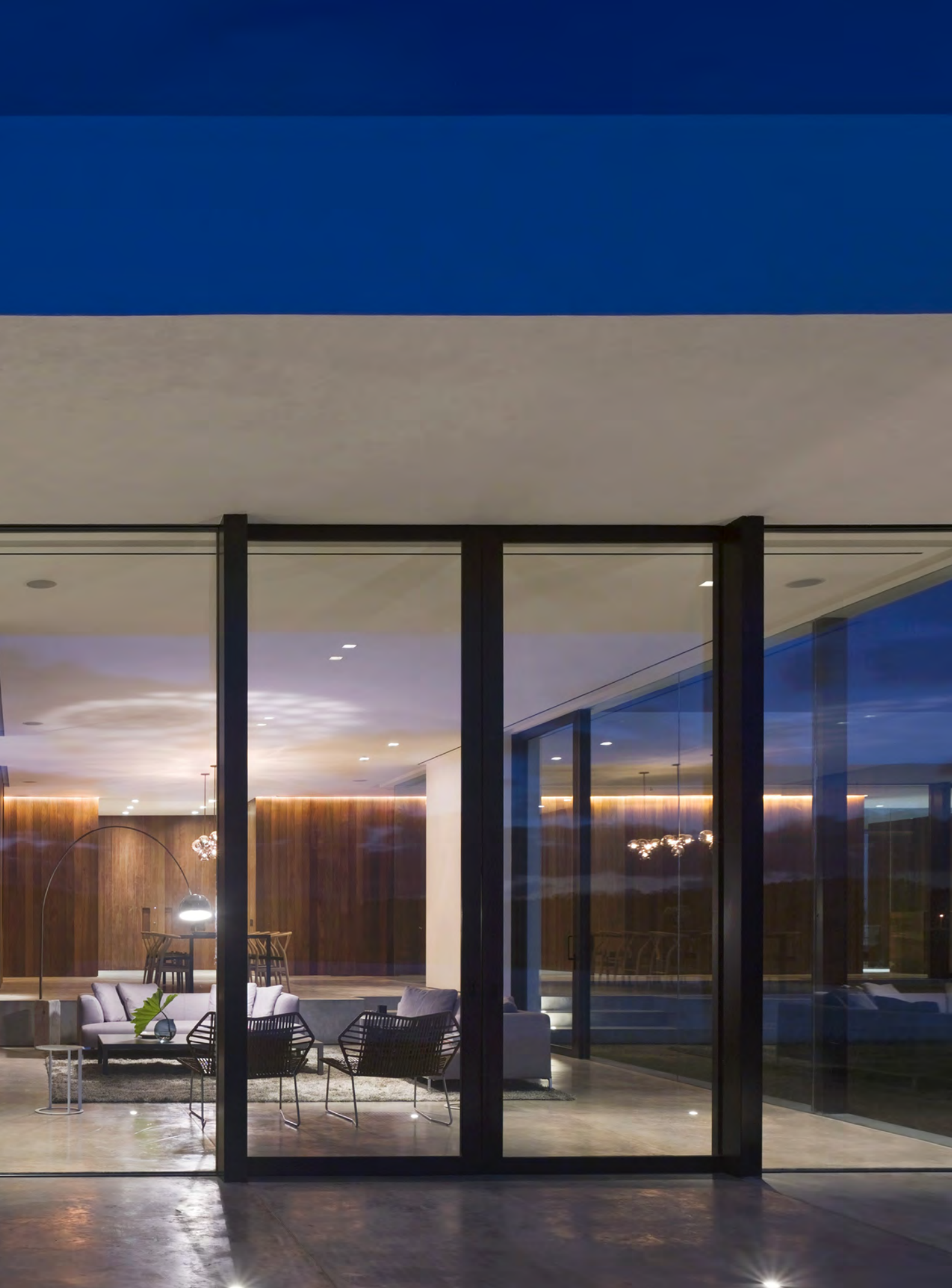

Axis

A range of fully recessed single adjustable gimbal luminaires in 3 sizes Micro, Mini and Midi.

Full adjustment with 359° rotation and angle adjustment to 35° with a minimal trim or a trimless kit giving a seamless appearance.

Axis can be used with trimless multi kits with up to 3 fixtures in one housing ensuring equal spacing and a smooth seamless appearance.

Axis Micro for LED35, Mini for LED51 and Midi for LED71 modules.

MR16 and GU10 LED lamp versions available.

Mini and Midi supplied with a tapered snoot as standard or with a long straight snoot as an option and all accept a range of louvres and lenses.

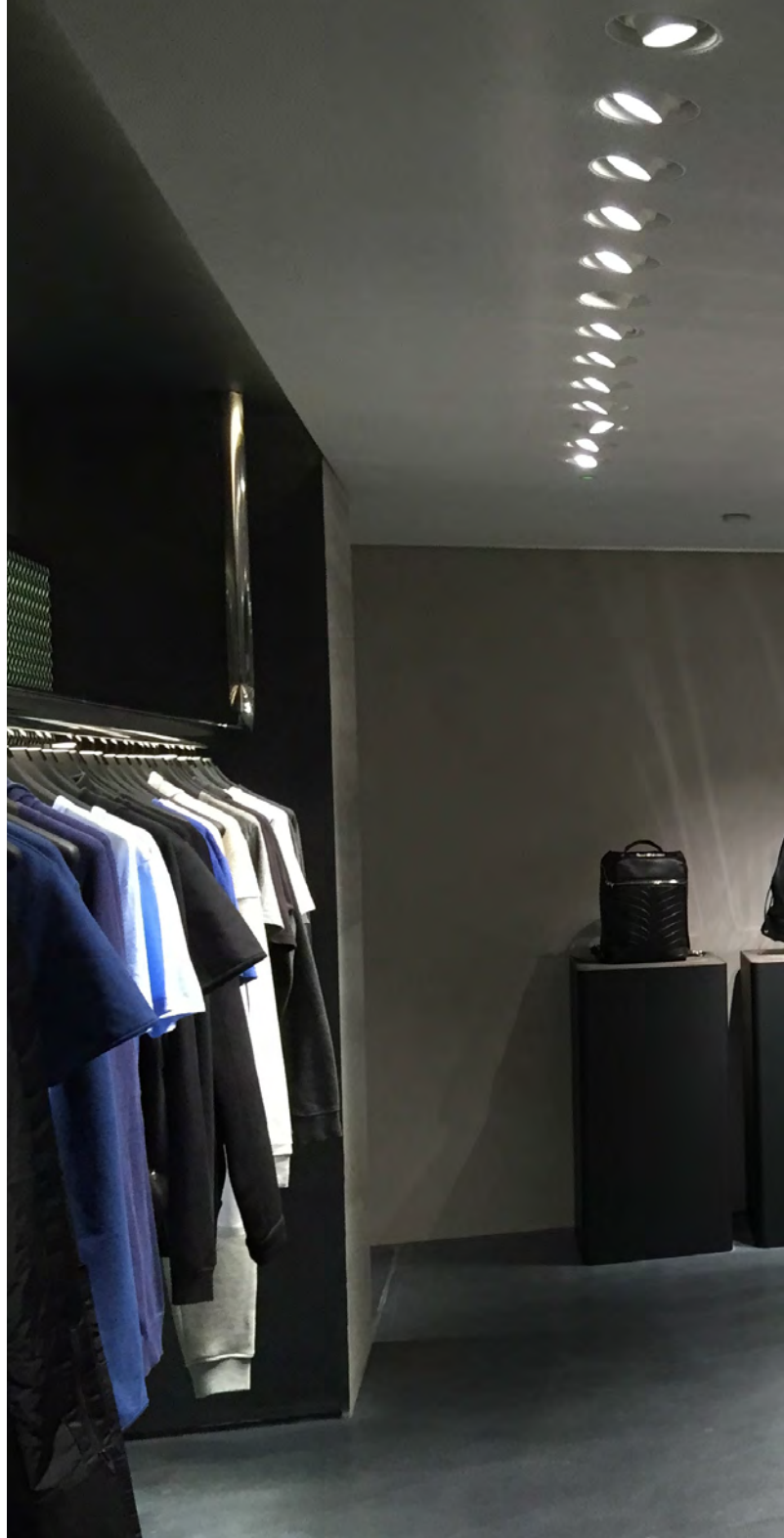



Alexander Wang Flagship Store, London
Metis Lighting, Milan

Axis Micro

Axis Micro Trimless
135-LED-TL

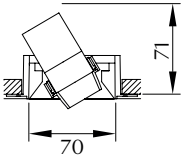

Axis Micro
135-LED-TR

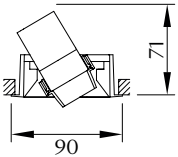

Axis Mini



Axis Mini 2
200/2-LED-TR
Axis Mini 2 Trimless
200/2-LED-TL

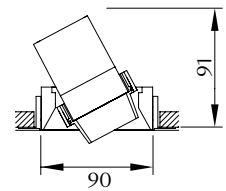
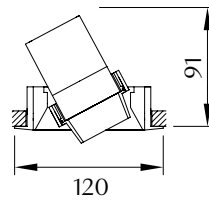

Axis Mini 2 Long Snoot
200/2-LS-LED-TR
Axis Mini 2 Trimless Long Snoot
200/2-LS-LED-TL

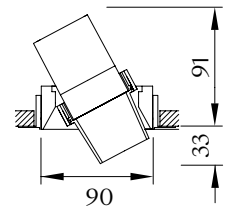
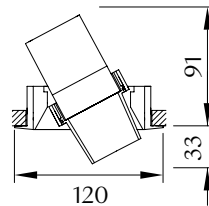

Axis Midi



Axis Midi 2
300/2-LED-TR
Axis Midi 2 Trimless
300/2-LED-TL

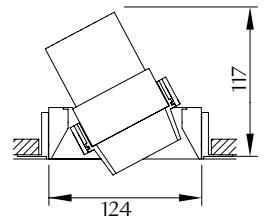
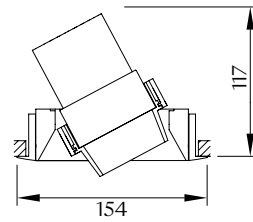

Axis Midi 2 Long Snoot
300/2-LS-LED-TR
Axis Midi 2 Trimless Long Snoot
300/2-LS-LED-TL

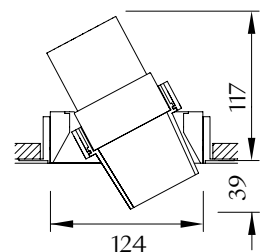
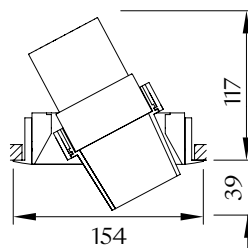



L'Occitane Flagship Store, London
Nulty+ Lighting Design, London
Photography: Michael Franke

Axis Multiple



2135-TL
Twin Trimless Kit for Axis Micro

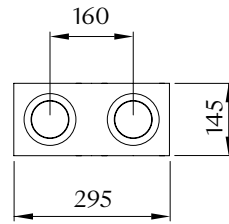

2200/2-TL
Twin Trimless Kit for Axis Mini

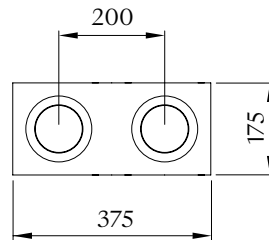

2300/2-TL
Twin Trimless Kit for Axis Midi

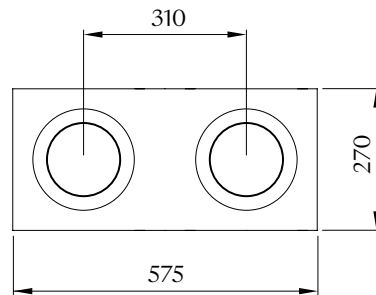



3135-TL
Triple Trimless Kit for Axis Micro

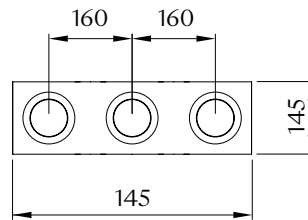

3200/2-TL
Triple Trimless Kit for Axis Mini

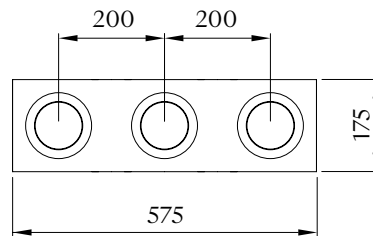

3300/2-TL
Triple Trimless Kit for Axis Midi

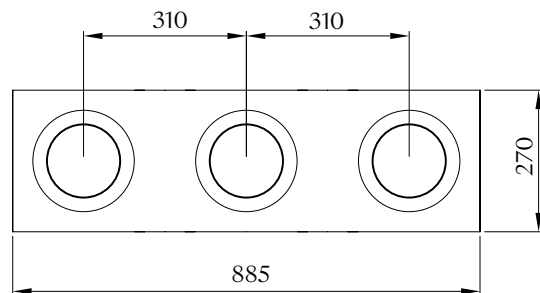



Robinsons, Dubai
dpa lighting consultants
Photography: Courtesy of Robinsons







ProSpex[®] Performance

Tool lockable rotation mechanism



Tool lockable graduated adjustment to 35°



The New ProSpex Performance range of high output specification grade reflector downlight fixtures available in 4 sizes - 105, 140, 160 and 195mm diameters.

Powerful high lumen outputs are delivered from all the models with up to 8200 lumens from the 195 fixture.

Applications include high level spaces, shopping centres and commercial interiors and retail spaces where high levels of quality lighting are required.

The accent models in all the sizes incorporate tool lockable graduated adjustment to 35° providing hot aiming whilst the LED is powered on and full 358° tool lockable rotation mechanism thereby ensuring the fixture after focusing remains fully locked in use.

All fixtures feature low glare 40° visual cut off and are delivered with semi-specular silver reflector. Other finishes in Champagne Gold, Perma White and Matt Black are available to special order.

All sizes accept louvres and accessories.

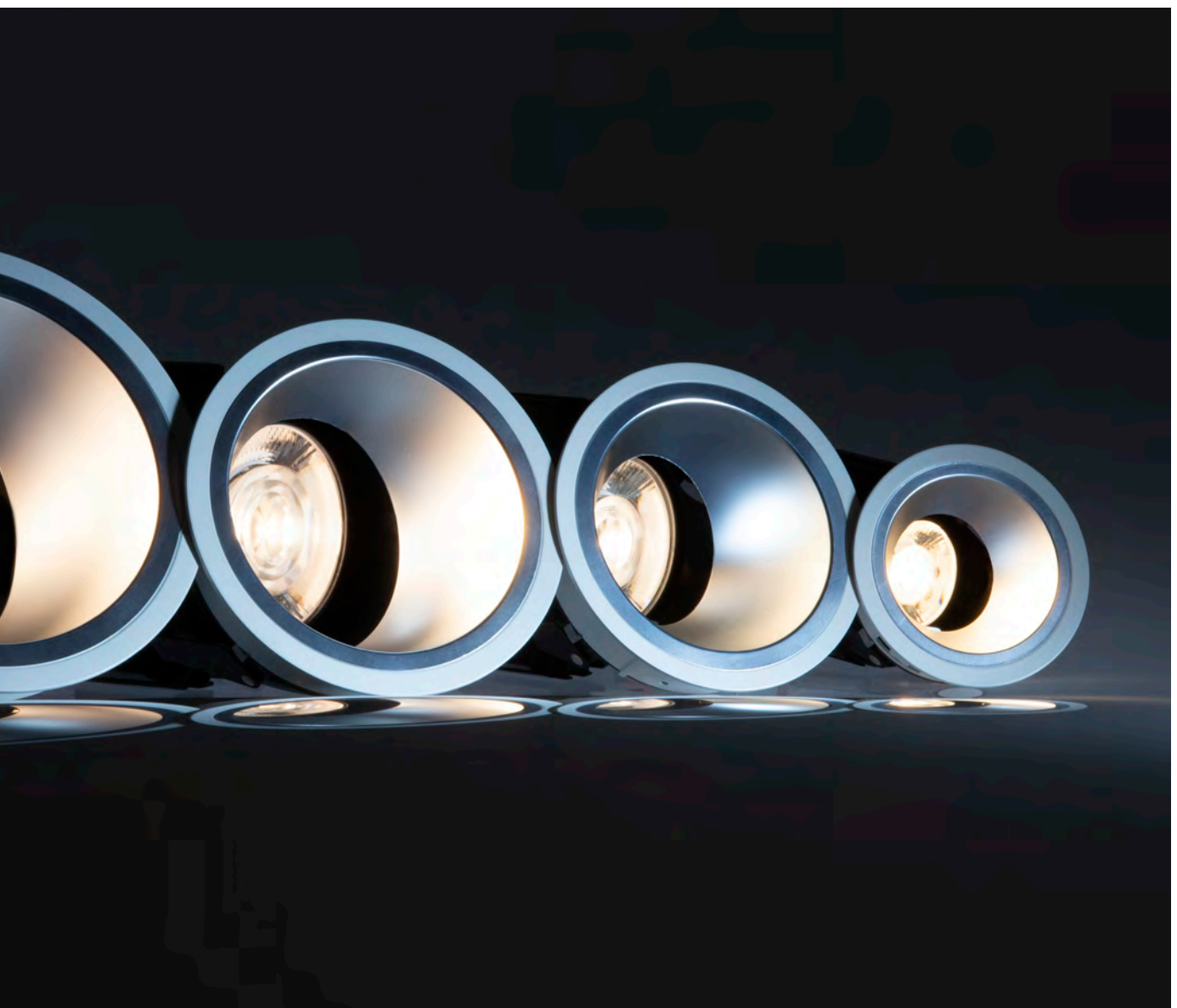

ProSpex[®] Performance105

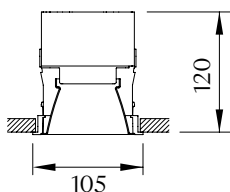

ProSpex Performance105
PP1050
29w / 2300lm
18°, 24°, 30°, 52°

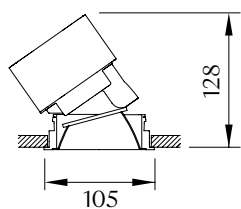

ProSpex Performance105 Accent
PP1053
29w / 1800lm
18°, 24°, 30°, 52°

Max Delivered Lumen Output at 3000K, Medium Beam angle

ProSpex[®] Performance140

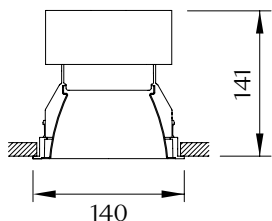

ProSpex Performance140
PP1400
48w / 4400lm
19°, 27°, 35°, 53°



ProSpex Performance140 Accent
PP1403
48w / 3900lm
19°, 27°, 35°, 53°

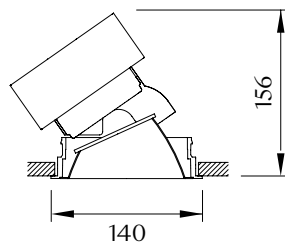

ProSpex[®] Performance160

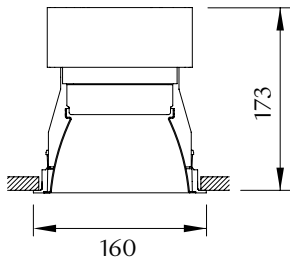

ProSpex Performance160
PP1600
74.7w / 6000lm
17°, 25°, 34°, 55°

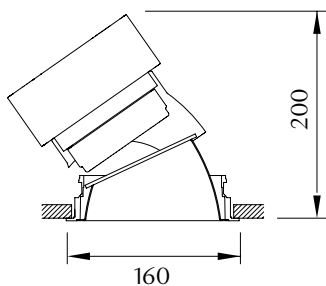

ProSpex Performance160 Accent
PP1603
74.7w / 5700lm
17°, 25°, 34°, 55°

Max Delivered Lumen Output at 3000K, Medium Beam angle

ProSpex[®] Performance195

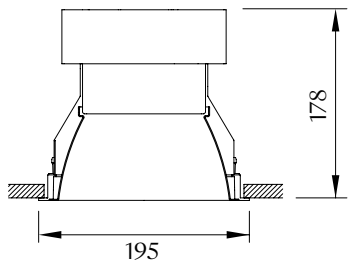

ProSpex Performance195
PP1950
93.6w / 8200lm
18°, 24°, 33°, 52°

ProSpex Performance195 Accent
PP1953
93.6w / 7800lm
18°, 24°, 33°, 52°

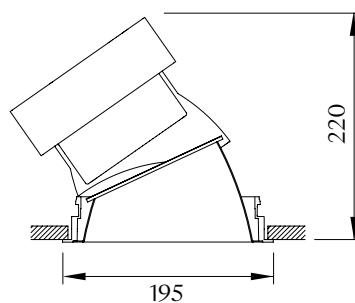

ProSpex[®] Reflector Series



Lockable tilt



358° lockable rotation



Four Seasons Hotel, Bahrain Bay
Lang Lighting Design Inc, Dallas



Professional specification (ProSpex) grade reflector downlights in 2 sizes, 100, 140. Both sizes have fixed, adjustable and wallwash versions. Accent fixtures incorporate tool lockable tilt to 35° and 359° rotation allowing hot aiming whilst the LED is powered and remain fully locked in focus during use.

All fixtures feature low glare 40° visual cut off and are available with darklight polished silver or satin silver aluminium reflectors. Other finishes available to special order.

ProSpex 100 is available trim or trimless and for use with all of Lucent's LED51 modules or MR16 LED and GU10 LED lamps and other proprietary LED options to special order.

ProSpex140 for use with all of Lucent 's LED71 modules and is also available for other higher output proprietary LED options to order.

Both sizes accept louvres and accessories.



ProSpex[®] 100

Polished Silver

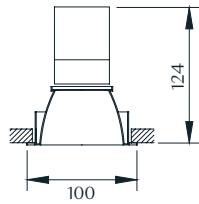

**ProSpex100
100-LED**

Satin Silver

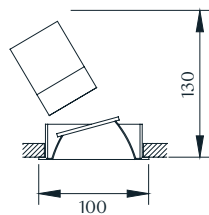

**ProSpex100 Accent
103-LED**

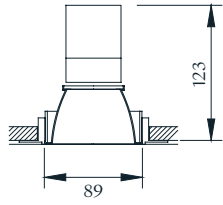

ProSpex100 Trimless
100-LED-TL

Polished Silver



Satin Silver



ProSpex100 Accent Trimless
103-LED-TL

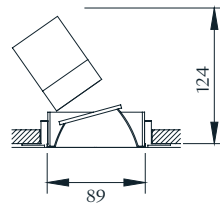

ProSpex100 Wallwash
100-LED-WW



Satin Silver

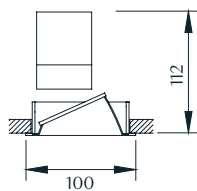

ProSpex[®] 140

Satin Silver

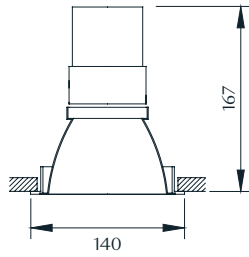

ProSpex140
140-LED



Polished Silver

ProSpex140 Accent
143-LED

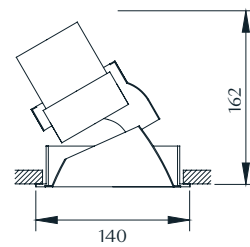

Satin Silver

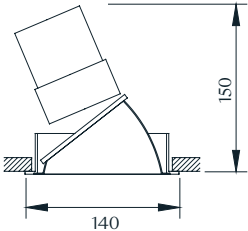
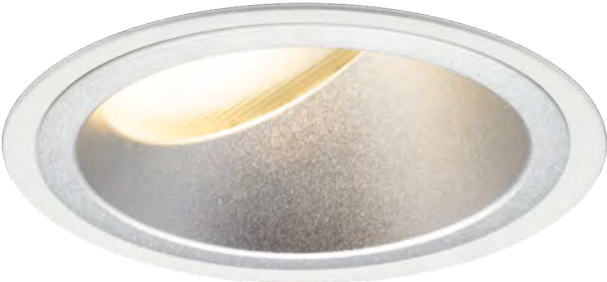

ProSpex140 Wallwash
140-LED-WW



Andaz Hotel, London
Foundry, London
Ara Design, London
Photography: James Newton







VINCE.

Vince, Mall of Emirates, Dubai
Lighting Workshop New York



Gimbal

A comprehensive range of fully adjustable and recessed single, twin or triple gimbal fixtures available in 3 sizes.

Micro for LED35 modules, Mini for all LED51 modules or MR16 and GU10 LED lamps and the Midi for the LED71 modules.

Available with a minimal trim for existing ceiling installations or with plaster kit for trimless seamless appearance in new plastered ceilings.

Supplied as standard with low glare tapered snoots.

All Gimbal luminaires accept a range of louvres and lenses.

Gimbal Micro

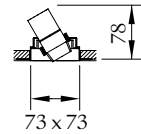
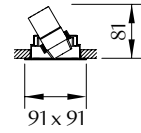

Gimbal Micro Single
351-LED-TR
Gimbal Micro Single Trimless
351-LED-TL

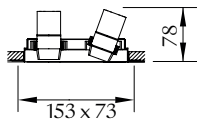
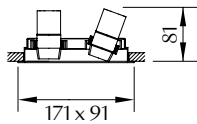

Gimbal Micro Twin
352-LED-TR
Gimbal Micro Twin Trimless
352-LED-TL





Gimbal Micro Triple
353-LED-TR
Gimbal Micro Triple Trimless
353-LED-TL

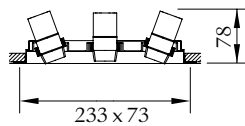
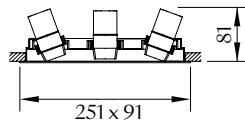

Gimbal Mini

Gimbal Mini Single
116/2-LED-TR
Gimbal Mini Single Trimless
116/2-LED-TL

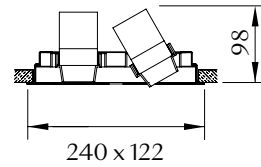
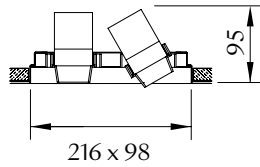
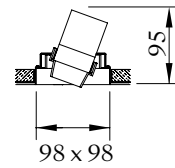
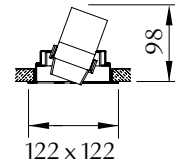

Gimbal Mini Twin
216/2-LED-TR
Gimbal Mini Twin Trimless
216/2-LED-TL

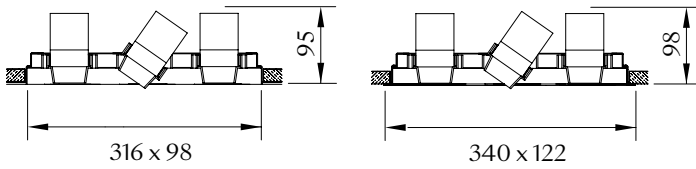

Gimbal Mini Triple
316/2-LED-TR
Gimbal Mini Triple Trimless
316/2-LED-TL



Gimbal Midi



Gimbal Midi Single
120/2-LED-TR
Gimbal Midi Single Trimless
120/2-LED-TL

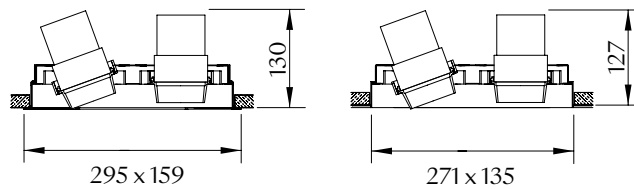
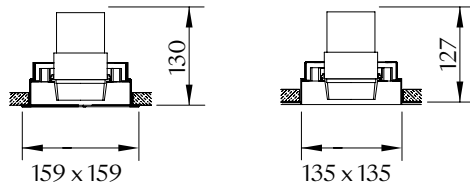

Gimbal Midi Twin
220/2-LED-TR
Gimbal Midi Twin Trimless
220/2-LED-TL



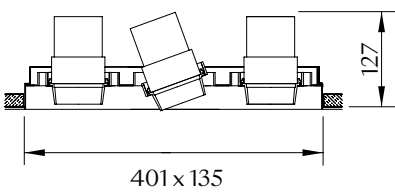
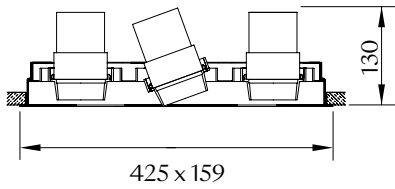

Gimbal Midi Triple
320/2-LED-TR
Gimbal Midi Triple Trimless
320/2-LED-TL

Hospitality





Great Scotland Yard Hotel, London
Illuminate Lighting Design, Singapore
Anthony Parkinson Photography provided by Great Scotland Yard Hotel

Hospitality





Hilton Hotel, Belfast, Northern Ireland
Susan Lake Lighting Design, Lewes
Photography: Gavriil Papadiotis (www.gavriilux.com)

Hospitality



London Marriott Hotel, Park Lane
Elektra Lighting London
Photography: Courtesy of London Marriott Hotel



Hospitality

The Mandrake, London
dpa lighting consultants
Photography: Courtesy of The Mandrake Hotel





Hospitality





Mondrian Hotel at Sea Containers House, London
Isometrix Lighting + Design London

Hospitality



Ritz Carlton Hotel, Pune, India
dpa lighting consultants

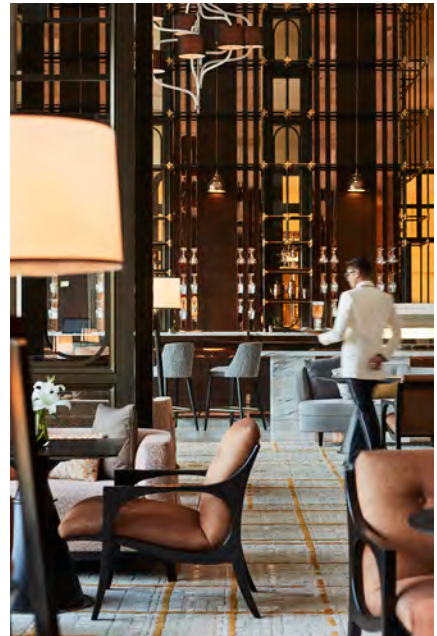

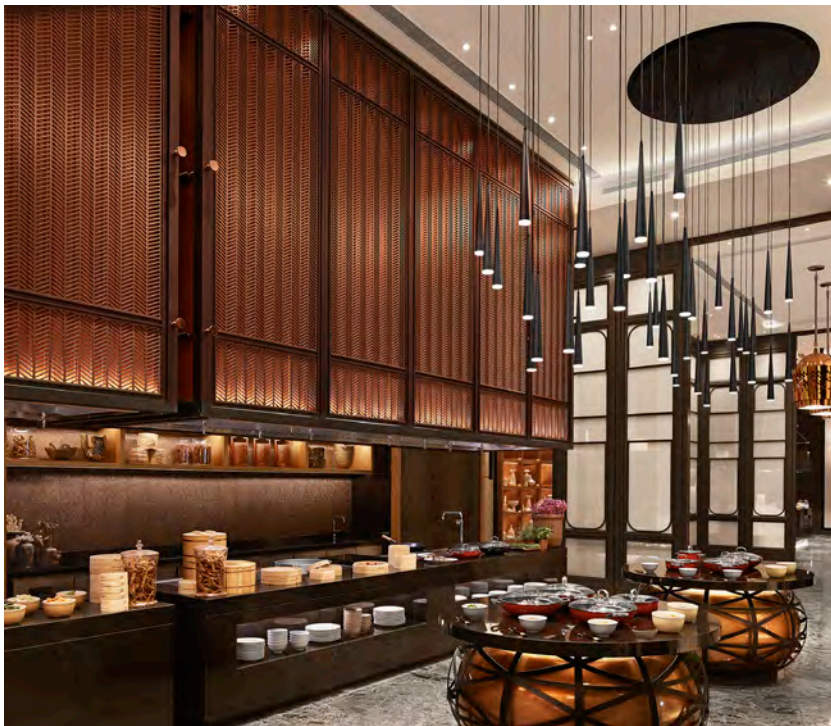

Hospitality

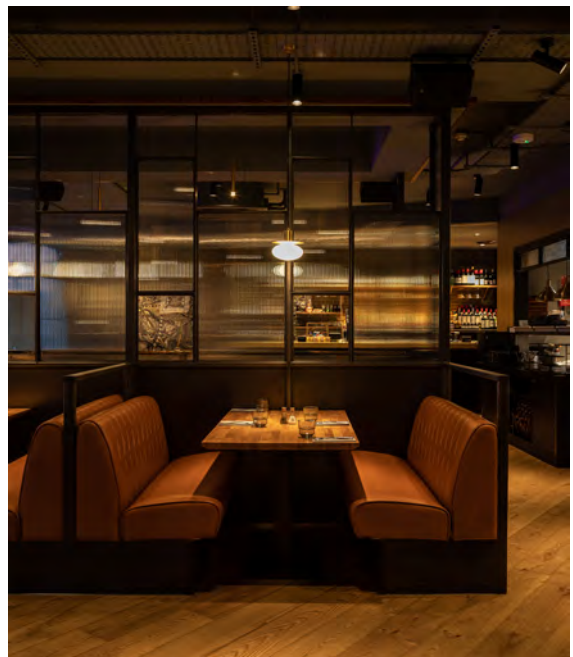



The Alchemist, Gun Wharf Quays, Portsmouth
Foundry, London
Architect: MacAulay Sinclair, Nottingham
Photography: James Newton (@James Newton)

Hospitality





The Langley Hotel, Buckinghamshire
dpa lighting consultants
Interior Design: Dennis Irvine Studio
Photography: James Blaston

Hospitality





The Edwardian Manchester
Lighting Design International, London
Photography: Andrew Beasley

Hospitality



Four Seasons, Casablanca
dpa lighting consultants



Hospitality





Edwardian Radisson, Bloomsbury, London
Lighting Design International, London
Photography: Andrew Beasley

Residential

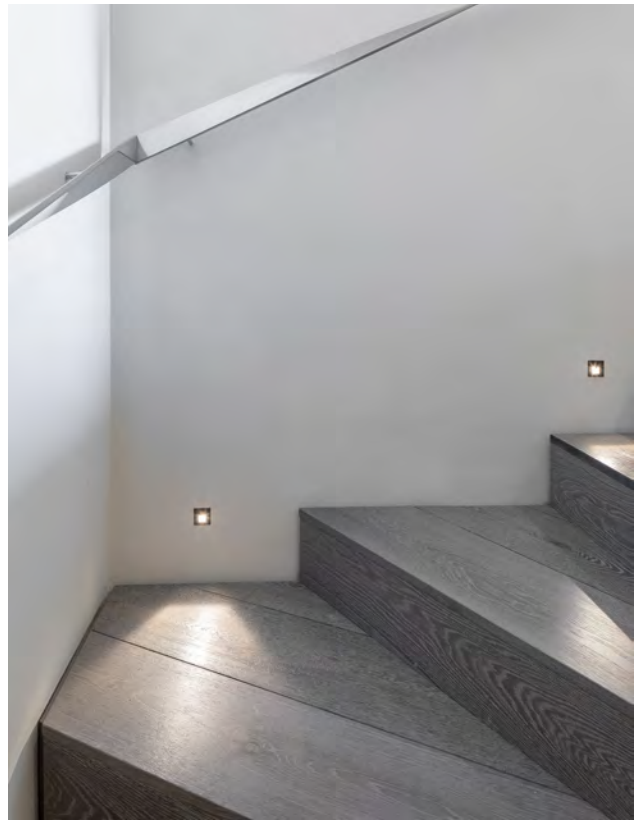



Residential



Gehry Residence, Santa Monica
L'Observatoire International New York
Photography: Iwan Baan





Residential



Private Residence, London
The Lighting Asylum London



Residential





Villa, Cap d'Antibes, France
George Sexton Associates, Norwich
Photography: Richard Powers

Residential





Private Residence, Oxfordshire
dpa lighting consultants
Photography: Matt Livey

Residential

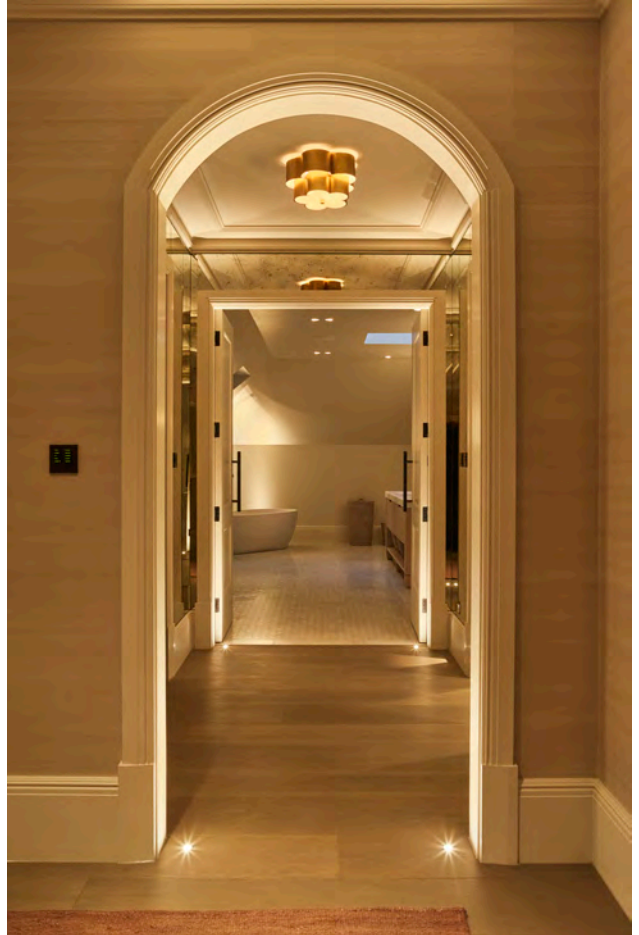

The Grange Residence, London
The Lighting Asylum, London
Photography: Andrewgough Photo



Residential



Long & Waterson Apartments, London
Seam Design, London
Architect: ODA-Architecture & Fletcher Priest Architects
Developer: Tzaki Group Investments



Leisure



Tivoli Cinema, Bath
Elektra Lighting London



Leisure





Hippodrome Casino, London
Into Lighting London
Photography: Emphasis

Leisure



Cathay Pacific First Class Lounge Hong Kong
Firefly PointOfView Hong Kong



Retail



Polo Ralph Lauren, Dubai Mall
Schwinghammer Lighting, New York
3D Chalhoub Group



Retail



Watches of Switzerland, Soho New York
Lighting Workshop, New York
Photography: Peter Murdock



Retail





Michael Kors, London
Cooley Monato Studio New York

Retail



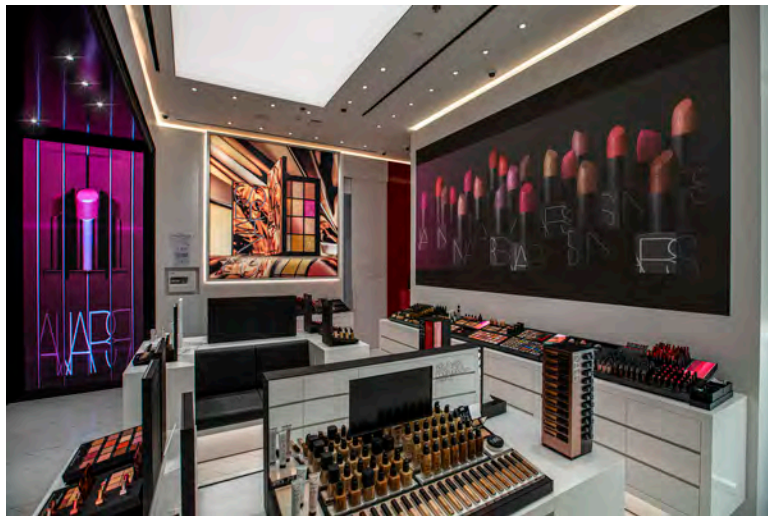

Nars, Dhahran Mall, Saudi Arabia
Client: 3D Chalhoub Group
Huda Lighting



Retail



Saks 5th Avenue, New York
Schwinghammer Lighting, New York



Retail



Bloomingdales, Kuwait
Nulty + Lighting Design, London



Retail



Frame, The Grove, Los Angeles
Schwinghammer Lighting, New York
Photography: Courtesy of Frame



Retail



Harrods Beauty, London
Isometrix Lighting + Design, London
Photography: Courtesy of Harrods



Retail



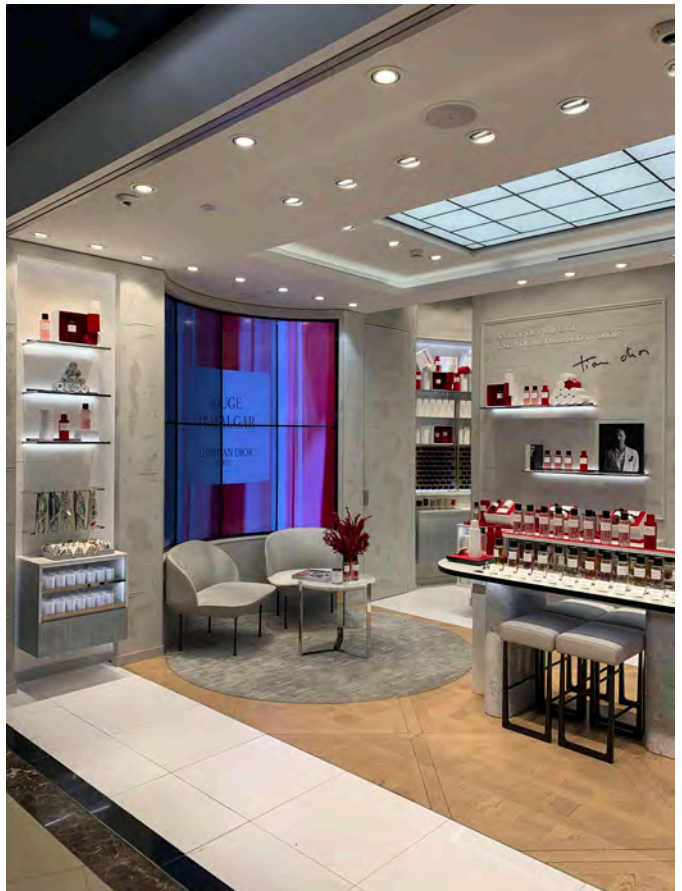

Dior Perfume, Jeddah Red Sea Mall
L'Observatoire International, New York

Retail



Sonos, New York
Dot Dash Lighting, New York



© Copyright 2021 Lucent Lighting Limited

All rights reserved.

No products or images within this publication may be reproduced or distributed without the prior written permission of Lucent Lighting Limited.

Catalogue Design: LL Design London

lucent®

Lucent Lighting Limited
1345 High Road
London
N20 9HR

Tel: +44 (0)20 8442 0880

www.lucent-lighting.com
info@lucent-lighting.com