

Pinhole4.25 Fixed

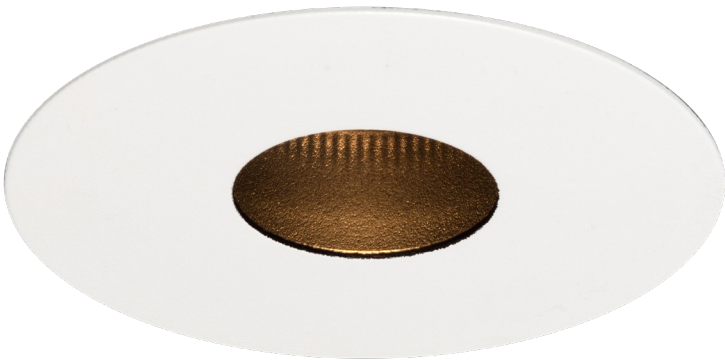

Pinhole4.25 provides high performance electronics and architectural aesthetics in 4.25” trim with a 1.73” aperture. Pinhole products include adjustable, fixed and washlight in a flanged or trimless installation kit. Tray, retrofit and housing installation methods (NIC, IC, AT, T24 and CCEA) Multiple configurations for equal spacing also available. Lucent modules available in a wide range of color temperatures, beam angles, intensities, and effects (Ambiance WarmDim and Dynamic Tuneable White). MR16 and GU10 LED lamp options available. TRIAC/Phase, 0-10v/1-10v, DMX and DALI/ Digital dimming.

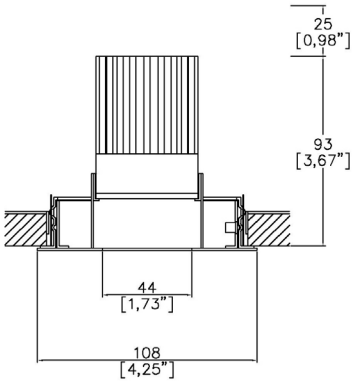

A30413-F-LED + 3000-PBZ
Cut-out 103mm (4.00”) Ø



Installation kit for overlap flange
3000-PBZ

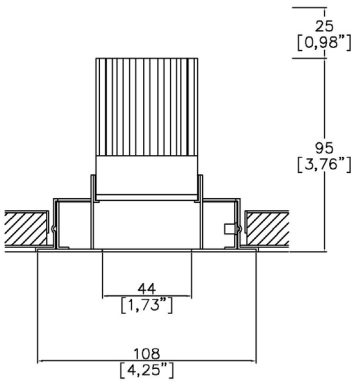

A30413-F-LED + 3000-PCZ
Cut-out 98mm (3.85”) Ø



Mud-in kit for seamless/trimless
3000-PCZ

LED Source	LED5IWD	LED5IWD
CCT	3000K	3000K
Drive Current	500mA	500mA
Power inc Driver	17.1W	17.1W
Beam Angle	28°	39°
Delivered Lumens	579	671
Delivered Intensisty cd	2035	1330
Efficacy lm/w	34	39
Forward Volt	29.1V	29.1V
CRI	≥95 CRI	≥95 CRI
Test results at full output		

Project Ref: _____ Location Ref: _____

Specify fixture part number (All boxes must be filled in to correctly order)

A30413-F-LED					LED51WD									
--------------	--	--	--	--	---------	--	--	--	--	--	--	--	--	--

Finish _____

WH White

BK Black

Location _____

XX Dry

DP Damp

WT Wet

Installation _____

PB 3000-PBZ Flange kit

PC 3000-PCZ Mud-in kit

Ceiling Thickness _____

SC Standard Ceiling (1/2"-5/8"-3/4")

C Custom

LED Type _____

LED51WD LED51WD (95CRI)

CCT _____

2720 2700K - 2000K

3020 3000K - 2000K

Beam Angles _____

28 28

39 39

Housing/Tray _____

LMT-13-NIC Mounting Tray Non-Insulated ceilings

LH-6.75-NIC Housing 6.75" Non-Insulated ceilings

LH-8.50-AT/IC Housing 8.50" Insulated/Air-tight ceilings and Chicago Plenum

Mounting Hardware _____

09 9" to 15.25" - Adjustable Bar Hanger Lengths

14 14" to 24" - Adjustable Bar Hanger Lengths

36 28" to 36" - Adjustable Bar Hanger Lengths

BB Butterfly Bracket

CB Caterpillar Bracket

Supply Voltage _____

120 120V

277 277V

Dimming Protocol _____

S Non-Dimmable

P TRIAC/Phase (120V ONLY) (25-10% Minimum Dimming)***

LP Lutron Forward Phase 2-Wire (1% Dimming) (120V ONLY)

ESS EcoSystem 5-Series (5% Dimming)

LHE EcoSystem Hi-Lume Fade to Black (1% Dimming)

LAE Lutron 3-Wire Hi-Lume (1% Dimming)

LHP Lutron Hi-Lume Premier EcoSystem (0.1% Dimming)

A 0-10V (15-5% Minimum Dimming)***

B Bluetooth**

Emergency

E 1.5h Emergency

ES 1.5h Self test

Louvre/Lens

XX Not required

LL45 Honeycomb

LLCC Warm Tone

LLUV UV

LLDF Solite/Diffusing

LLFR Frosted Lens

LLLS Linear Spread

LLHS Heavy Spread

*Refer to Technical Details for more information

Housing dimensions

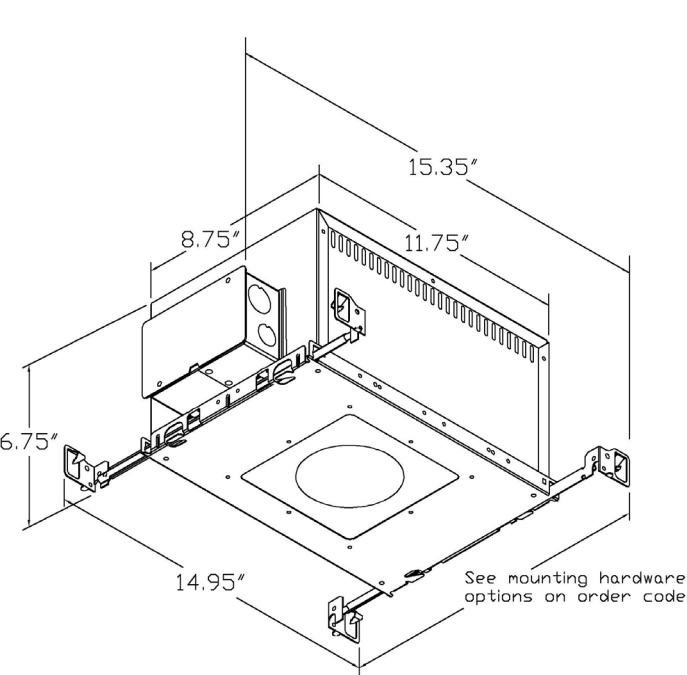

LH-6.75
Non-insulated ceilings

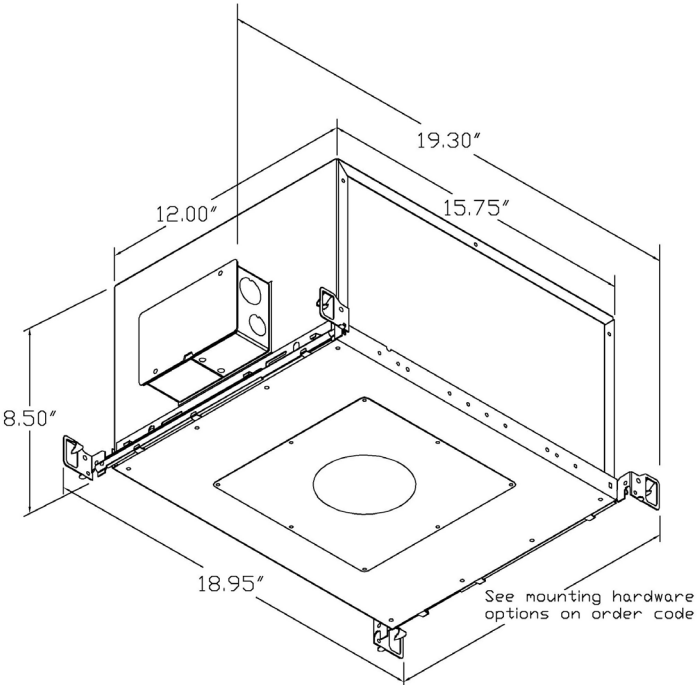

LH-8.50
Insulated/air-tight ceilings and
Chicago Plenum

Tray dimensions

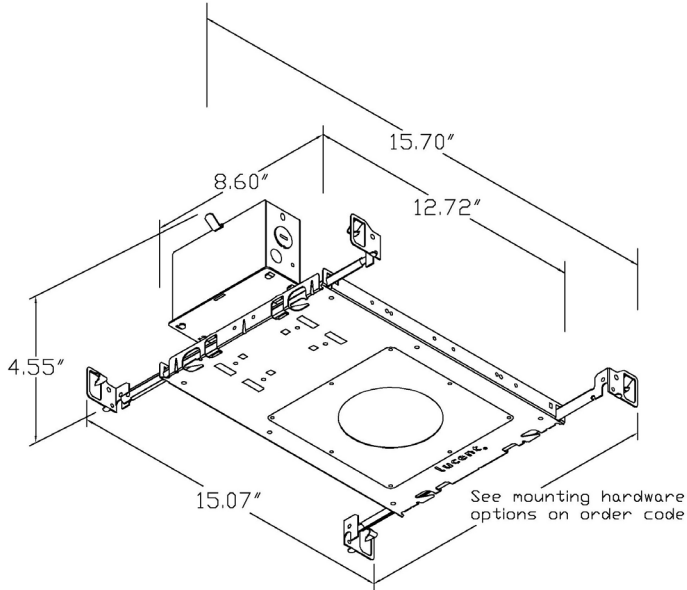

LMT-13
Non-insulated ceilings

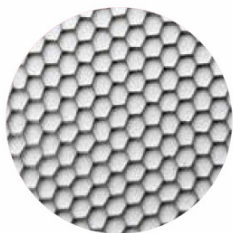

Honeycomb Louvre (LL45)

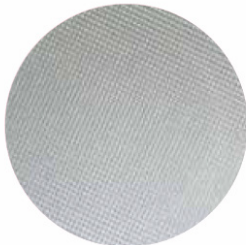

Solite/Diffusing Lens (LLDF)



Frosted Lens (LLFR)

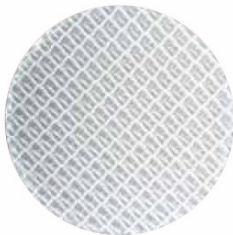

Heavy Spread Lens (LLHS)



Linear Spread Lens (LLLS)



Warm Tone (LLCC)

Technical Details

*Custom color requires a paint chip or RAL code and may increase price and lead-time

It is the responsibility of the specifier/integrator/installer to check and ensure compatibility of any control equipment used. Additional cabling may be required depending on the dimming protocol specified.

**Bluetooth (wireless) is a communication protocol. The exact dimming protocol must be confirmed to allow the selection of suitable drivers or Bluetooth devices.

***Non specific driver type, dimming performance depending on exact driver used. Contact Lucent Lighting for more information.

^ Depth indicated is the minimum recess depth for the luminaire with a remote mounted LED driver. Installing a driver through either the luminaire cut-out or installation kit may require additional recess depth, please refer to the relevant installation instructions prior to purchase.

First Fix Requirement. Luminaire comprised of fixture body with ceiling trim and installation kit, which is to be fitted into the ceiling once finished. Ensure correct alignment of the installation kit before final assembly (see luminaire installation instructions for details)

Location. Tested from underside of the ceiling.

Data correct at time of publishing. It is the policy of Lucent Lighting to continually review and improve its products and therefore reserve the right to change any details of product or withdraw specifications without prior notice.

This specification sheet supersedes all previous versions.

All intellectual property rights pertaining to the product described above and to this document are owned by or licensed to Lucent Lighting, Incorporated. Lucent Lighting reserves the right to take whatever action is necessary to protect its intellectual property, patents and trademarks

Please notify Lucent Lighting Inc. in accuracies. E&OE



Light efficiency:

34 Lumen/Watt

Light quality:

CRI: 95.5

Color temperature:

3000 K

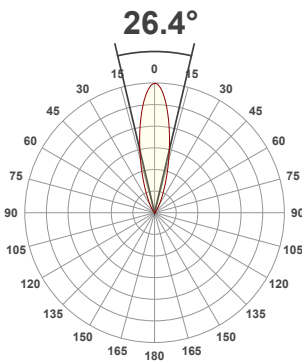

Product name:

Pinhole4.25 Fixed/Accent - LED51WD-3020-28-500mA

Item number:

A30413-F/A - LED51WD-3020-28-500mA

Delivered information for above fixture and LED combination.

Output: 579 Lumen Peak intensity: 2035 cd Power consumption: 17.1

CRI R values

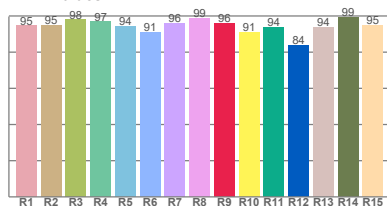

TM30 C Values

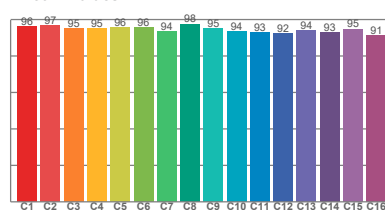

Color vector graphics

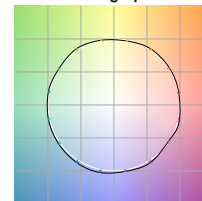

Color temperature	Color rendering index	Red component	Color fidelity	Color gamut	Color quality scale	Color coordinate cie 1931	Color coordinate cie 1931	Color coordinate	Color coordinate	Color deviation from black body
CCT	CRI	CRI R9	TM30 Rf	TM30 Rg	CQS	x	y	u	v	Δuv
3000 K	95.5	95.8	94.7	102.9	94.8	0.437	0.404	0.256	0.342	-0.0068

Beam details

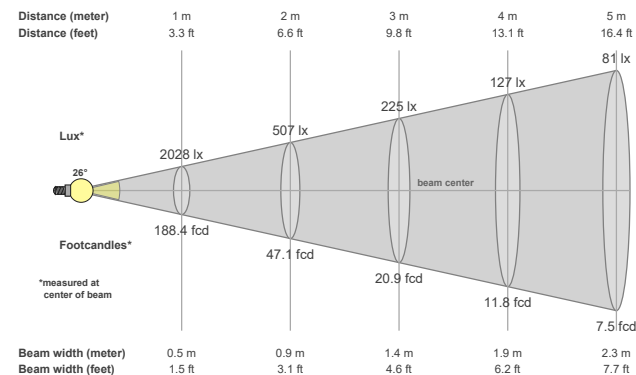

Beam angles

Beam angle 50%	Field angle 10%	Cutoff angle 2,5%
26.4°	54.1°	73.6°

Beam intensities

Peak intensity	Int. ratio in 120° cone	Int. ratio in 90° cone
2035 cd	99.7%	98.4%

Beam intensities from 1-20m

1m	2m	3m	4m	5m	6m	7m	8m	9m	10m	11m	12m	13m	14m	15m	16m	17m	18m	19m	20m
3.3ft	6.6ft	9.8ft	13.1ft	16.4ft	19.7ft	23ft	26.2ft	29.5ft	32.8ft	36.1ft	39.4ft	42.7ft	45.9ft	49.2ft	52.5ft	55.8ft	59.1ft	62.3ft	65.6ft
2028lx	507lx	225lx	127lx	81lx	56lx	41lx	32lx	25lx	20lx	17lx	14lx	12lx	10lx	9lx	8lx	7lx	6lx	6lx	5lx
188.4fcd	47.1fcd	20.9fcd	11.8fcd	7.5fcd	5.2fcd	3.8fcd	2.9fcd	2.3fcd	1.9fcd	1.6fcd	1.3fcd	1.1fcd	1fcd	0.8fcd	0.7fcd	0.7fcd	0.6fcd	0.5fcd	0.5fcd

The above information is for 3000K colour temperature, for specific module information please see LED spec located on our website

For information regarding other colour temperatures please use the following factors for lumen output and candelas:

2700K = 0.93

Light efficiency:

39 Lumen/Watt

Light quality:

CRI: 95.5

Color temperature:

3000 K

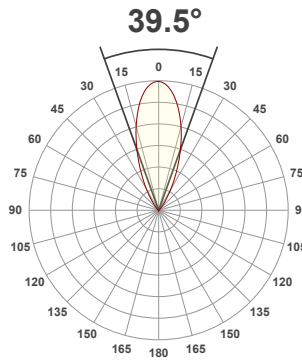

Product name:

Pinhole4.25 Fixed/Accent - LED51WD-3020-39-500mA

Item number:

A30413-F/A - LED51WD-3020-39-500mA

Delivered information for above fixture and LED combination.

Output: 671 Lumen Peak intensity: 1330 cd Power consumption: 17.1

CRI R values

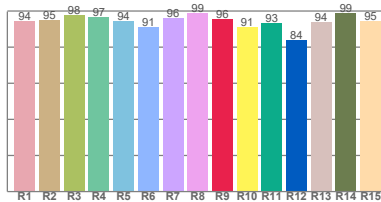

TM30 C Values

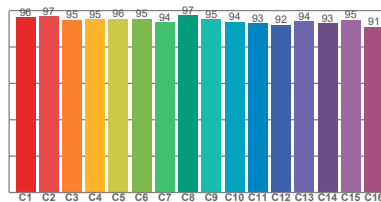

Color vector graphics

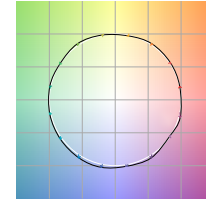

Color temperature	Color rendering index	Red component	Color fidelity	Color gamut	Color quality scale	Color coordinate cie 1931	Color coordinate cie 1931	Color coordinate	Color coordinate	Color deviation from black body
CCT	CRI	CRI R9	TM30 Rf	TM30 Rg	CQS	x	y	u	v	Δuv
3000 K	95.5	95.7	94.7	103.1	94.7	0.437	0.404	0.257	0.342	-0.0070

Beam details

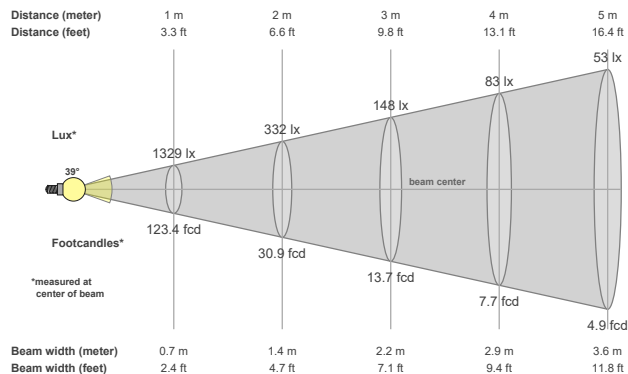

Beam angels

Beam angle 50%	Field angle 10%	Cutoff angle 2,5%
39.5°	69.4°	88.3°

Beam intensities

Peak intensity	Int. ratio in 120° cone	Int. ratio in 90° cone
1330 cd	99.8%	97.8%

Beam intensities from 1-20m

1m	2m	3m	4m	5m	6m	7m	8m	9m	10m	11m	12m	13m	14m	15m	16m	17m	18m	19m	20m
3.3ft	6.6ft	9.8ft	13.1ft	16.4ft	19.7ft	23ft	26.2ft	29.5ft	32.8ft	36.1ft	39.4ft	42.7ft	45.9ft	49.2ft	52.5ft	55.8ft	59.1ft	62.3ft	65.6ft
1329lx	332lx	148lx	83lx	53lx	37lx	27lx	21lx	16lx	13lx	11lx	9lx	8lx	7lx	6lx	5lx	5lx	4lx	4lx	3lx
123.4fcd	30.9fcd	13.7fcd	7.7fcd	4.9fcd	3.4fcd	2.5fcd	1.9fcd	1.5fcd	1.2fcd	1fcd	0.9fcd	0.7fcd	0.6fcd	0.5fcd	0.5fcd	0.4fcd	0.4fcd	0.3fcd	0.3fcd

The above information is for 3000K colour temperature, for specific module information please see LED spec located on our website

For information regarding other colour temperatures please use the following factors for lumen output and candelas:

2700K = 0.93