

Surface95 Integral Driver Installation Instructions

Surface95
200950/200953

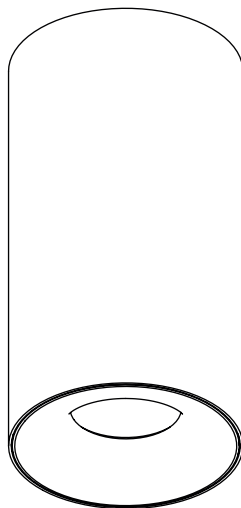

Technical Parameters

Luminaire Type	Drive Current	Forward Voltage	LED Power
200950-FL-LED-I	350mA max.	36VDC	12.6W
200953-FL-LED-I	350mA max.	36VDC	12.6W
200950-PE-LED-I	350mA max.	36VDC	12.6W
200953-PE-LED-I	350mA max.	36VDC	12.6W

Note: The recommended cable distance between the remote driver and the light source is 2 meters for most driver types. If distances greater than this are required please contact Lucent Lighting for alternative solutions.



IMPORTANT INFORMATION

- Please read the following instructions carefully.
- Follow all national and local wiring and safety regulations.
- Connecting or disconnecting these luminaires while powered will damage the LED.
- Do not touch the LED or PCB.
- These products are designed for interior use only and only for downlighting applications.
- Suitable for operation in ambient temperatures between -25°C and +40°C in free flowing air.
- These products should only be installed by a qualified electrician.
- The light source contained in these luminaires shall only be replaced by the manufacturer, their service agent or a similarly qualified person.
- These products require an LED driver - **DO NOT CONNECT DIRECTLY TO MAINS POWER!**
- The fixing method is designed to hold the weight of the luminaire only.
- The top and bottom of the luminaire provides essential heat dissipation for the light source and must not be covered.
- The manufacturer bears no liability for damage caused by inappropriate use or application.
- Retain these instructions for future reference.

Product Information

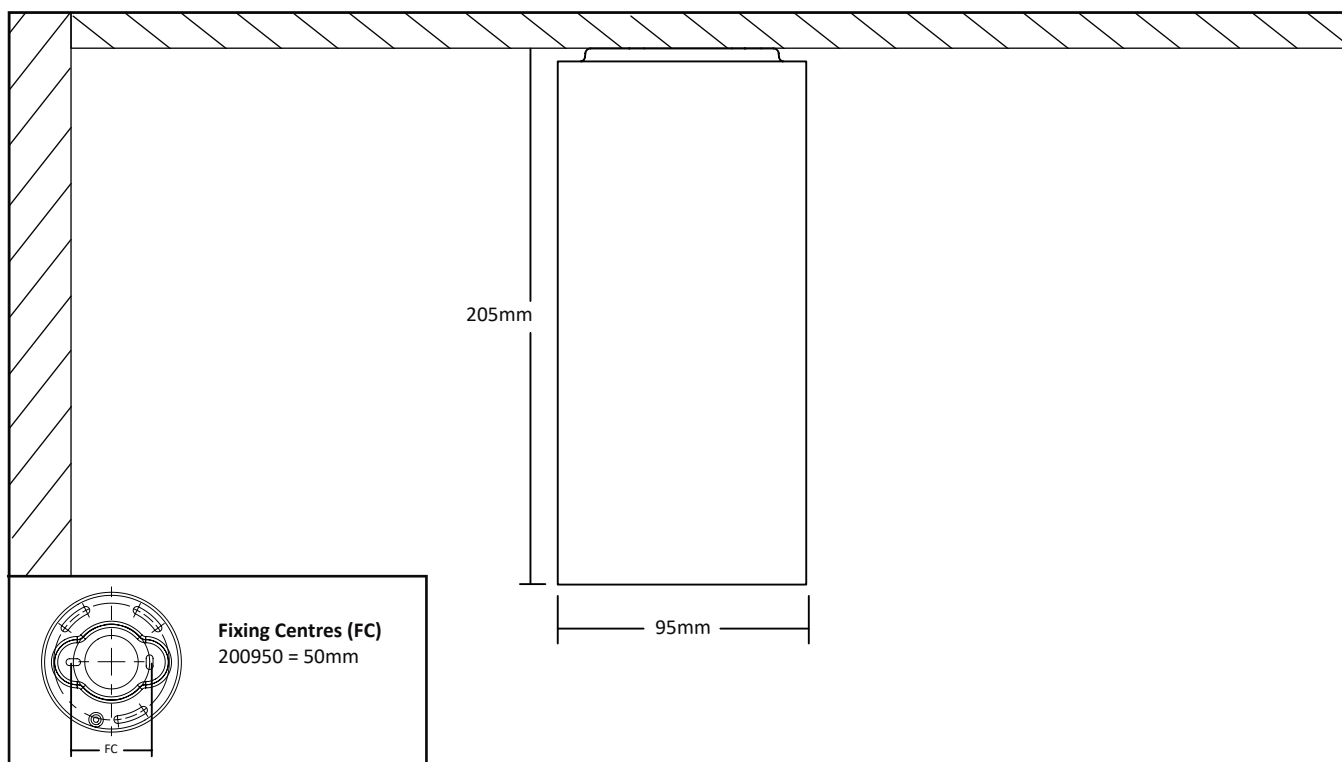

Installation Steps

Integral Driver



TURN POWER OFF BEFORE INSPECTION, INSTALLATION OR REMOVAL AND PROPERLY GROUND ELECTRICAL ENCLOSURE!

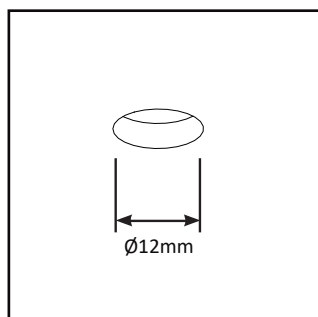

1. Create Cable Hole Ø12mm in ceiling.

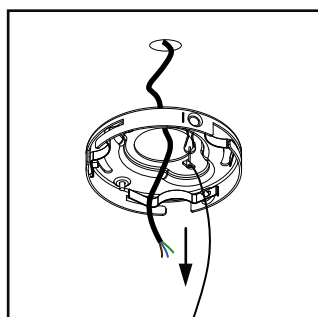

2. Drop-down mains power connection from ceiling cut out

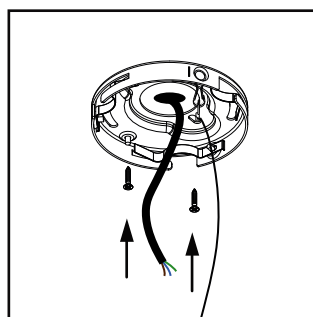

3. Attach mounting ring to ceiling. See Product Information for Fixing Centre dimensions.

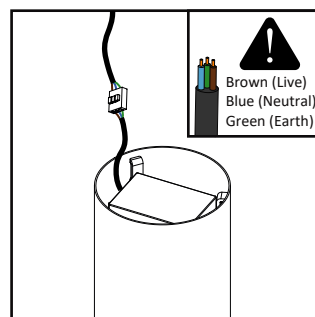

4. Connect mains power to driver located in back of fitting. (Connection block to be supplied by installer).

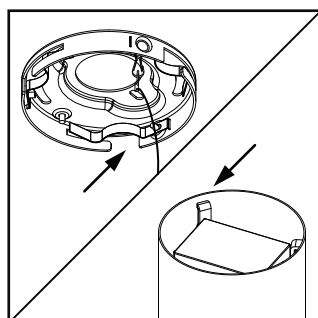

5. Note the position of the retaining clips on the ceiling kit and their attachment points on the body of the fitting.

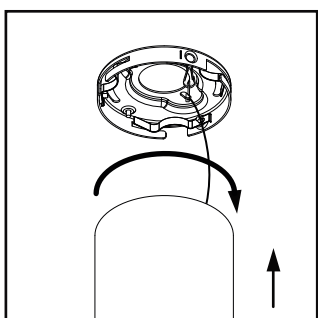

6. Attach the fitting to the mounting ring. Rotate the fitting to lock in place.

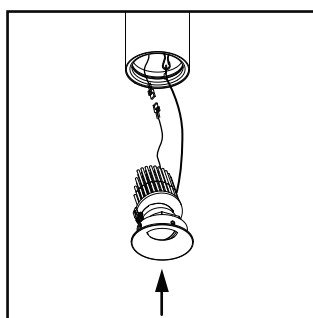

7. Attach safety wire then connect light-source and insert into can.

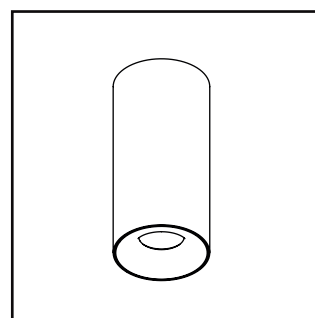

8. Finished installation.

Accessories Instructions



REATTACH SAFETY WIRE TO MODULE AFTER CHANGING ACCESSORIES

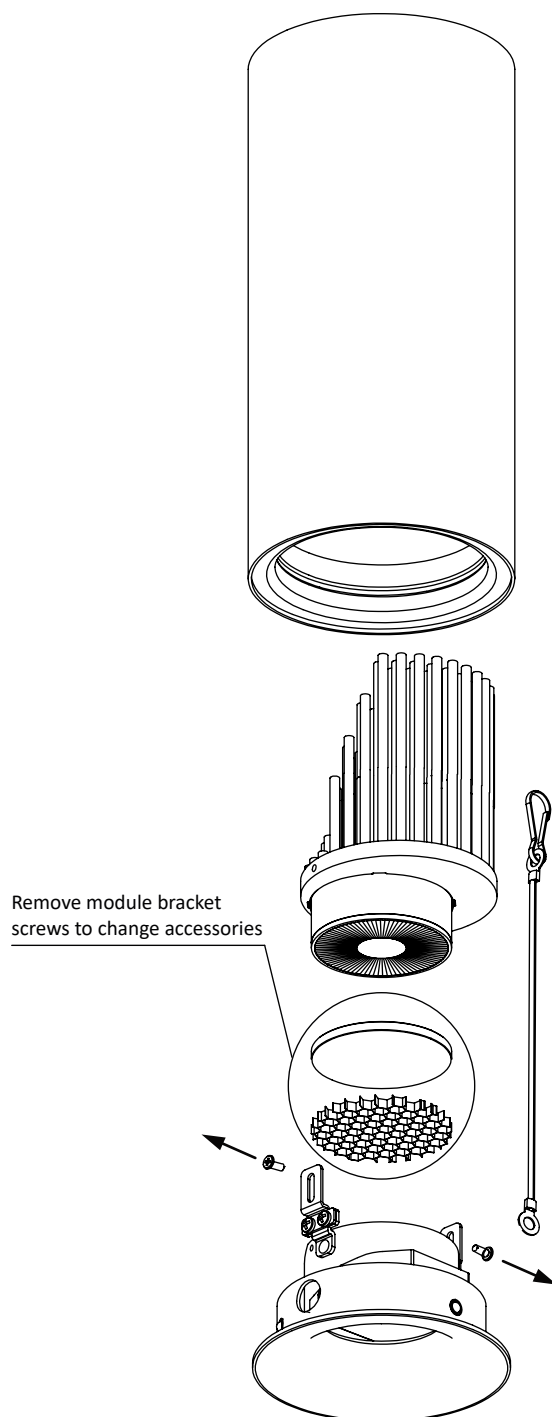

DISCLAIMER

It is the policy of Lucent Lighting to continually review and improve its products and therefore reserve the right to change any details of product or withdraw specifications without prior notice. Luminaires designed to comply with EN60598 and all other standards. This specification sheet supersedes all previous versions. All intellectual property rights pertaining to the product described above and to this document are owned by or licensed to Lucent Lighting Ltd. We reserve the right to take whatever action is necessary to protect those intellectual property rights. Please notify Lucent Lighting Ltd of any inaccuracies immediately. E&OE